



Portland Avenue Revitalization Project (Lux Street to Norton Street)

Public Information Meeting
January 9, 2014, 6:30 pm



the LA group
Landscape Architecture
and Engineering, P.C.

Portland Avenue Revitalization Project – Streetscape and Beautification

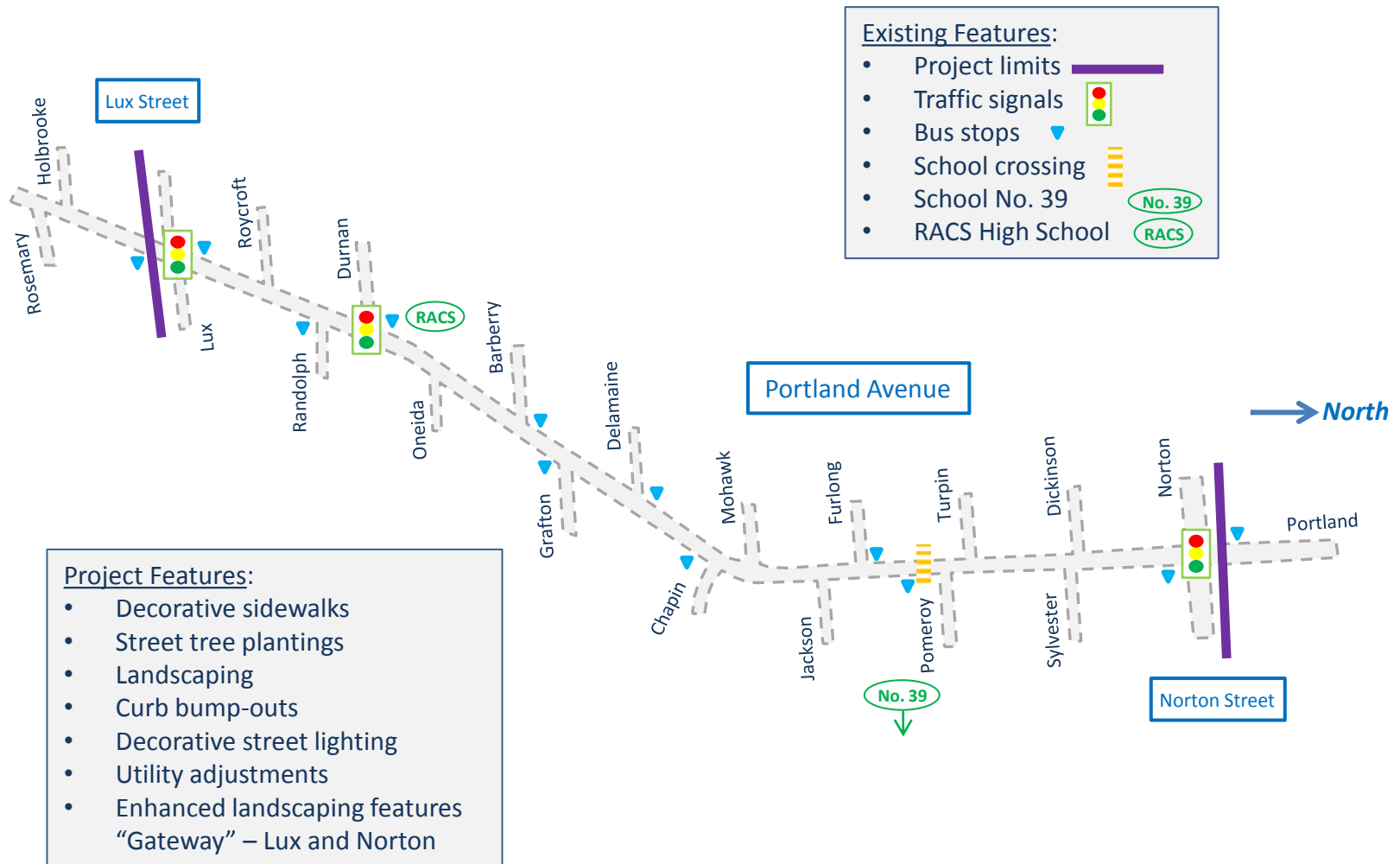

Portland Avenue Revitalization Project – Streetscape and Beautification

“Complete Streets”

Streets that enable safe access for all users, where pedestrians, bicyclists, transit users, persons with disabilities, and motorists, of all ages and abilities, are able to safely cross and move along.

City of Rochester’s Policy on “Complete Streets”, adopted November 2011

City Municipal Code, Section 104-29: Complete Streets Policy

“...The incorporation of bicycle, pedestrian, and transit facilities shall be mandated in all street construction, reconstruction, rehabilitation, and pavement maintenance projects undertaken by or on behalf of the City”

Goals for Portland Avenue beautification project:

- Bicycle – add striped bike lanes
- Pedestrian – add high visibility crosswalks
- Transit – add bus shelter at high volume bus stop

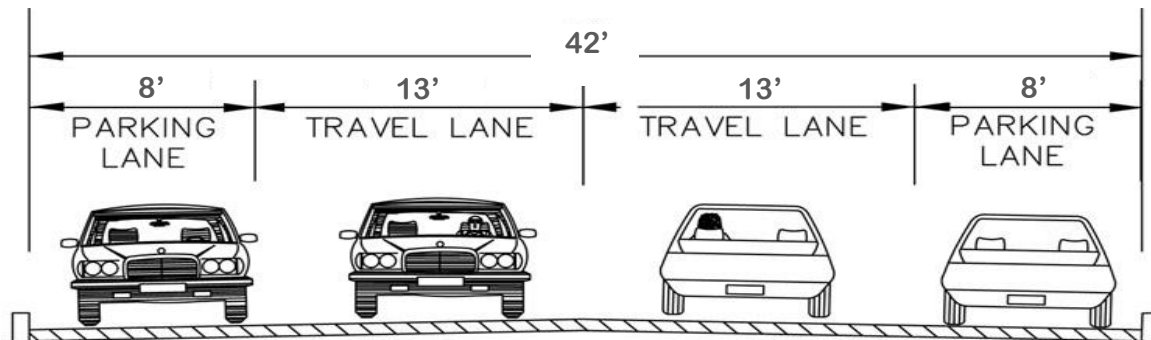

**Existing Typical Section –
View Driving Northbound on Portland Avenue**

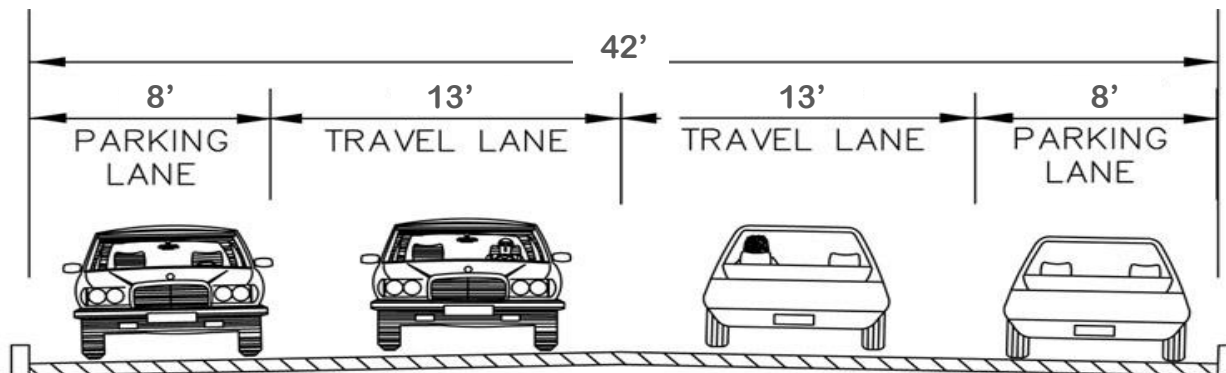

**Existing Typical Section –
View Driving Northbound on Portland Avenue**

BEFORE

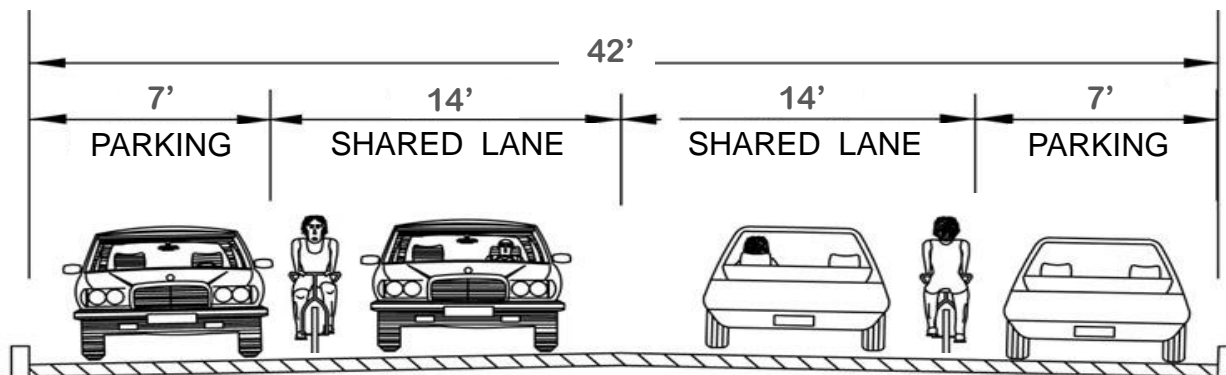

**Proposed Typical Section – w/Shared Travel Lanes
View Driving Northbound on Portland Avenue**

AFTER

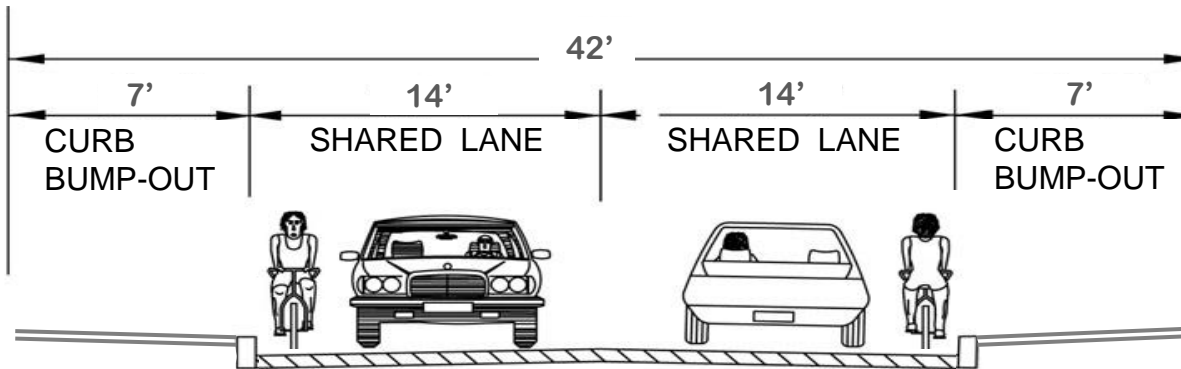

AFTER

**Proposed Typical Section –
With Shared Travel Lanes and Intersection Curb Bump-outs
View Driving Northbound on Portland Avenue**



"Sharrow" Symbol

Proposed Typical Section – w/Shared Lanes



**Existing Curve near Chapin Street –
Driving Northbound on Portland Avenue**



Lake Avenue
south of Driving Park

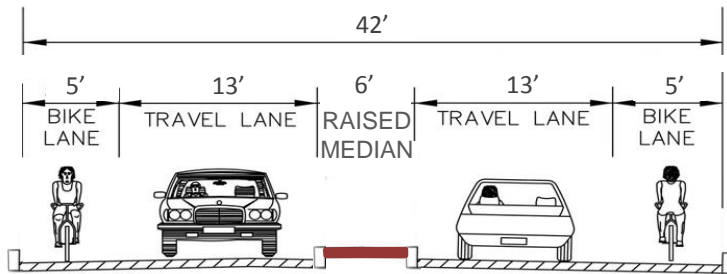

Proposed Raised Median

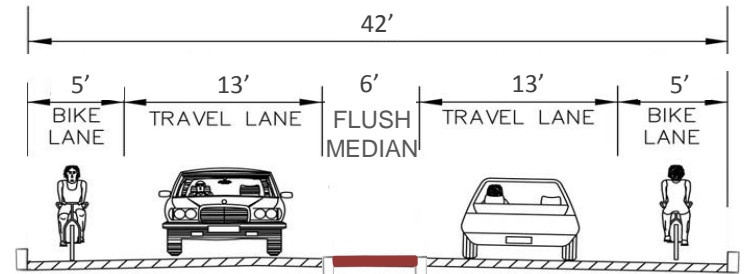

Proposed Flush Median

Proposed Median Treatment – Curve near Chapin Street Driving Northbound on Portland Avenue

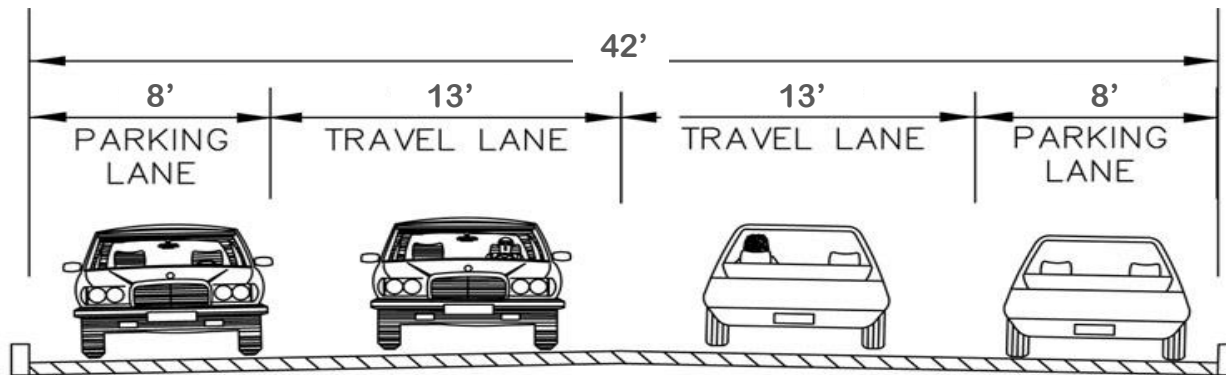

**Existing Typical Section –
View Driving Northbound on Portland Avenue**

BEFORE

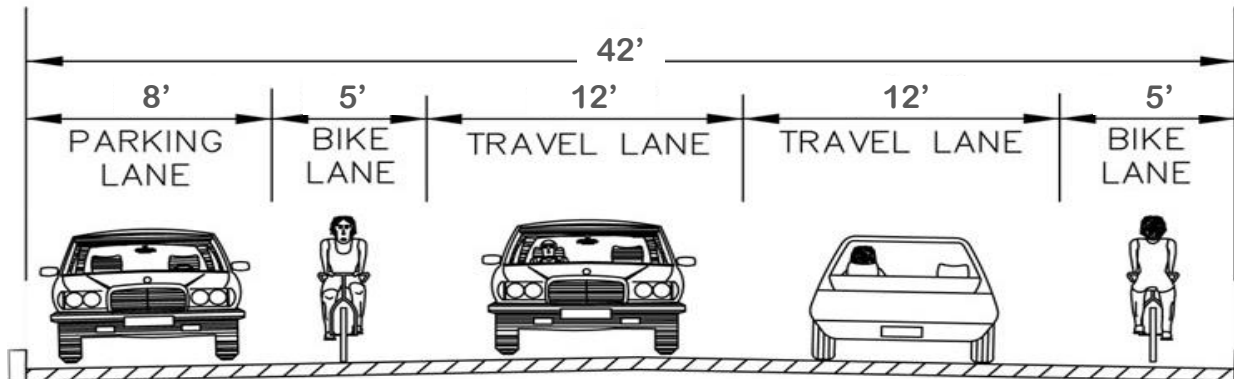

**Proposed Typical Section – w/Bike Lanes
View Driving Northbound on Portland Avenue**

AFTER

East Side



West Side

Proposed Typical Section – w/Bike Lanes
Driving Southbound on Portland Avenue

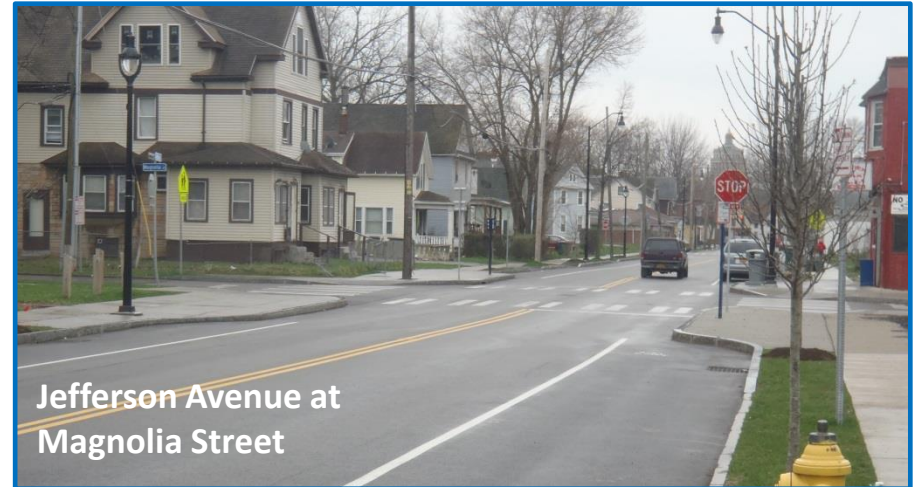
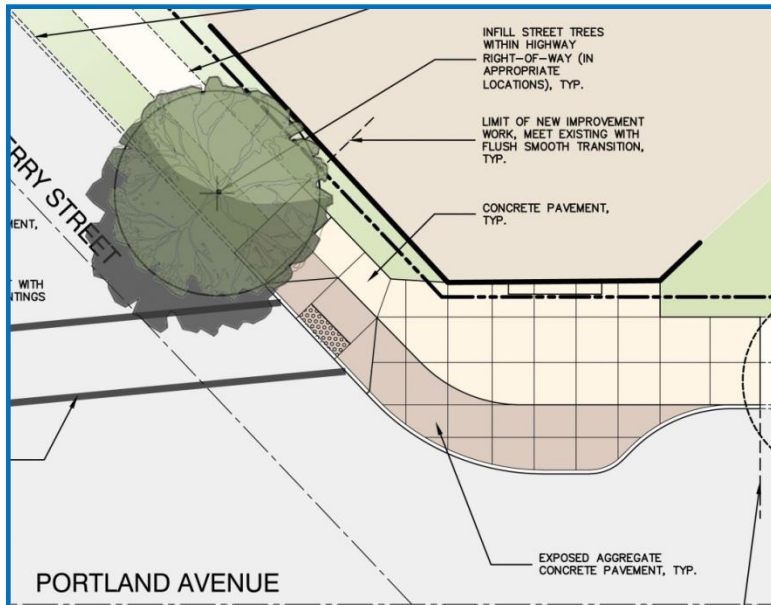

Potential Curb Bump-outs:
(in west side parking lane)

- Durnan Street
- Barberry Terrace
- Delamaine Drive
- Furlong Street
- Turpin Street
- Dickinson Street

Potential Curb Bump-outs:
(in east side parking lane)

- Oneida Street
- Grafton Street

Proposed Curb Bump-outs

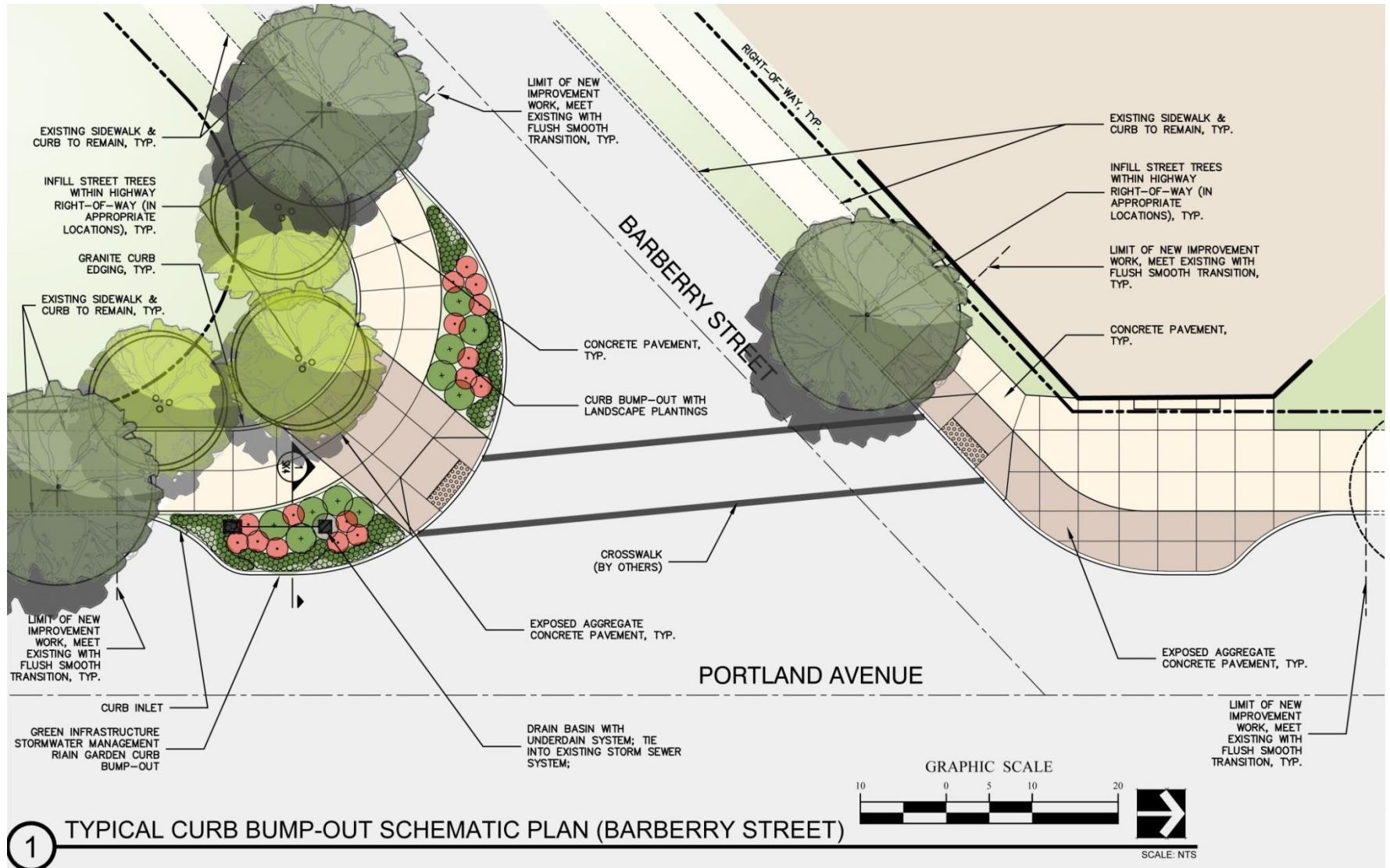

Proposed Curb Bump-outs

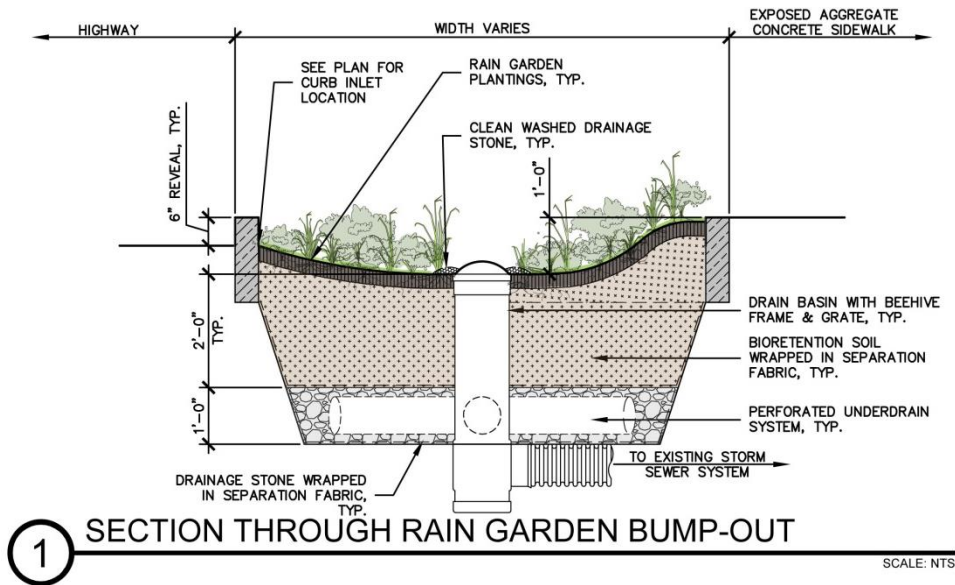

Proposed Curb Bump-outs – with Rain Garden



Existing Crosswalk – crossing Portland at Durnan Street



Proposed High-visibility Crosswalks:

- Lux Street
- Durnan Street
- School Crossing at Pomeroy Street
- Norton Street



StreetPrint XD:
Jefferson Avenue at
Columbia Street



Duratherm material:
Plymouth Avenue at
Exchange Street

Proposed High-visibility Crosswalk Treatment

Existing Concrete Sidewalk
Portland at Barberry

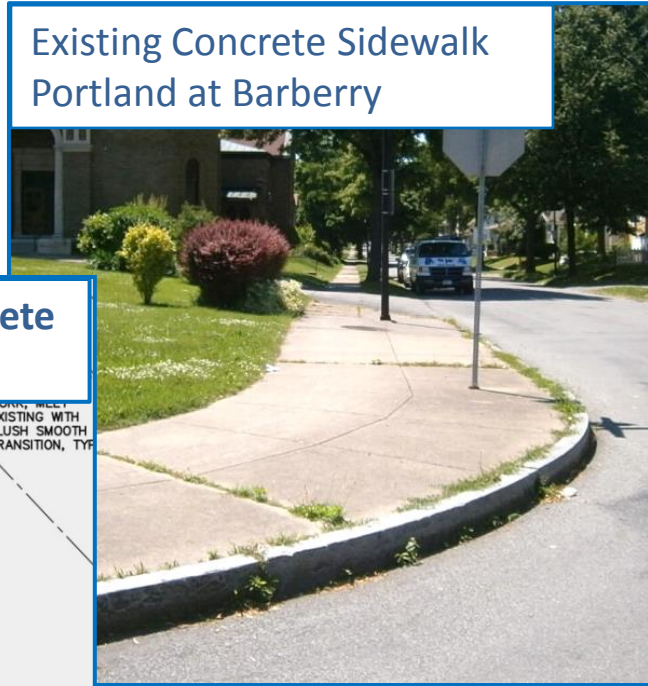

Proposed Exposed Aggregate Concrete
Sidewalk: Portland at Barberry

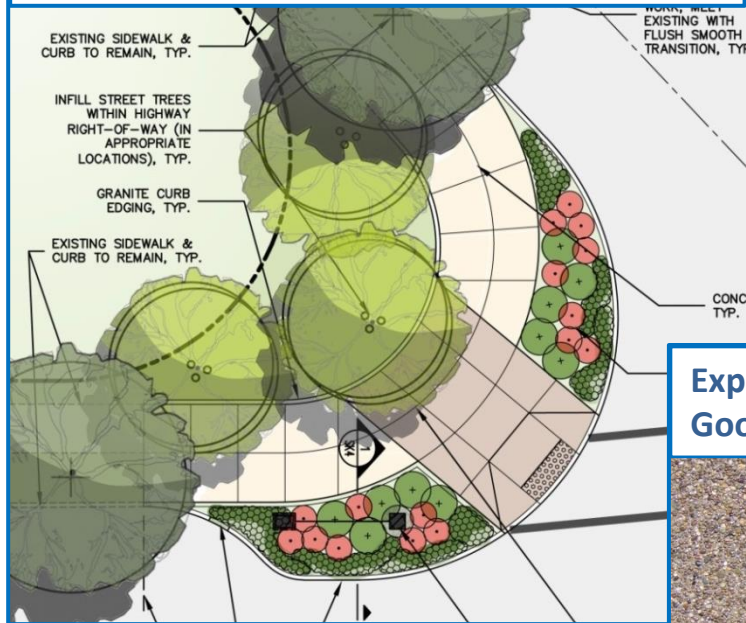

Exposed Aggregate Concrete
Goodman Street at University



Proposed Sidewalk Treatment – Exposed Aggregate Concrete

Existing concrete sidewalk at
Lux Street



Proposed brick paver herringbone pattern,
Portland Avenue at Lux Street

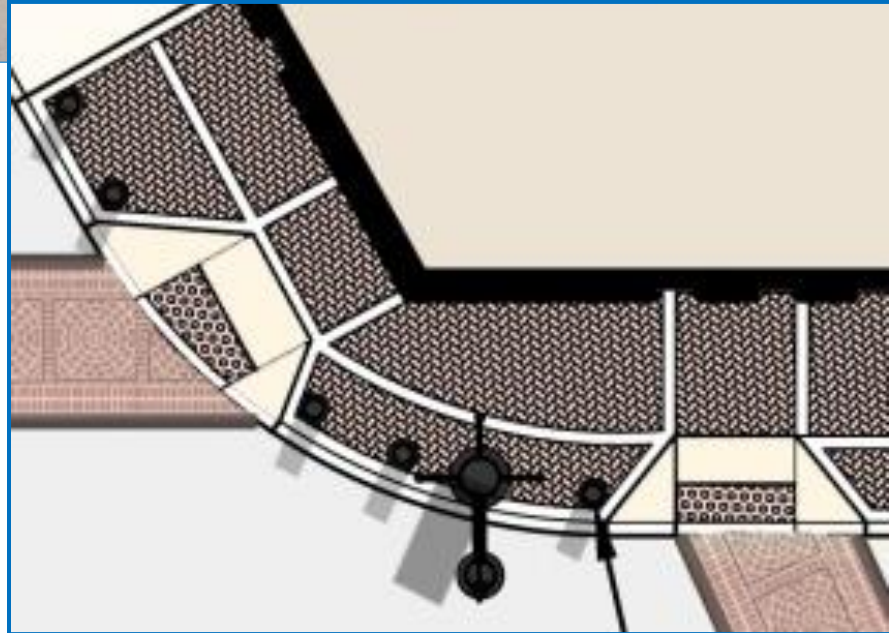

Brick Pavers on Plymouth
Avenue near W. Main Street



Proposed Sidewalk Treatment – Brick Paver Pattern

Proposed Bus Shelter
at Durnan Street

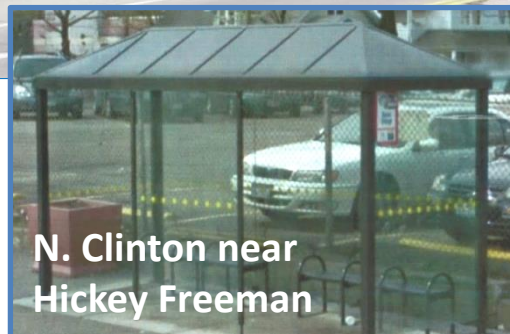

N. Clinton near
Hickey Freeman



Jefferson Avenue
at Columbia

Proposed Bus Shelter at Durnan Street

Proposed Gateway – Portland Avenue and Lux Street

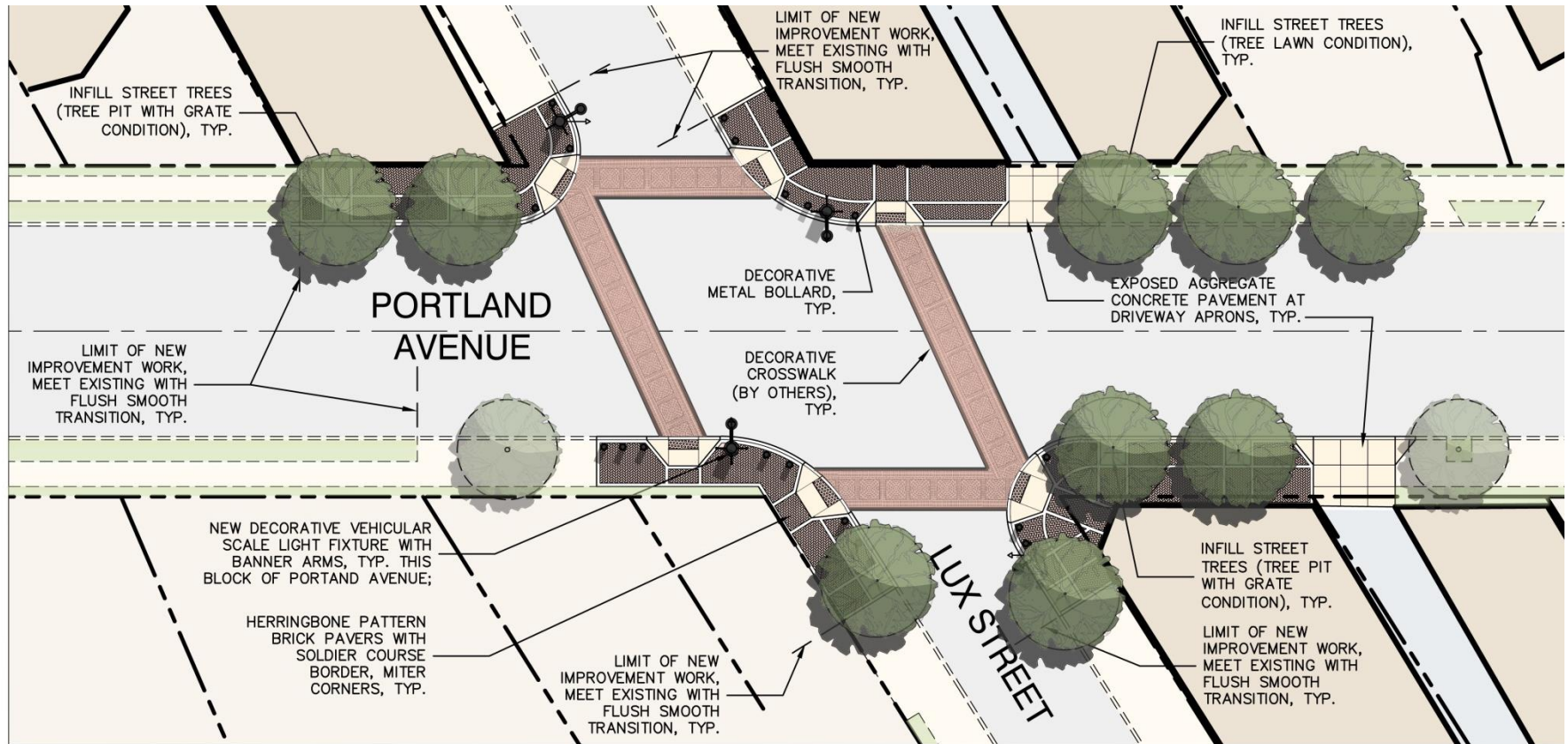

GRAPHIC SCALE



1 inch = 20 feet



SCALE: NTS

1

LUX STREET GATEWAY SCHEMATIC PLAN

Proposed Gateway – Portland Avenue and Lux Street



View Looking North on Portland Avenue at Lux Street

Proposed Gateway – Portland Avenue and Lux Street



View Looking Northwest on Portland Avenue at Lux Street

Proposed Gateway – Portland Avenue and Norton Street

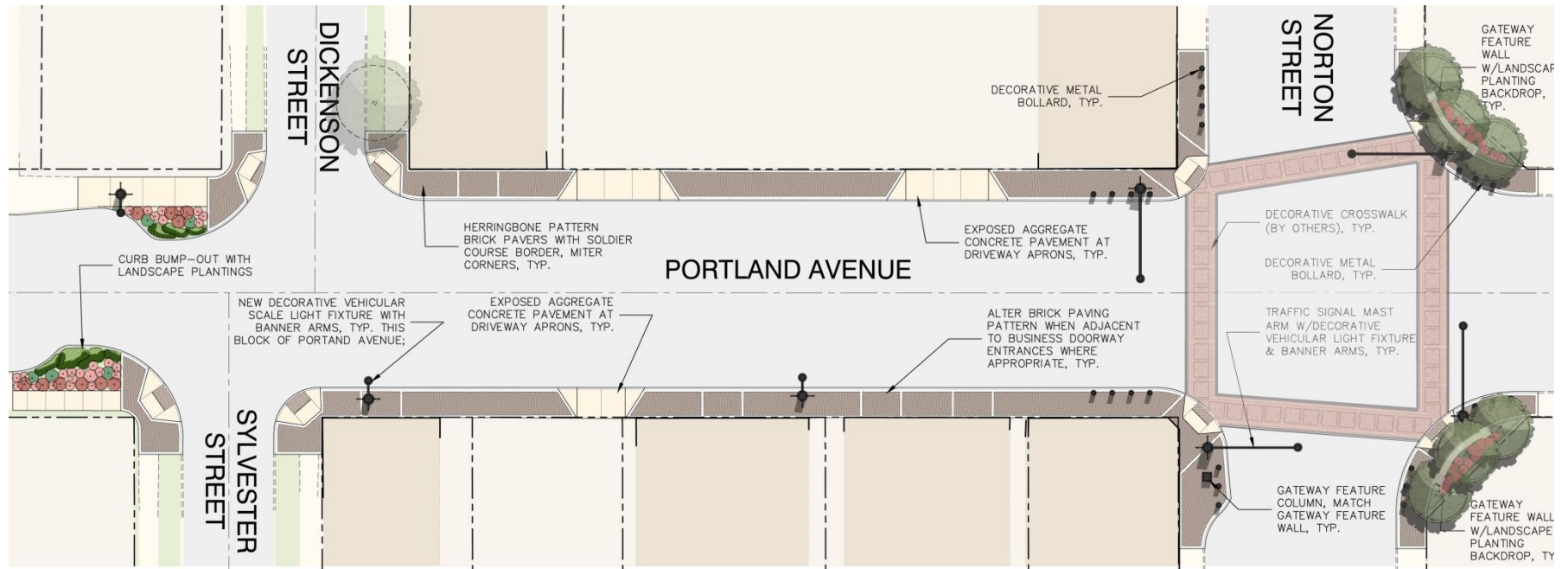

1 NORTON STREET GATEWAY SCHEMATIC PLAN



SCALE: NTS

Proposed Gateway – Portland Avenue and Norton Street



View Looking East on Norton Street at Portland Avenue

Proposed Gateway – Portland Avenue and Norton Street



View Looking Southeast on Portland Avenue at Norton Street

Proposed Gateway – Portland Avenue and Norton Street



View Looking East on Norton Street at Portland Avenue

Atlantic Avenue near Culver Road

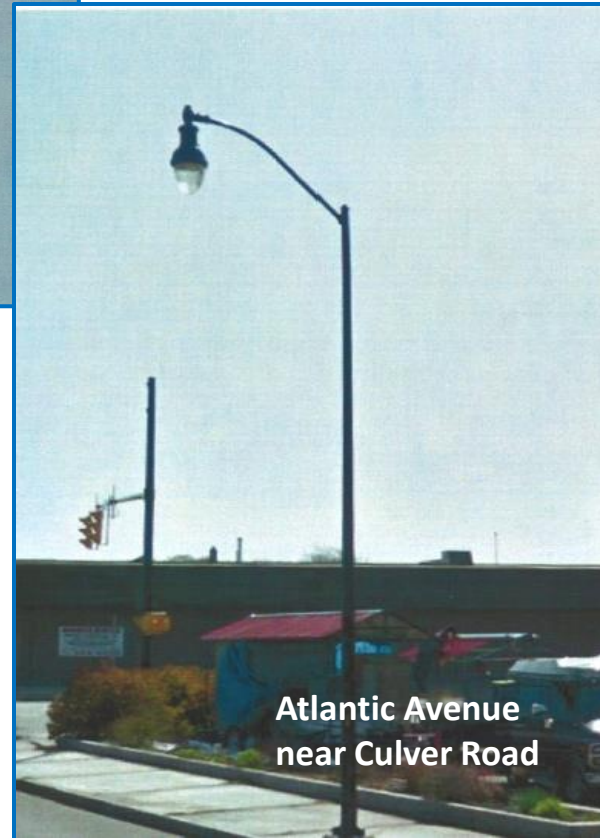

Atlantic Avenue
near Culver Road

Proposed Decorative Street Lighting



Sampling from Jefferson Avenue

Decorative Banners on Street Lighting Poles

Proposed Decorative Street Lighting

Existing light levels:

Average = 1.19 foot-candles

Maximum = 3.48 foot-candles

Minimum = 0.31 foot-candles

Average/Minimum Ratio = 3.8:1



30' tall, 250W HPS

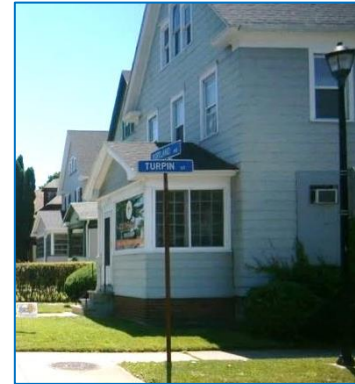

15' tall, 70W HPS

Proposed light levels:

Average = 1.5 to 1.7 foot-candles

Minimum = 0.80 foot-candles

Average/Minimum Ratio = 2.4:1

(improved uniform lighting levels)



New 30' tall, 250W HPS



Existing 15' tall poles
to remain

Portland Avenue Revitalization Project – Project schedule and funding

Portland Avenue Revitalization (Lux Street to Norton Street): Streetscape and Beautification Project

Project Schedule:

- Design complete early April 2014
- Construction start early summer 2014
- Construction complete winter 2014

Funding: 100% City Funding

Future 2015 Preventive Maintenance Project: Portland Avenue from Draper Street to the City Limit Line

Project includes:

- street pavement milling and resurfacing (including Lux to Norton Street)
- high visibility cross-walks (designed with 2014 Beautification project)

Project Schedule:

- design in 2014
- construction in 2015

Funding: 80% Federal Aid

Portland Avenue Revitalization Project – Streetscape and Beautification



Questions?

Project Contact:
Lisa Reyes, City Street Design
ReyesL@cityofrochester.gov
585-428-6354