



Portland Avenue Revitalization Project (Lux Street to Norton Street)

Public Information Meeting
May 21, 2014, 7:00 pm



KCI ENGINEERING OF NY
ENGINEERS | PLANNERS | SCIENTISTS | CONSTRUCTION MANAGERS



the LA group
Landscape Architecture
and Engineering, P.C.

Portland Avenue Revitalization Project – Streetscape and Beautification

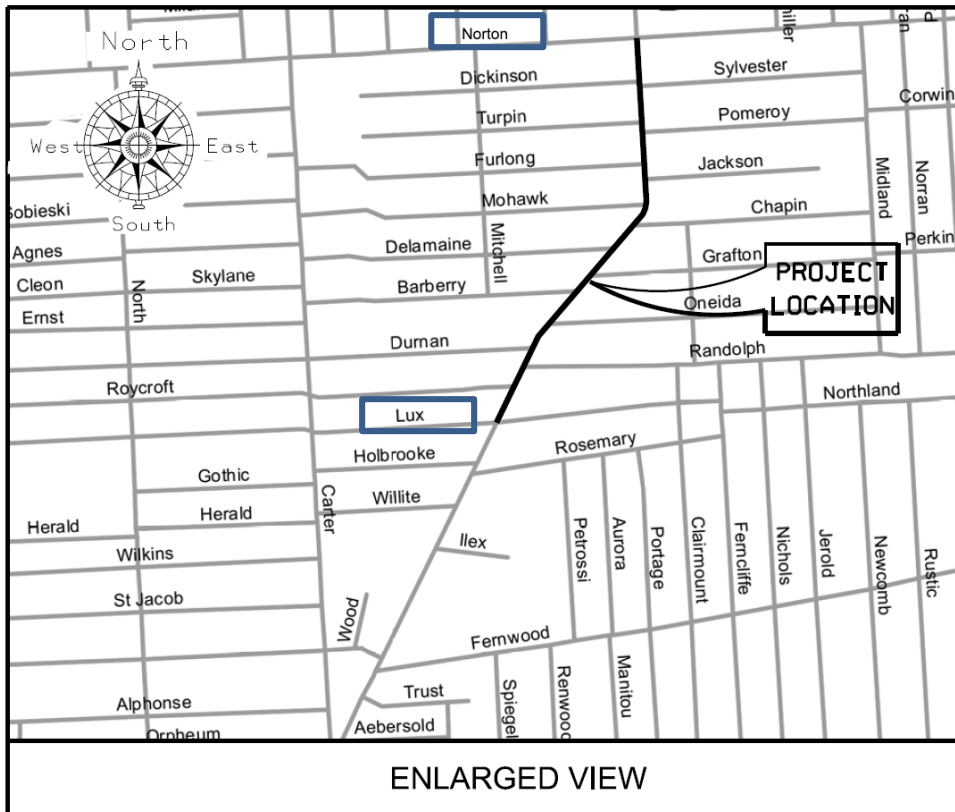

Project Features:

- “Gateway” at Lux and Norton
- Decorative sidewalks, bollards, banners
- Street tree plantings
- Landscaping
- Curb bump-outs
- Decorative street lighting
- Water service replacements
- Storm sewer adjustments

Portland Avenue Revitalization Project – Streetscape and Beautification

“Complete Streets”

Streets that enable safe access for all users, where pedestrians, bicyclists, transit users, persons with disabilities, and motorists, of all ages and abilities, are able to safely cross and move along.

City of Rochester’s Policy on “Complete Streets”, adopted November 2011

City Municipal Code, Section 104-29: Complete Streets Policy

“...The incorporation of bicycle, pedestrian, and transit facilities shall be mandated in all street construction, reconstruction, rehabilitation, and pavement maintenance projects undertaken by or on behalf of the City”

Goals for Portland Avenue beautification project:

- Bicycle – add striped bike lanes
- Pedestrian – add high visibility crosswalks
- Transit – add bus shelter at high volume bus stop

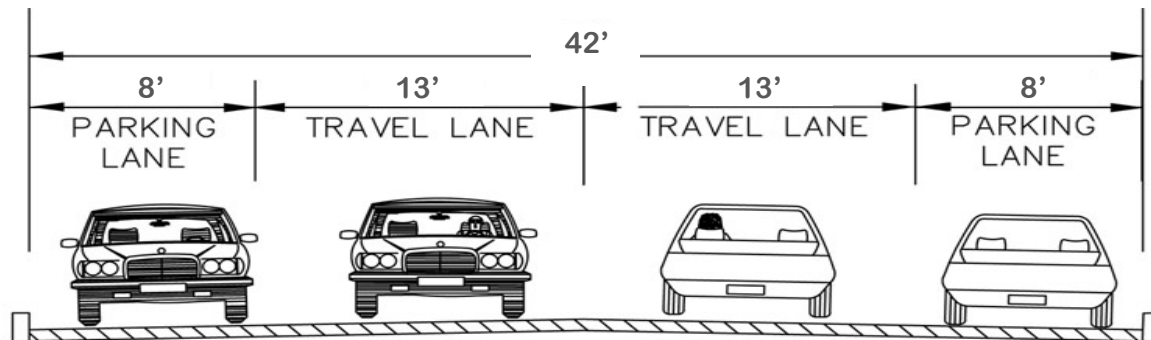

**Existing Typical Section –
View Driving Northbound on Portland Avenue**

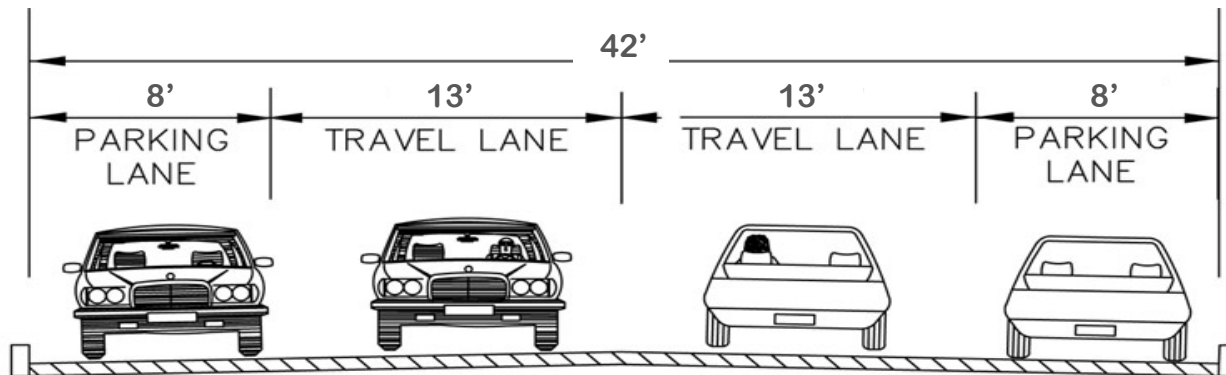

**Existing Typical Section –
View Driving Northbound on Portland Avenue**

BEFORE

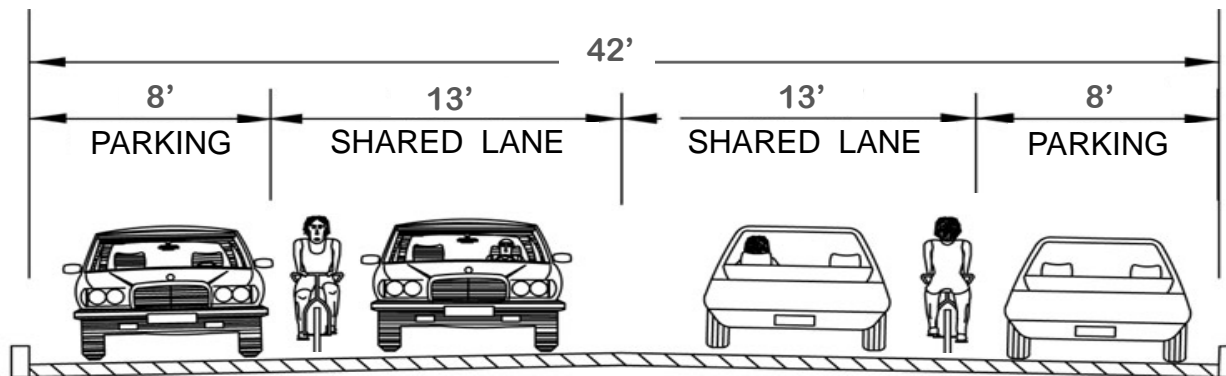

**Proposed Typical Section – w/Shared Travel Lanes
View Driving Northbound on Portland Avenue**

AFTER



“Sharrow” Symbol

Proposed Typical Section – w/Shared Lanes

Portland Avenue Revitalization Project – Proposed Design

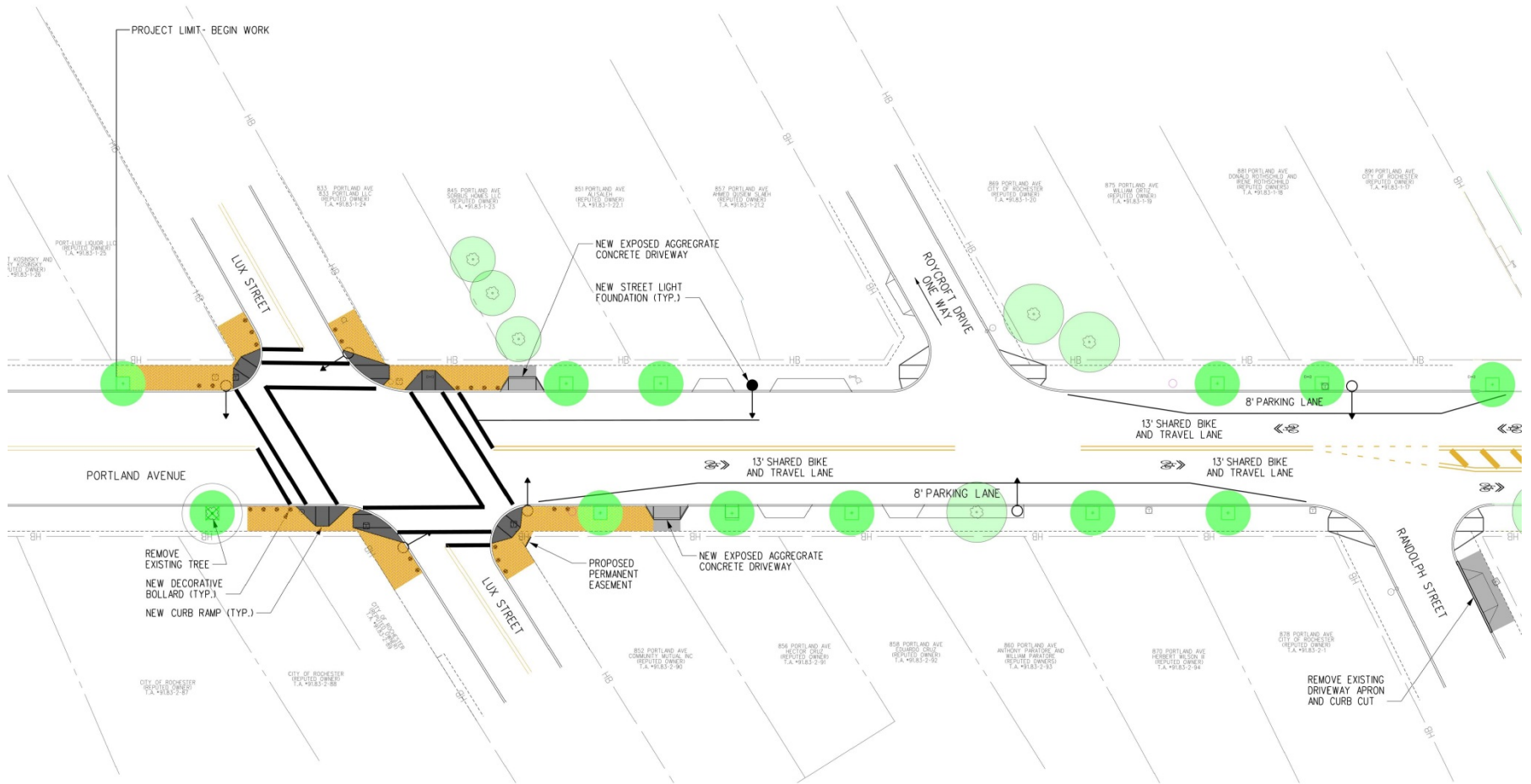

Proposed Gateway – Portland Avenue and Lux Street



View Looking North on Portland Avenue at Lux Street

Proposed Gateway – Portland Avenue and Lux Street



View Looking Northwest on Portland Avenue at Lux Street



East Avenue at Broadway



Rochester Public Market



Goodman Street at University

Proposed Sidewalk Treatment – Exposed Aggregate Concrete

Portland Avenue Revitalization Project – Proposed Design

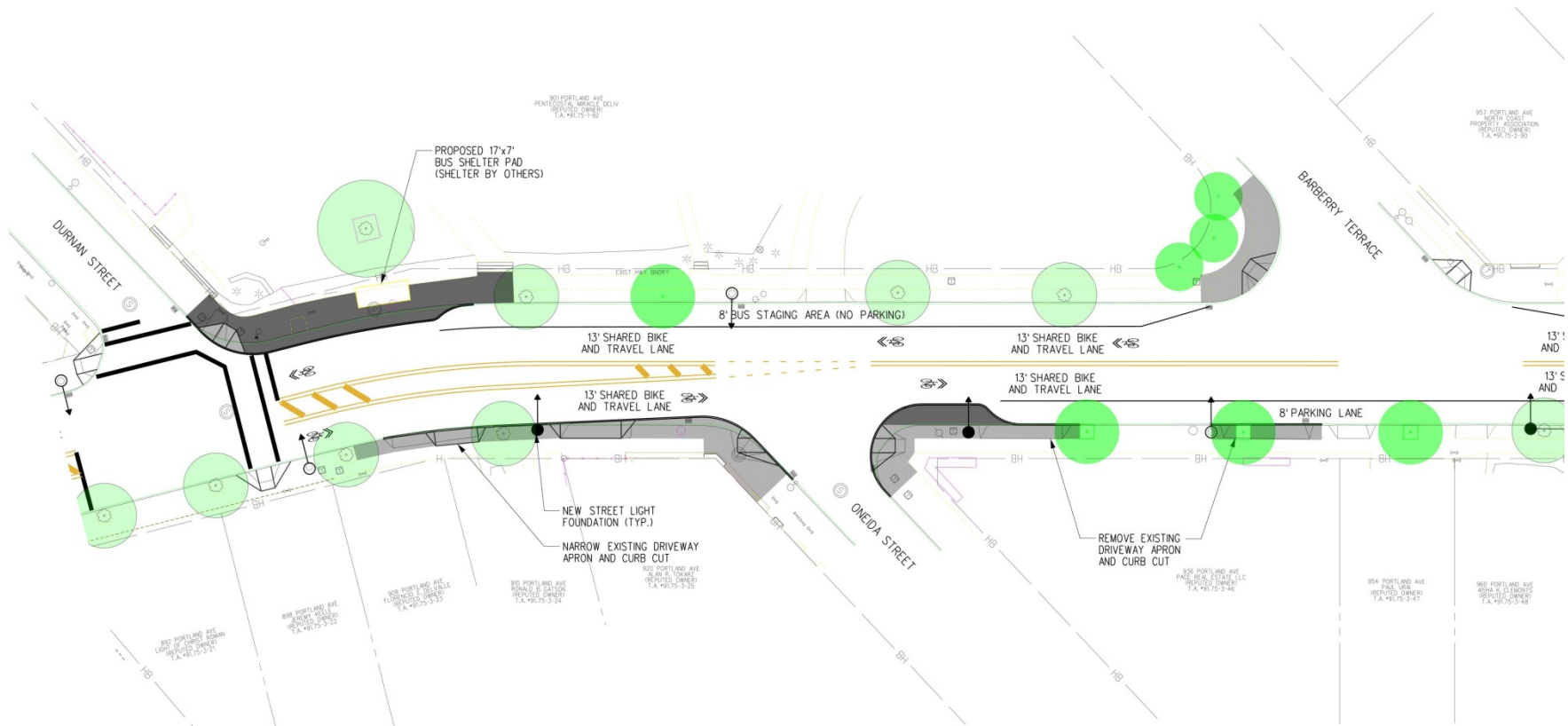



Proposed Bus Shelter
at Durnan Street

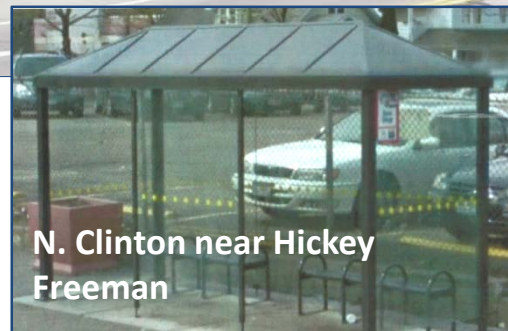

N. Clinton near Hickey
Freeman



Jefferson Avenue at
Columbia

Proposed Bus Shelter at Durnan Street

Portland Avenue Revitalization Project – Proposed Design

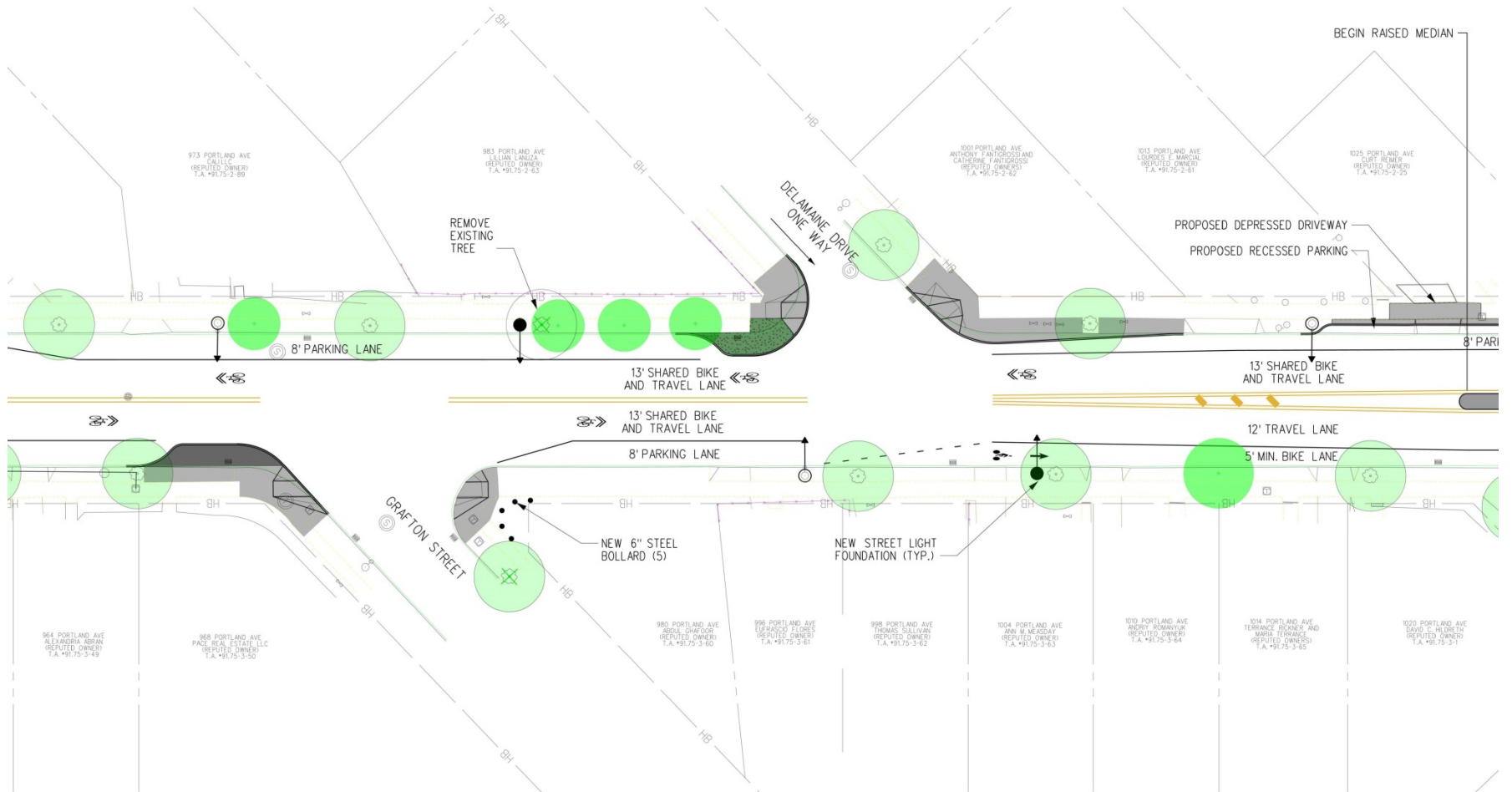

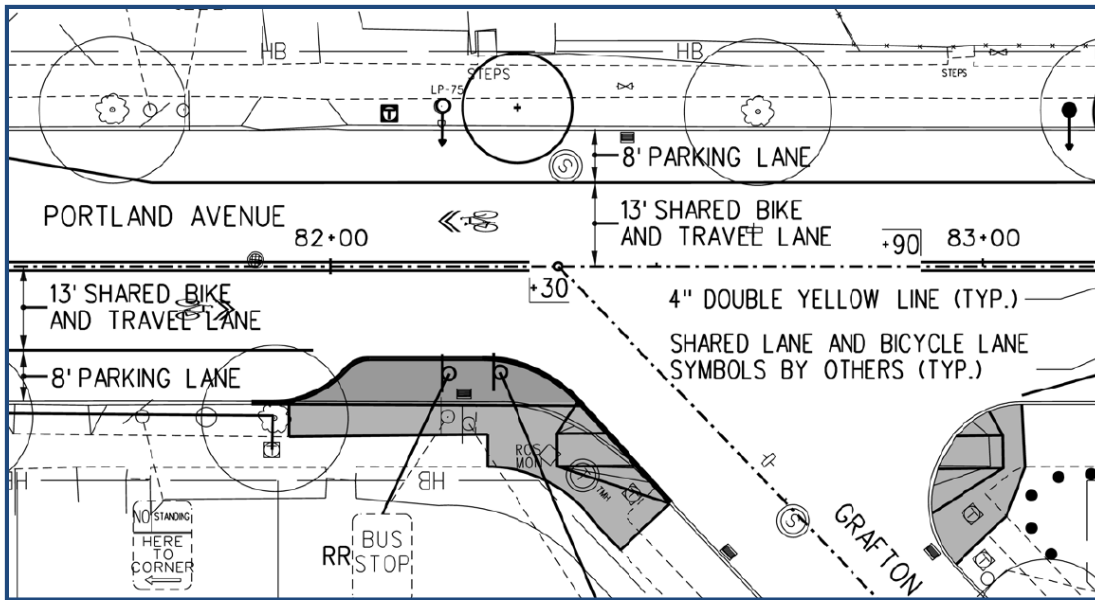

Proposed Curb Bump-outs:

- Durnan Street
- Oneida Street
- Grafton Street
- Delamaine Drive
- Furlong Street
- Turpin Street



Proposed Curb Bump-outs



**Existing Curve near Chapin Street –
Driving Northbound on Portland Avenue**

Portland Avenue Revitalization Project – Proposed Design

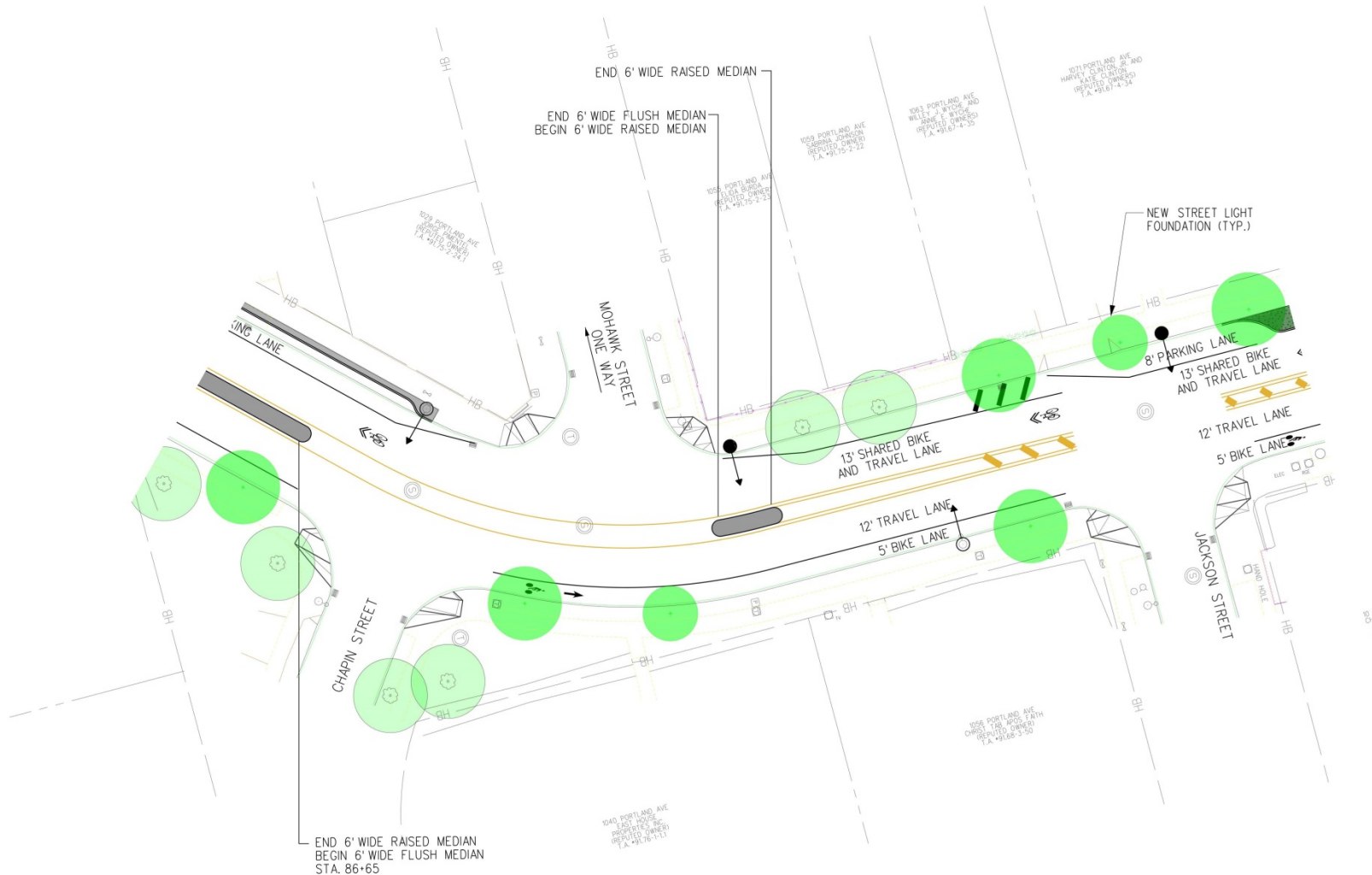

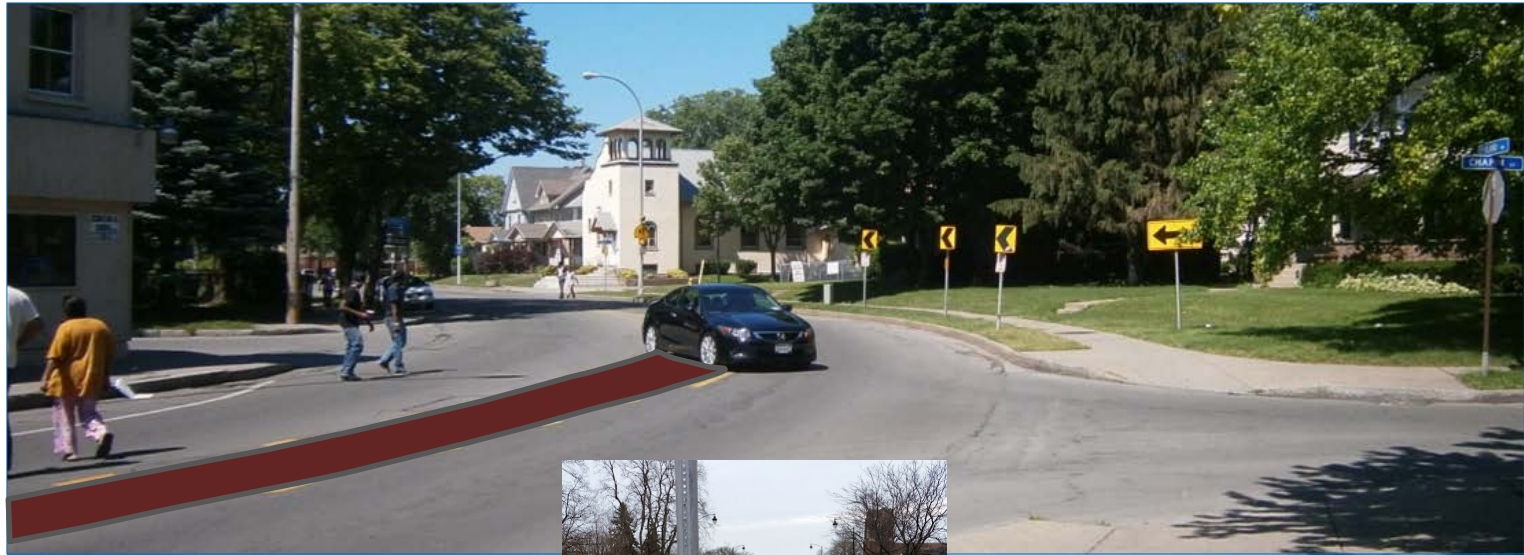

**Raised/Flush Median
on Lake Avenue near
Driving Park**



**Raised Median with
Exposed Aggregate
Concrete Surface**

**Proposed Median Treatment – Curve near Chapin Street
Driving Northbound on Portland Avenue**

Portland Avenue Revitalization Project – Proposed Design

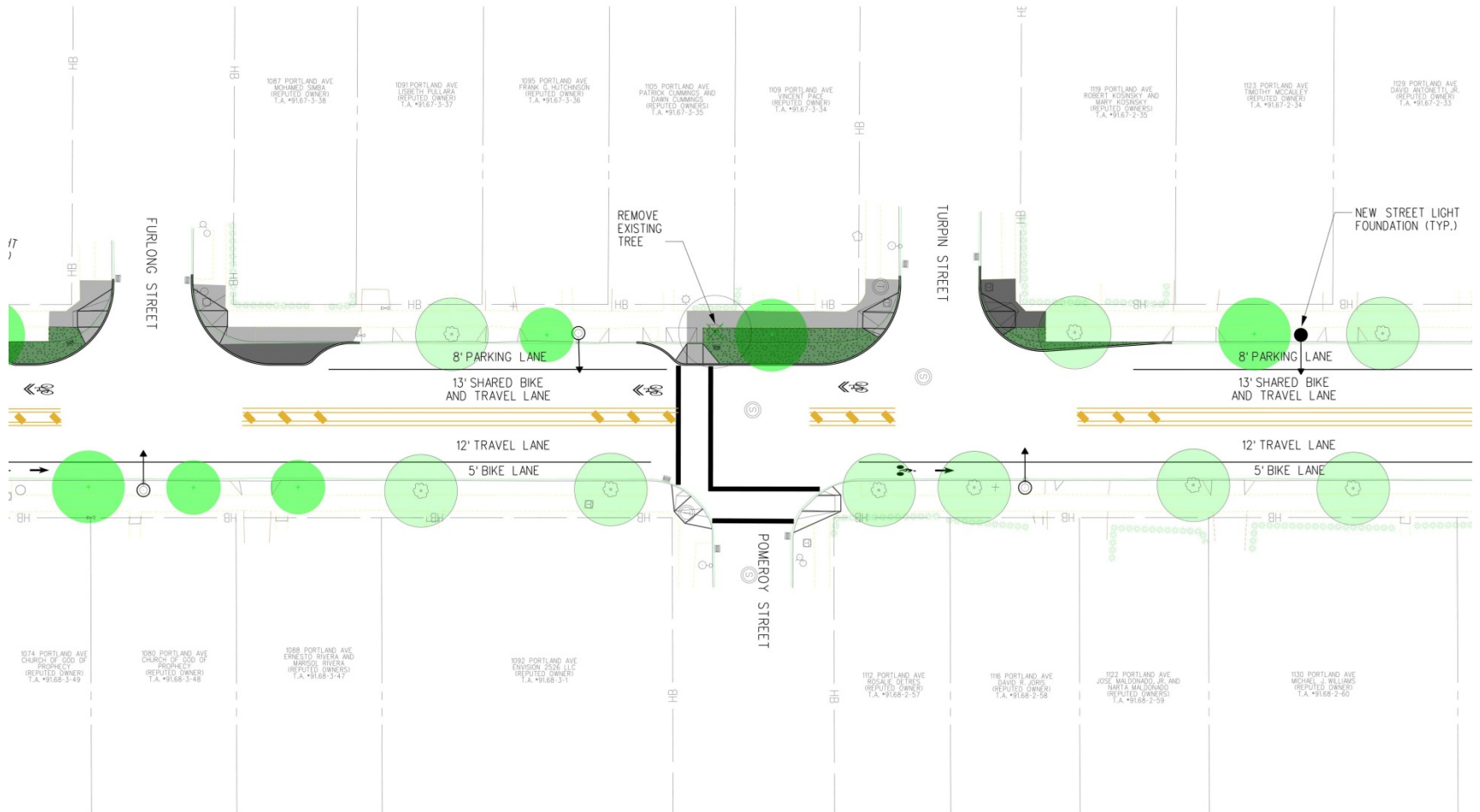

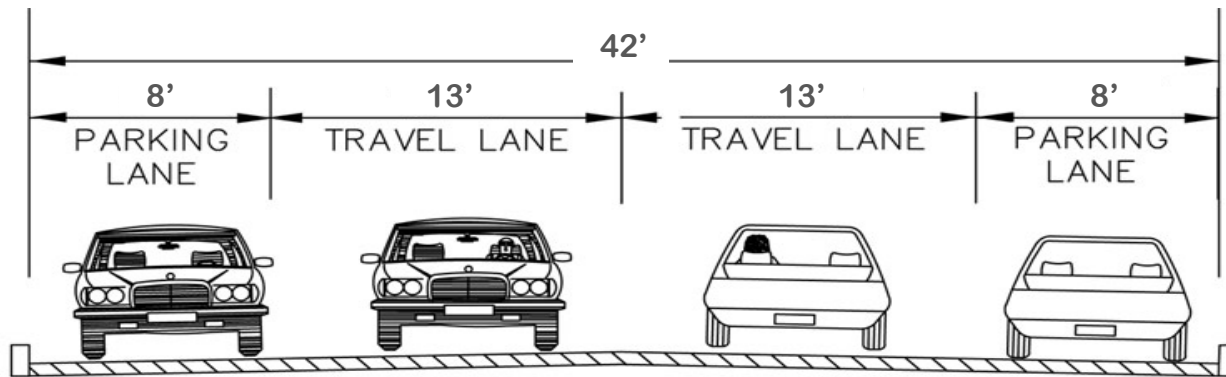

**Existing Typical Section –
View Driving Northbound on Portland Avenue**

BEFORE

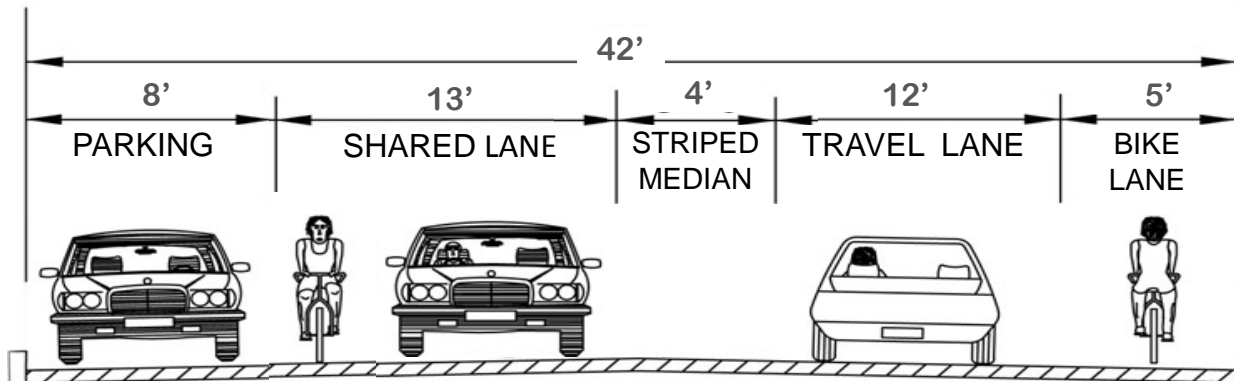

**Proposed Typical Section – w/Bike Lane
View Driving Northbound on Portland Avenue**

AFTER

Portland Avenue Revitalization Project – Proposed Design

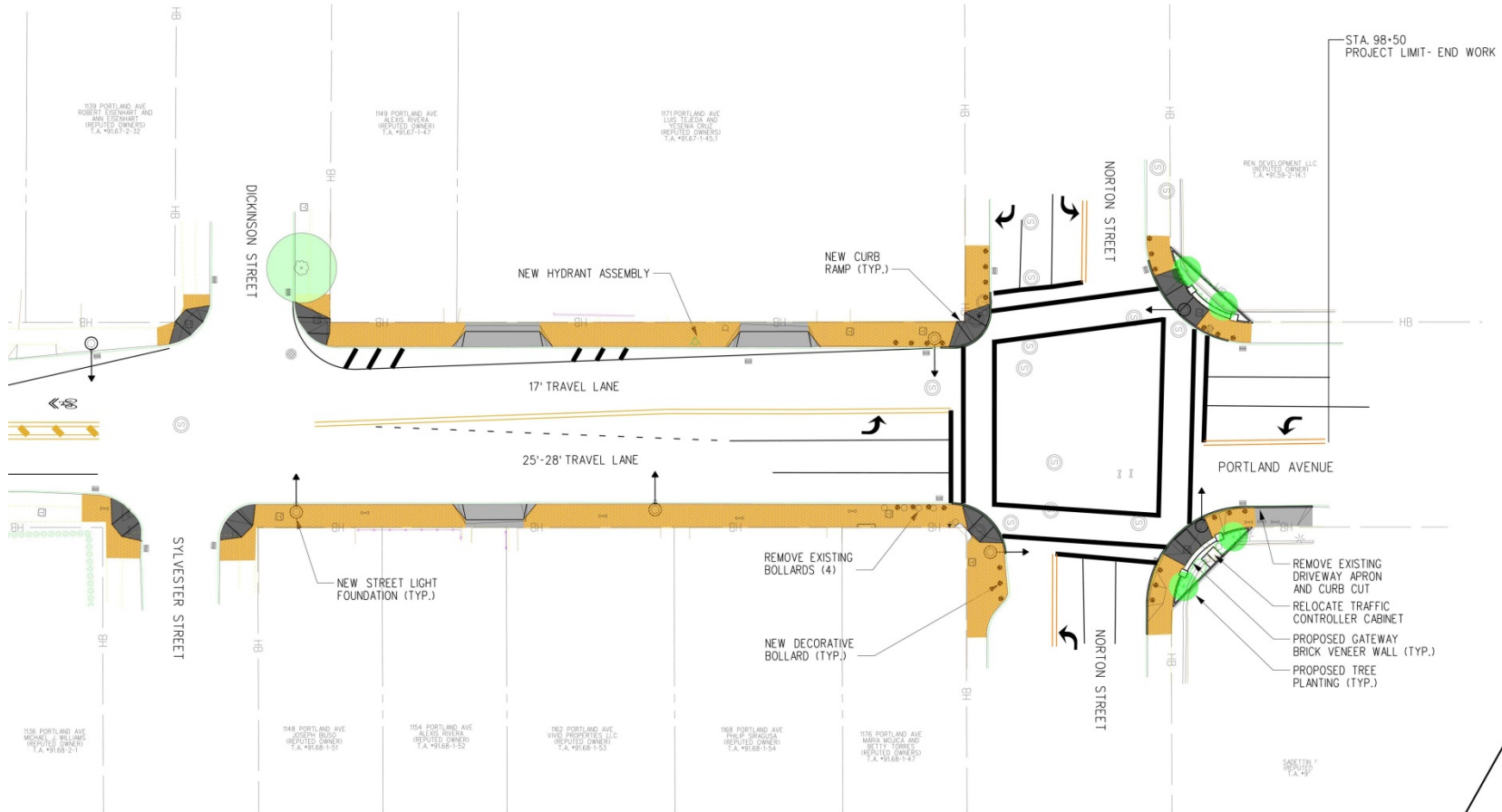

Proposed Gateway – Portland Avenue and Norton Street



View Looking East on Norton Street at Portland Avenue

Proposed Gateway – Portland Avenue and Norton Street



View Looking Southeast on Portland Avenue at Norton Street

Proposed Gateway – Portland Avenue and Norton Street

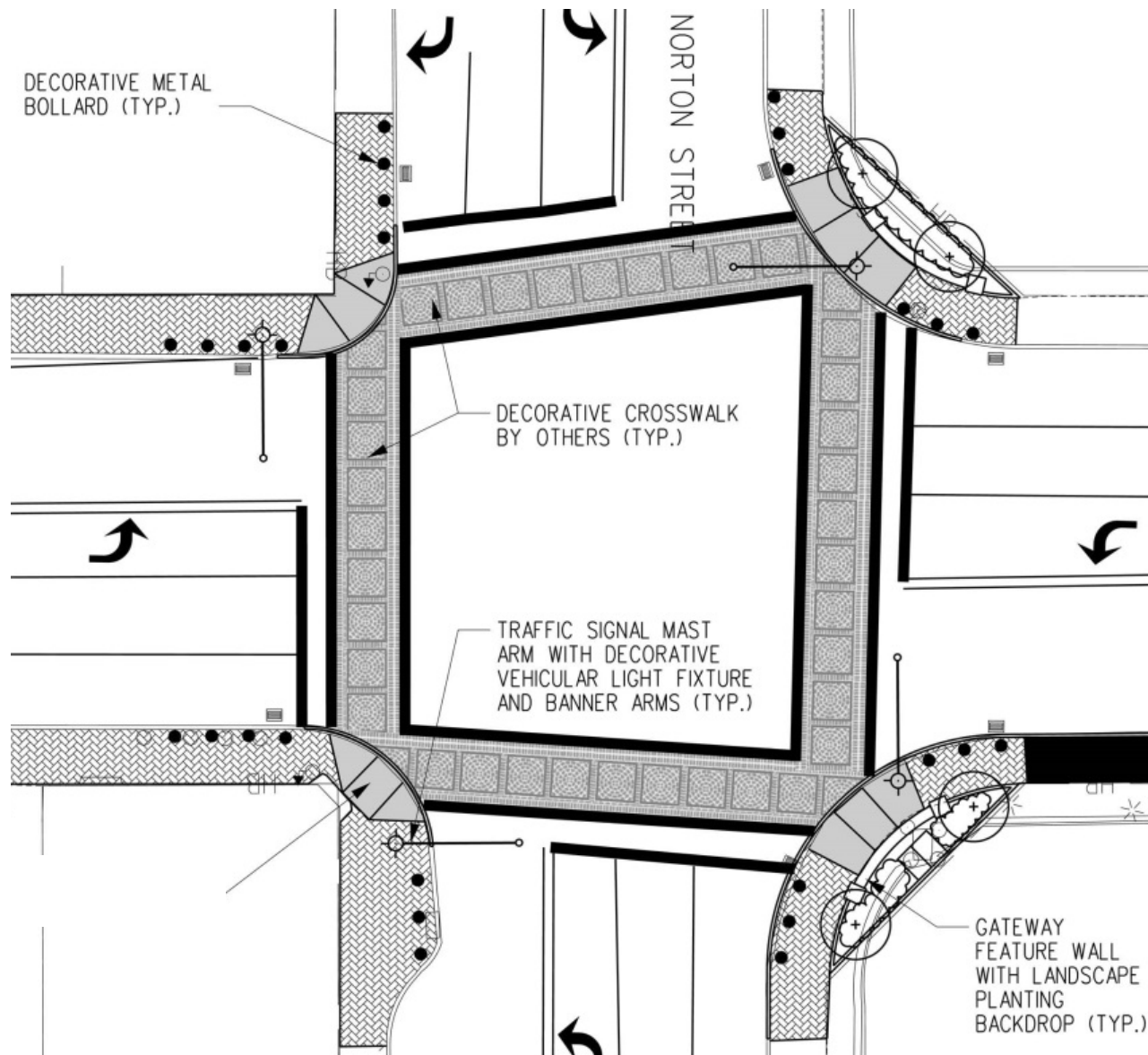

Proposed Gateway – Portland Avenue and Norton Street



View Looking East on Norton Street at Portland Avenue

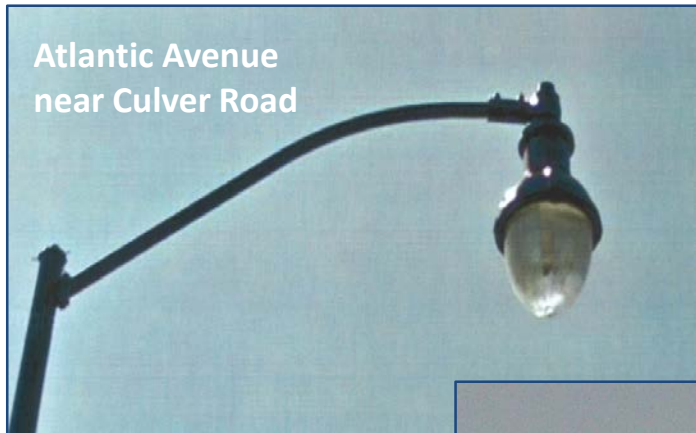

Decorative Street Lighting

Proposed Decorative Street Lighting

Existing light levels:

Average = 1.19 foot-candles

Maximum = 3.48 foot-candles

Minimum = 0.31 foot-candles

Average/Minimum Ratio = 3.8:1



30' tall, 250W HPS

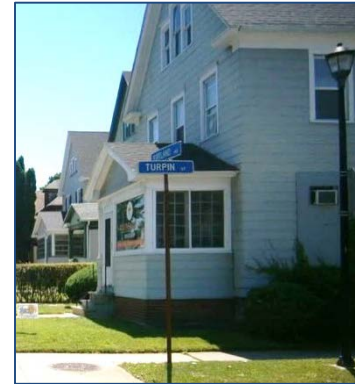

15' tall, 70W HPS

Proposed light levels:

Average = 1.5 to 1.7 foot-candles

Minimum = 0.80 foot-candles

Average/Minimum Ratio = 2.4:1

(improved uniform lighting levels)



New 30' tall, 250W HPS



Existing 15' tall poles
to remain

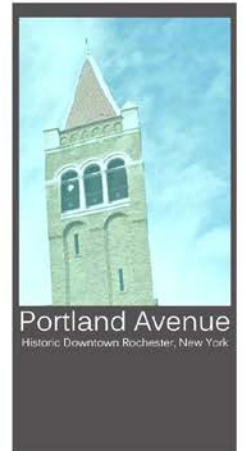
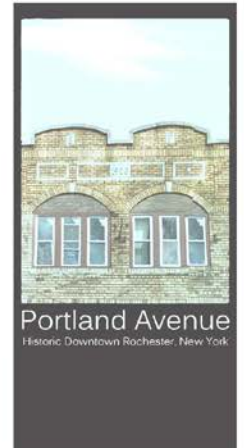
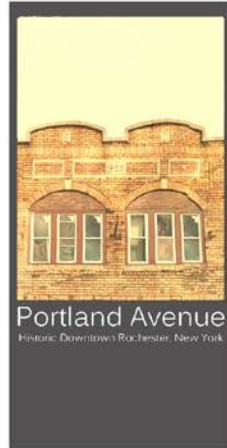

Decorative Banners – Lux Street and Norton Street Gateways



Existing Crosswalk – crossing Portland at Durnan Street

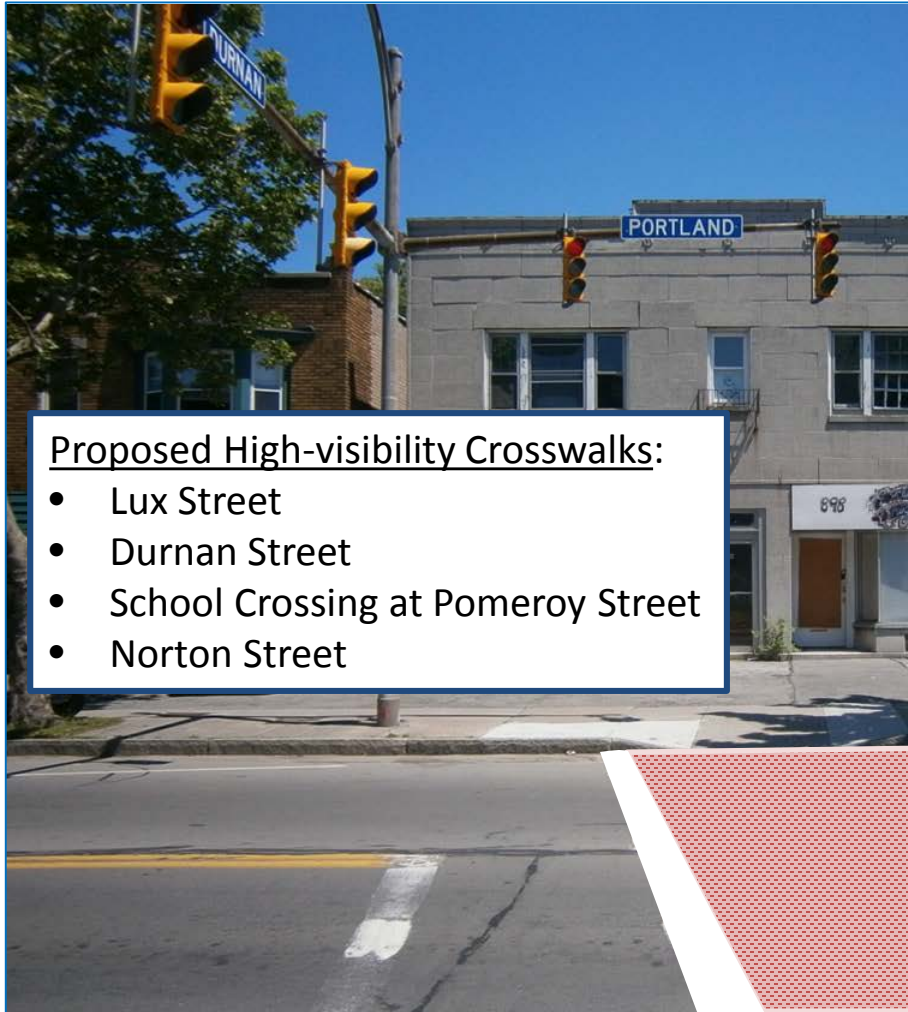

Proposed High-visibility Crosswalks:

- Lux Street
- Durnan Street
- School Crossing at Pomeroy Street
- Norton Street



StreetPrint XD:
Jefferson Avenue at
Columbia Street



Duratherm material:
Plymouth Avenue at
Exchange Street

Proposed High-visibility Crosswalk Treatment

Portland Avenue Revitalization Project – Project schedule and funding

Portland Avenue Revitalization (Lux Street to Norton Street): Streetscape and Beautification Project

Project Schedule:

- Design complete June 2014
- Construction start summer 2014
- Construction complete winter 2014

Funding: 100% City Funding

Future 2015 Preventive Maintenance Project: Portland Avenue from Draper Street to the City Limit Line

Project includes:

- street pavement milling and resurfacing (including Lux to Norton Street)
- high visibility cross-walks (designed with 2014 Beautification project)

Project Schedule:

- design in 2014
- construction in 2015

Funding: 80% Federal Aid

Portland Avenue Revitalization Project – Streetscape and Beautification



Questions?

Project Contact:
Lisa Reyes, City Street Design
ReyesL@cityofrochester.gov
585-428-6354