

Overall Plan

01/18/2024
02/08/2024 Rev 1
06/11/2024 Rev 2

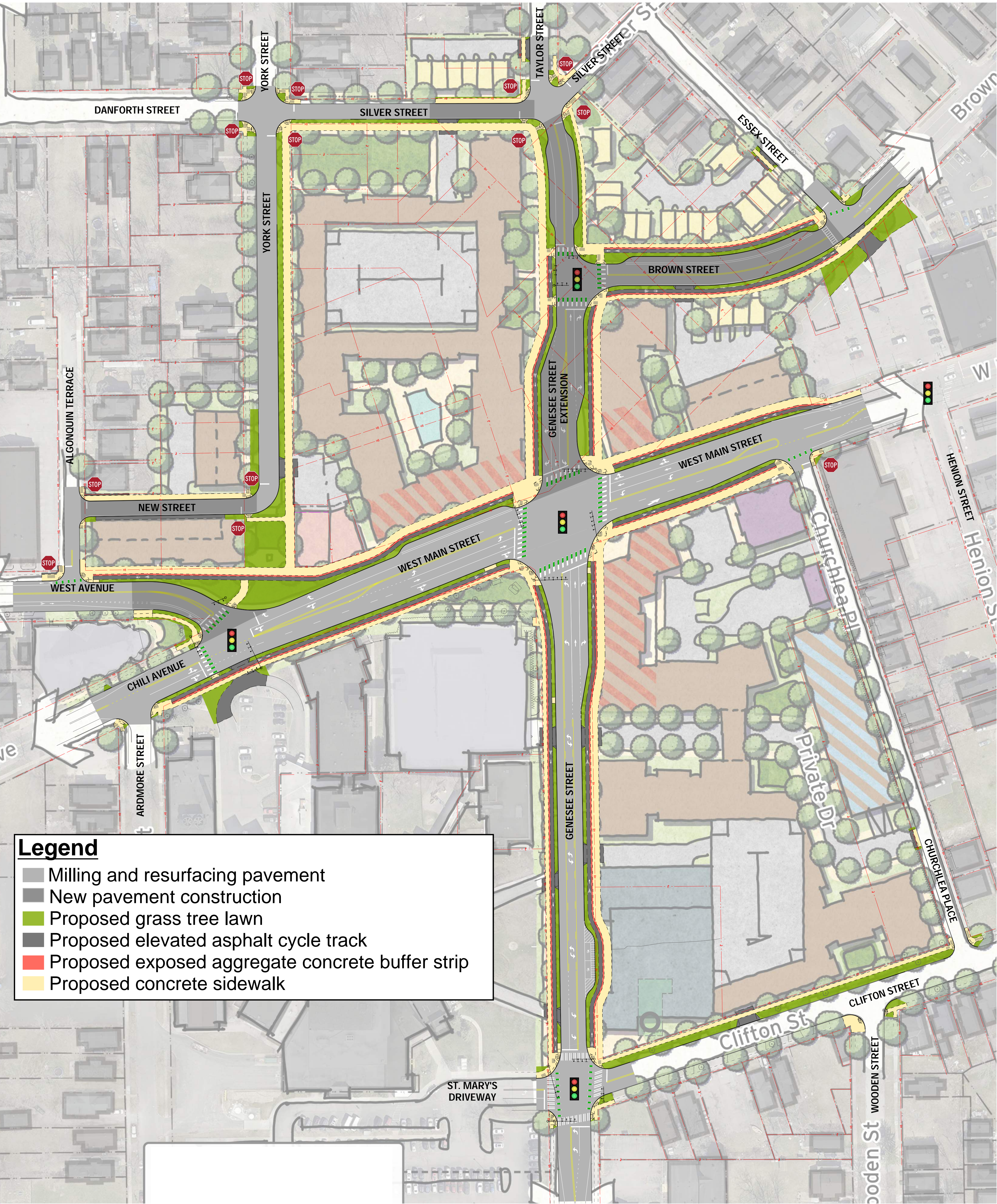

UNDER REVIEW BY CITY OF ROCHESTER



Legend

- Milling and resurfacing pavement
- New pavement construction
- Proposed grass tree lawn
- Proposed elevated asphalt cycle track
- Proposed exposed aggregate concrete buffer strip
- Proposed concrete sidewalk

WEST MAIN STREET

Legend

- Milling and resurfacing pavement
- New pavement construction
- Proposed grass tree lawn
- Proposed elevated cycle track
- Proposed exposed aggregate concrete buffer strip
- Proposed concrete sidewalk

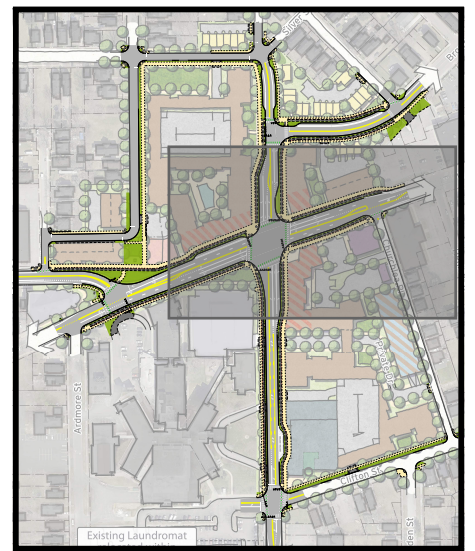
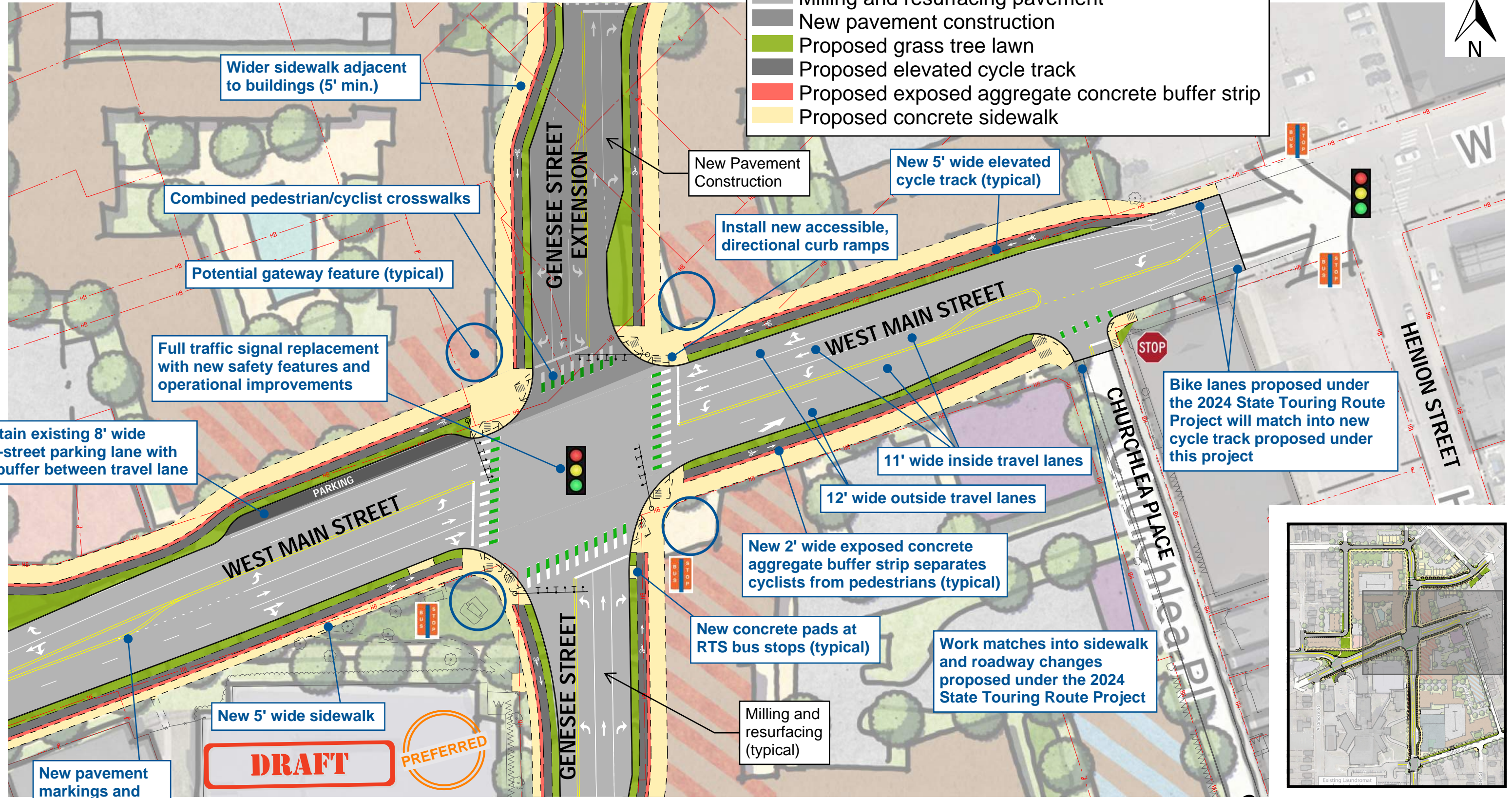

GENESEE STREET

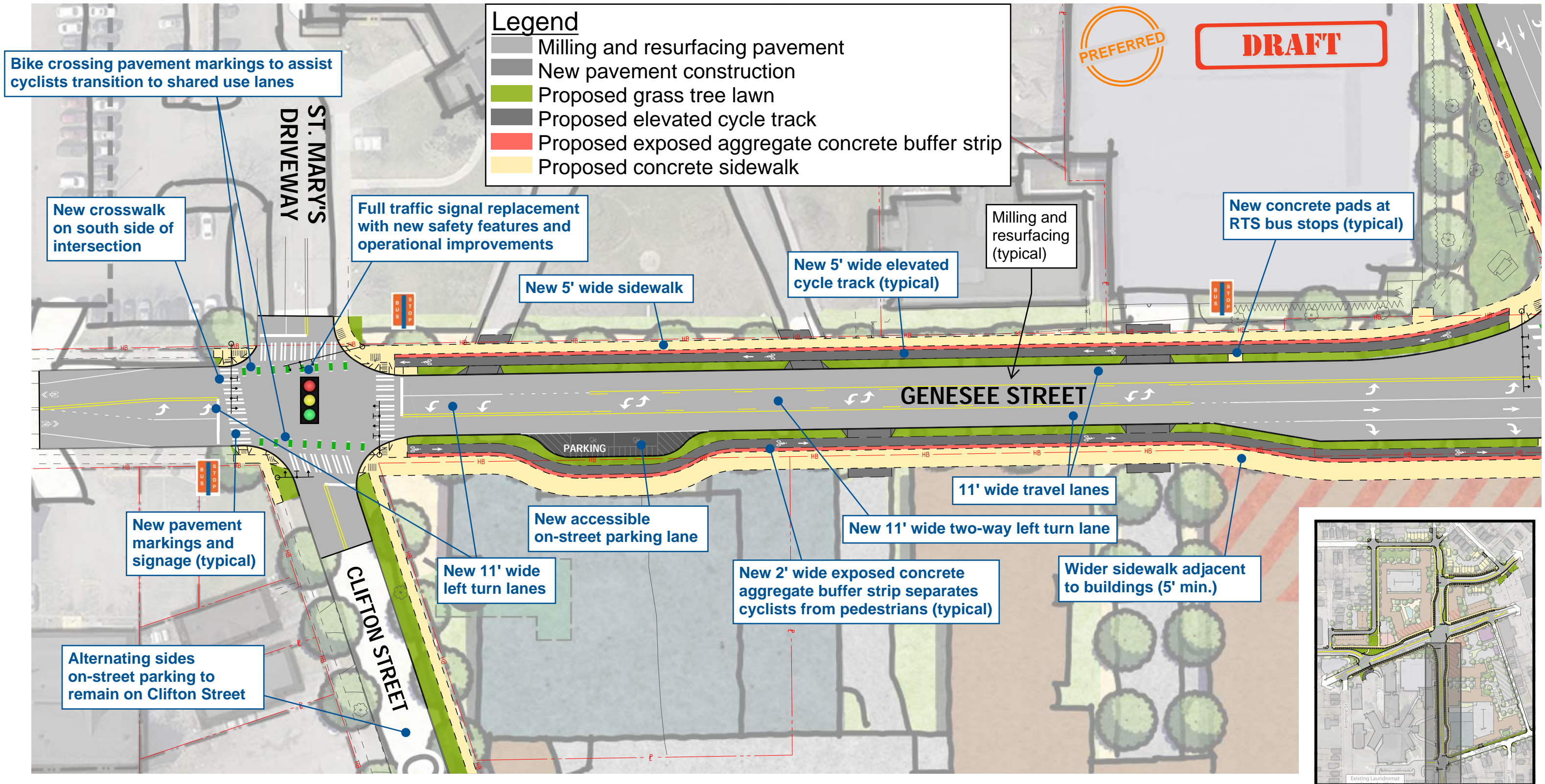





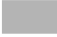

*Genesee Street proposed improvements are pending review of utility impacts and budget
 Refer to the Alternate Design should utility or budget require a modified design

GENESEE STREET ALTERNATE DESIGN - IN-STREET BIKE LANES

DRAFT 

Legend

-  Milling and resurfacing pavement
-  New pavement construction
-  Proposed grass tree lawn
-  Proposed elevated cycle track
-  Proposed exposed aggregate concrete buffer strip
-  Proposed concrete sidewalk

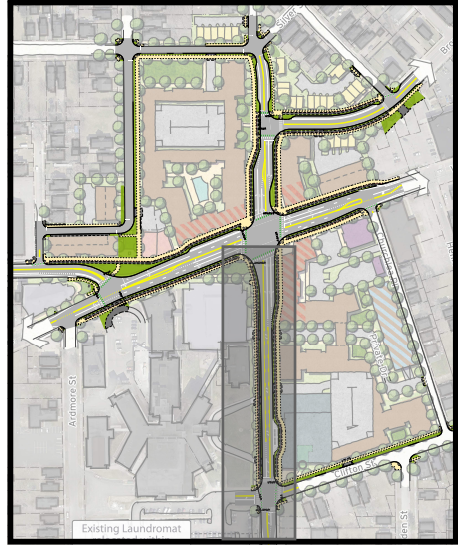
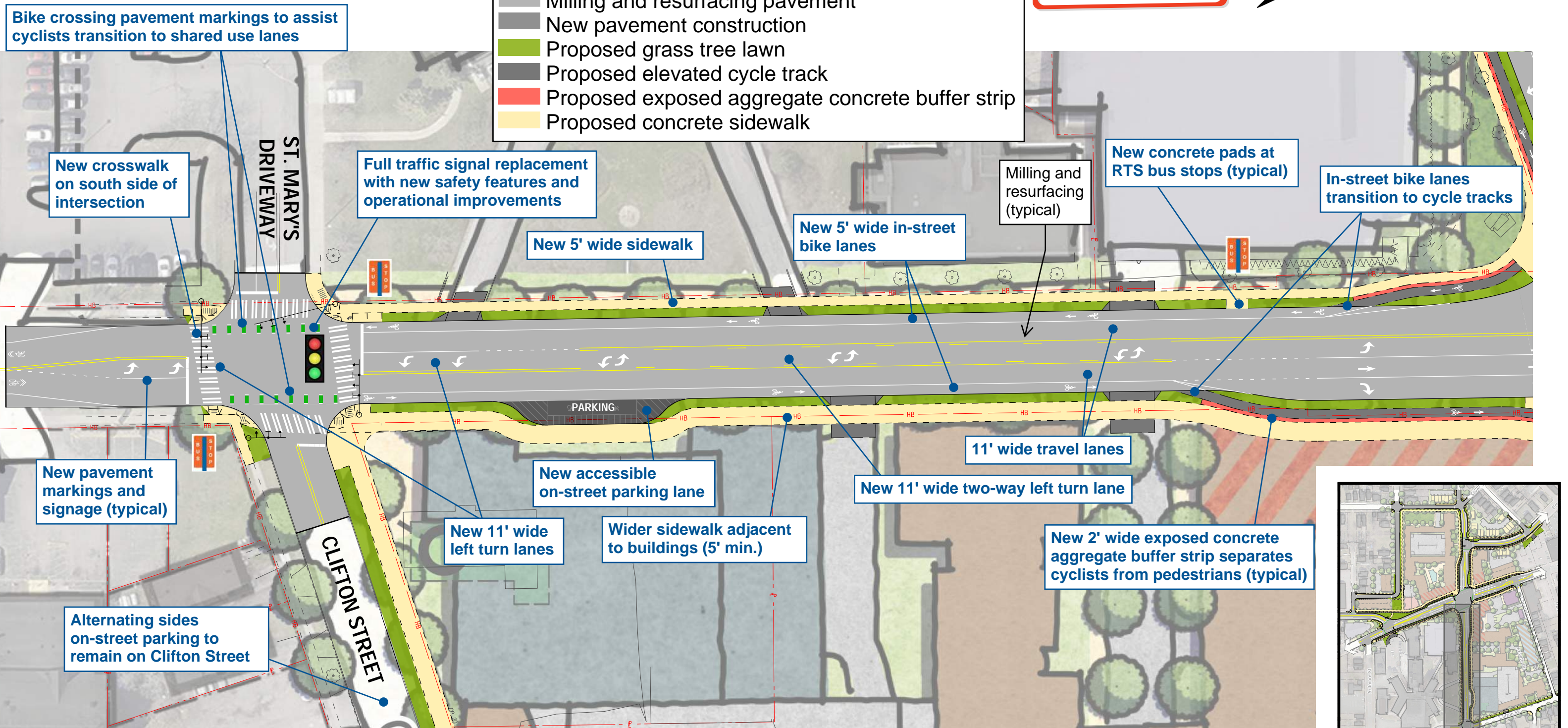

Genesee Street Alternate Design should utility or budget require a modified design

CHILI AVE / WEST AVE

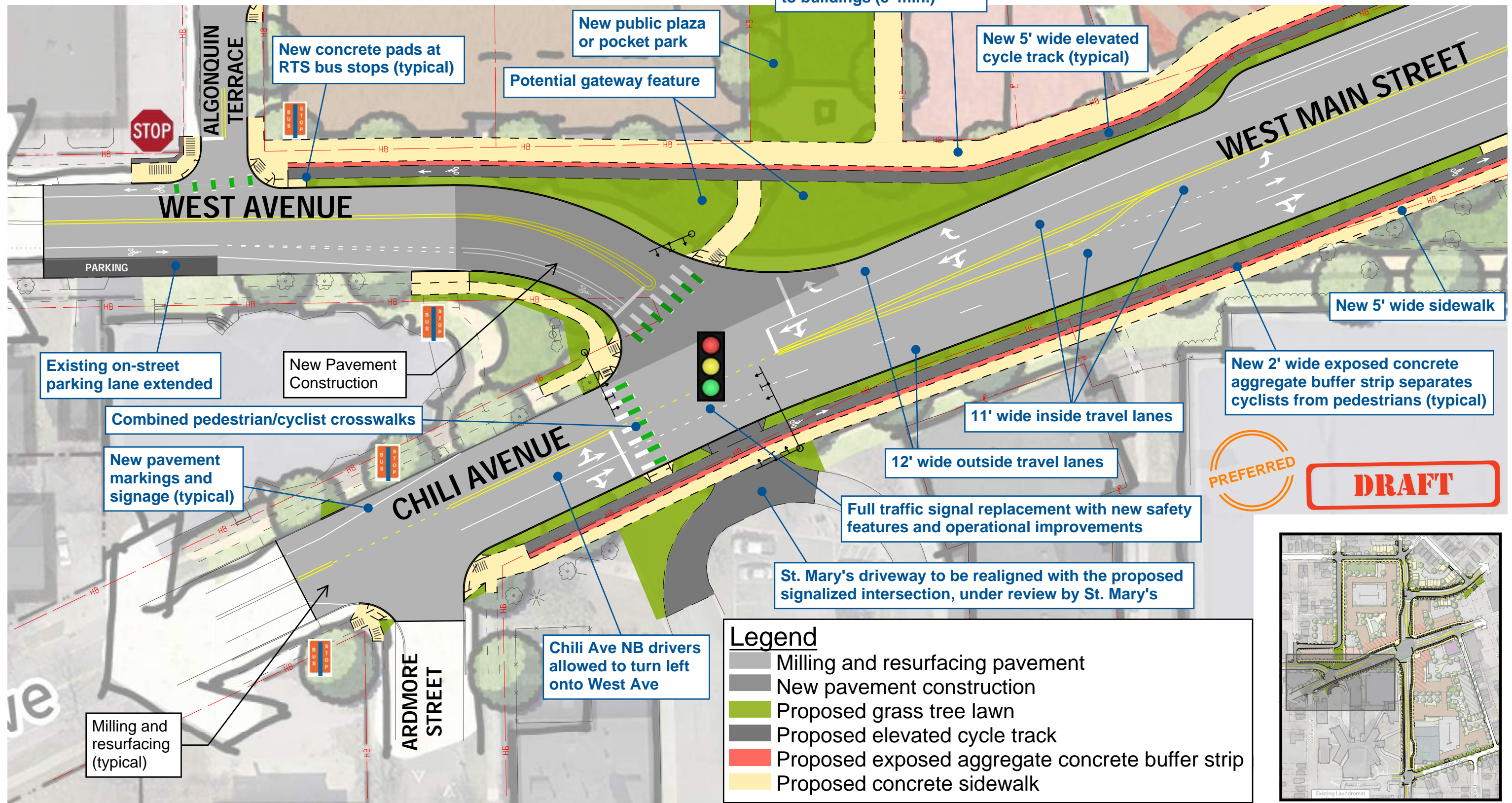

GENESEE ST / BROWN ST

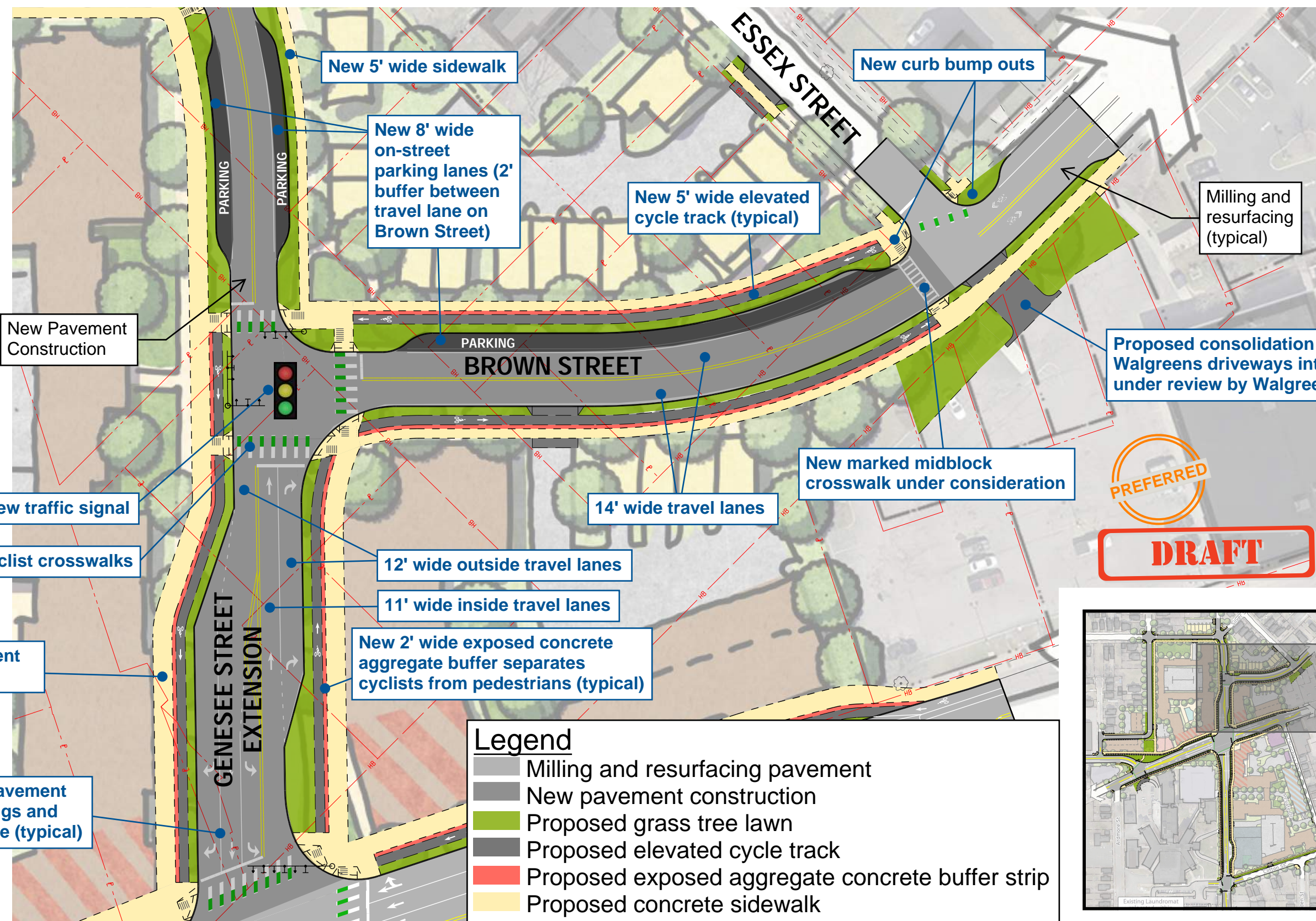

New Pavement Construction

New traffic signal

Combined pedestrian/cyclist crosswalks

Wider sidewalk adjacent to buildings (5' min.)

New pavement markings and signage (typical)

New 5' wide sidewalk

New 8' wide on-street parking lanes (2' buffer between travel lane on Brown Street)

New 5' wide elevated cycle track (typical)

New curb bump outs

Milling and resurfacing (typical)

Proposed consolidation of two Walgreens driveways into one, under review by Walgreens

New marked midblock crosswalk under consideration

PREFERRED

DRAFT

14' wide travel lanes

12' wide outside travel lanes

11' wide inside travel lanes

New 2' wide exposed concrete aggregate buffer separates cyclists from pedestrians (typical)

Legend

- Milling and resurfacing pavement
- New pavement construction
- Proposed grass tree lawn
- Proposed elevated cycle track
- Proposed exposed aggregate concrete buffer strip
- Proposed concrete sidewalk

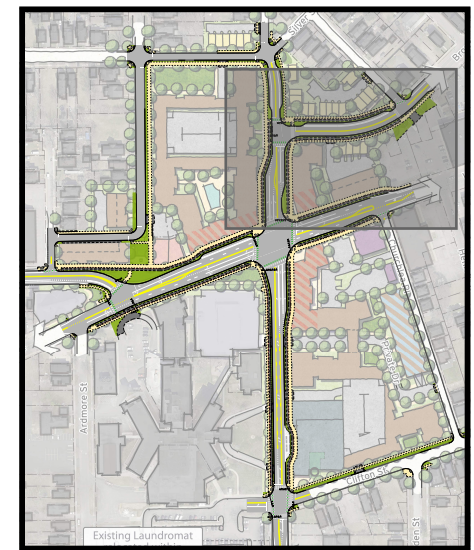

DANFORTH STREET, SILVER STREET, YORK STREET, NEW STREET

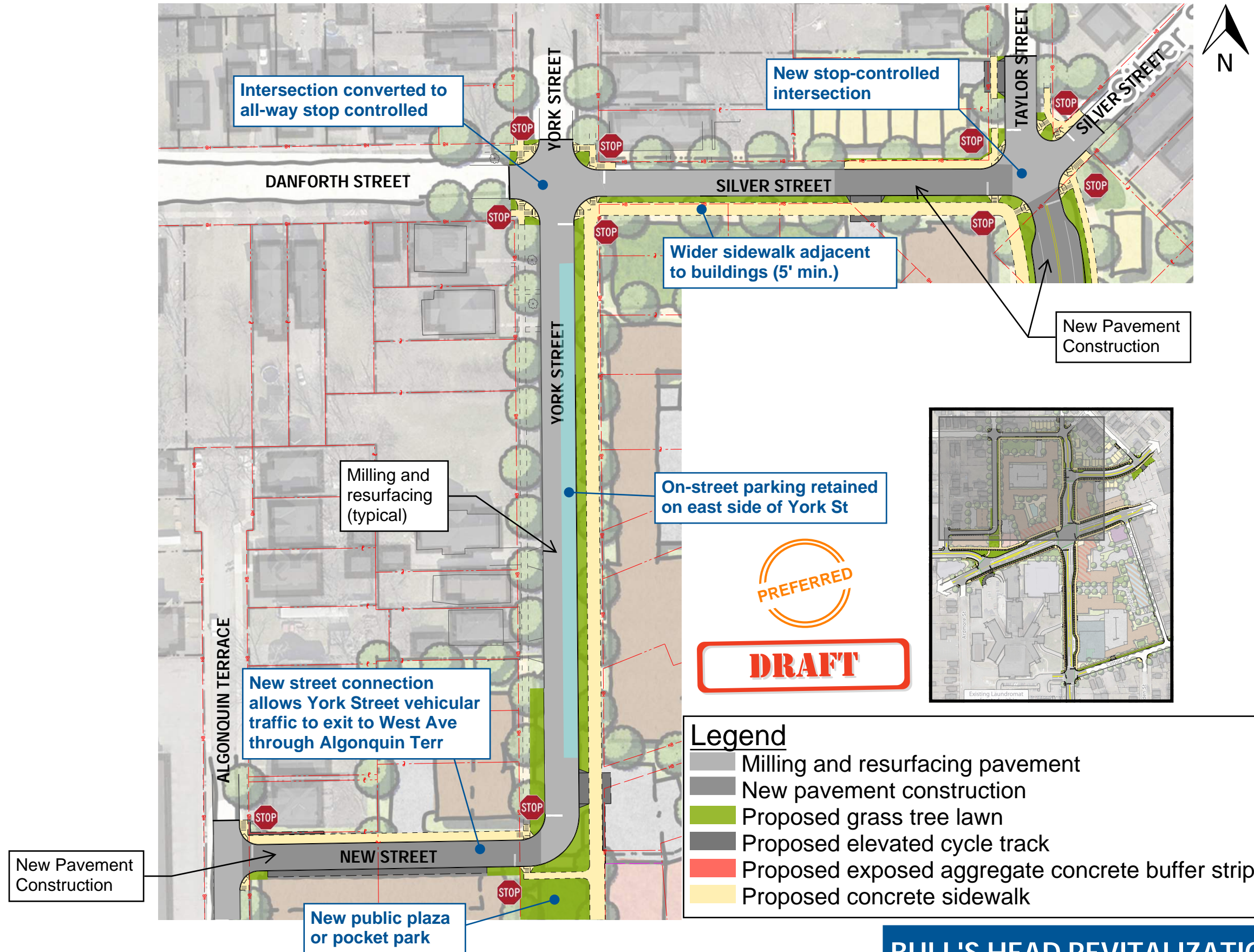

LOCAL EXAMPLES



Curb bump out at University Ave/East Blvd
Similar to curb bump out proposed at Brown St/Essex St



Midblock crossing at University Ave/East Blvd
Similar to midblock crossing under consideration at Brown St/Essex St



Midblock crossing at East Ave/East Blvd
Similar to midblock crossing under consideration at Brown St/Essex St



Recessed parking lane on East Blvd at East Ave
Similar to recessed parking lane proposed on Genesee St Extension between Silver St and Brown St



Elevated cycle track on Elmwood Ave with 2' wide exposed aggregate concrete buffer strip and 5' wide concrete sidewalk
Similar to one-way cycle track proposed throughout the project



Combined pedestrian/cyclist crosswalk at Mt. Hope Ave/Elmwood Ave
Similar to combined crosswalks proposed at W Main/Chili/West and W Main/Genesee, and Genesee Ext./Brown

RENDERINGS



Genesee St. facing south towards Clifton St.



W Main St. facing east towards Genesee St.



W Main St. facing west between Churchlea Pl. and Henion St.



W Main St. facing west towards Chili Ave. at West Ave.

CYCLE TRACK VARIATIONS

CURRENT DESIGN

Pros

- Provides more separation between vehicles and cyclists
- Greater snow storage space
- Potential for less impacts to utilities
- Easier for snow plowing/maintenance activities

Cons

- Could lead to pedestrian/cyclist mixing
- Cyclists may have less of an advantage watching for cars exiting a driveway



ALTERNATE DESIGN UNDER EVALUATION

Pros

- Provides more separation between cyclist and pedestrians
- Better suited when buildings are very close to the Right-of-Way

Cons

- Cycle track would likely be used for snow storage
- Potential for reduced sidewalk width in locations with limited Right-of-Way

