

**LABELLA**

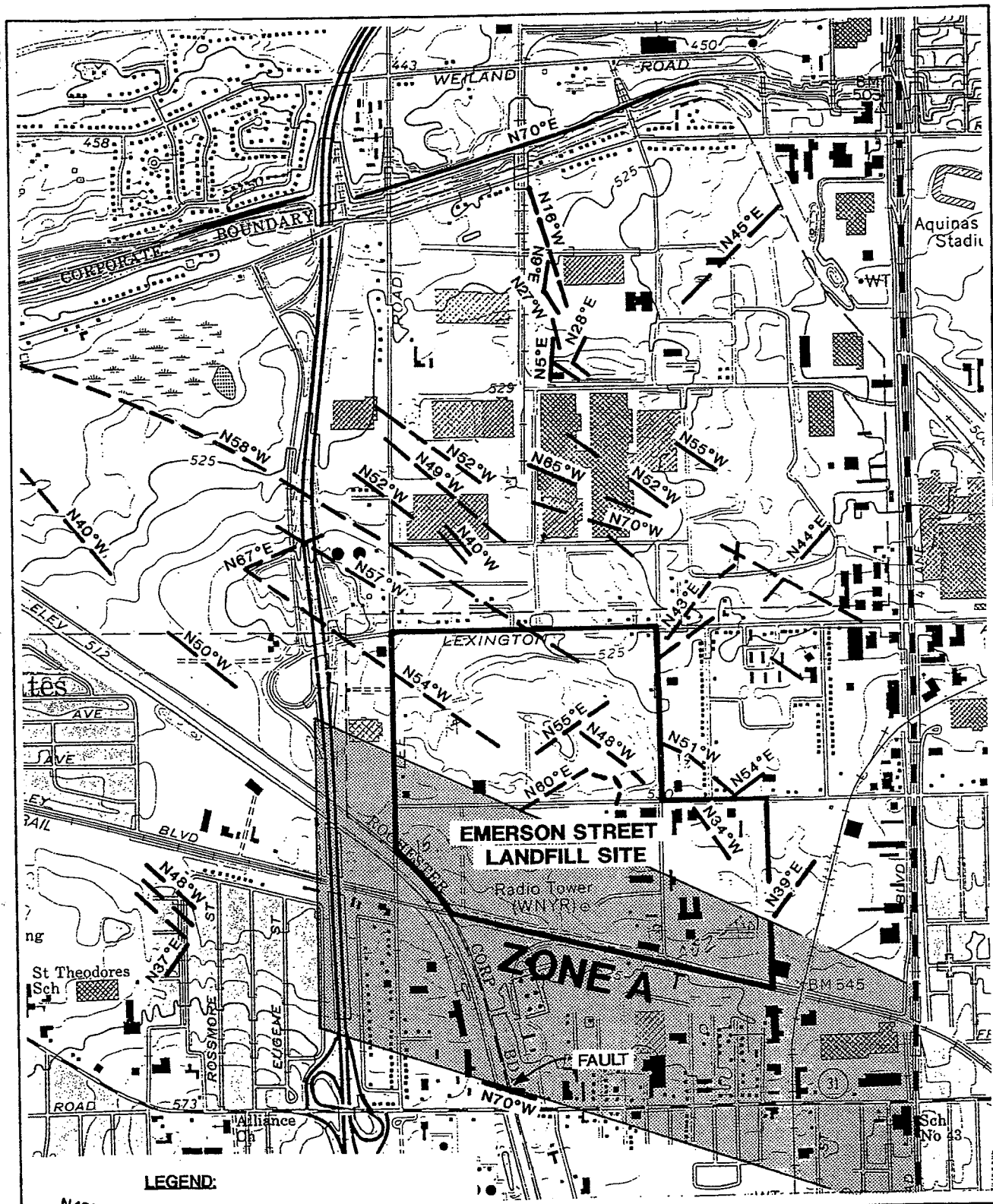

LaBella Associates, P.C.  
300 State Street  
Rochester, New York 14614

## **Appendix 12**

H&A January 1994 Figure 10  
“Linear and Structural Features”

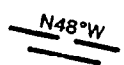

**LEGEND:**

-  OBSERVED LINEAR FEATURE WITH ORIENTATION DIRECTION
-  ZONE "A" OF STRUCTURAL DEFORMATION INFERRED IN CSOAP INVESTIGATION (H&A, 1982)

**NOTE:**  
 BASE MAP FROM U.S.G.S. TOPOGRAPHIC,  
 ROCHESTER WEST, 7.5 MINUT

**H & A OF NEW YORK**

 Geotechnical Engineers & Environmental Consultants

**FORMER EMERSON STREET LANDFILL  
 MODIFIED REMEDIAL INVESTIGATION**

**LINEAR AND STRUCTURAL FEATURES**

JANUARY 1994