

A vibrant illustration of a young girl with dark hair, smiling warmly. She is wearing a light blue shirt and a colorful lei made of various flowers including purple, yellow, and blue. The background is a textured, stone-like wall.

Department of **Recreation & Human Services**

University-Merriman Playground Replacement Follow-Up Meeting
November 12, 2020



City of Rochester, NY
Lovely A. Warren, Mayor
Rochester City Council



Agenda

Sara Scott

- Welcome & Introductions
- Project Overview & Timeline
- Design
- Q&A
- Wrap up

Welcome & Introductions

Sara Scott

- Sara Scott
Director of Recreation: Department of Recreation and Human Services, City of Rochester
- Robin Schutte
Assistant Landscape Architect: Department of Environmental Services, City of Rochester
- Sarah Nguyen Hooper
Project Manager: Department of Recreation and Human Services, City of Rochester
- Linda Culliton
Designer/Sales Rep: GameTime Playgrounds

Project Overview & Timeline

Robin Schutte and Sara Scott

- Project Scope
- Timeline & Process
 - Construction summer 2021
 - Completion fall 2021
- Review of public input from September 2020

Public Consensus	Design Solution
Preserve existing greenspace.	The design keeps close to the existing playground’s footprint, ruling out traditional swings, but including swinging elements.
Incorporate the NOTA color palette (black, white, yellow) and progressive design.	These colors can be incorporated into the “Modern City” play equipment line.
Include benches and picnic tables.	These items are incorporated into the design.
Incorporate a variety of options for play, including hanging, climbing, sliding, and traveling	These features are incorporated into the design.
Include toddler play equipment.	Toddler play equipment is included in the design.
Minimize use of asphalt.	Only a short asphalt path and pad is required to provide ADA accessibility to the play equipment.

Design: Site Map

Robin Schutte

UNIVERSITY AVENUE PLAYGROUND IMPROVEMENTS

PRELIMINARY DESIGN FOR DISCUSSION

NOVEMBER 2020
NOT TO SCALE

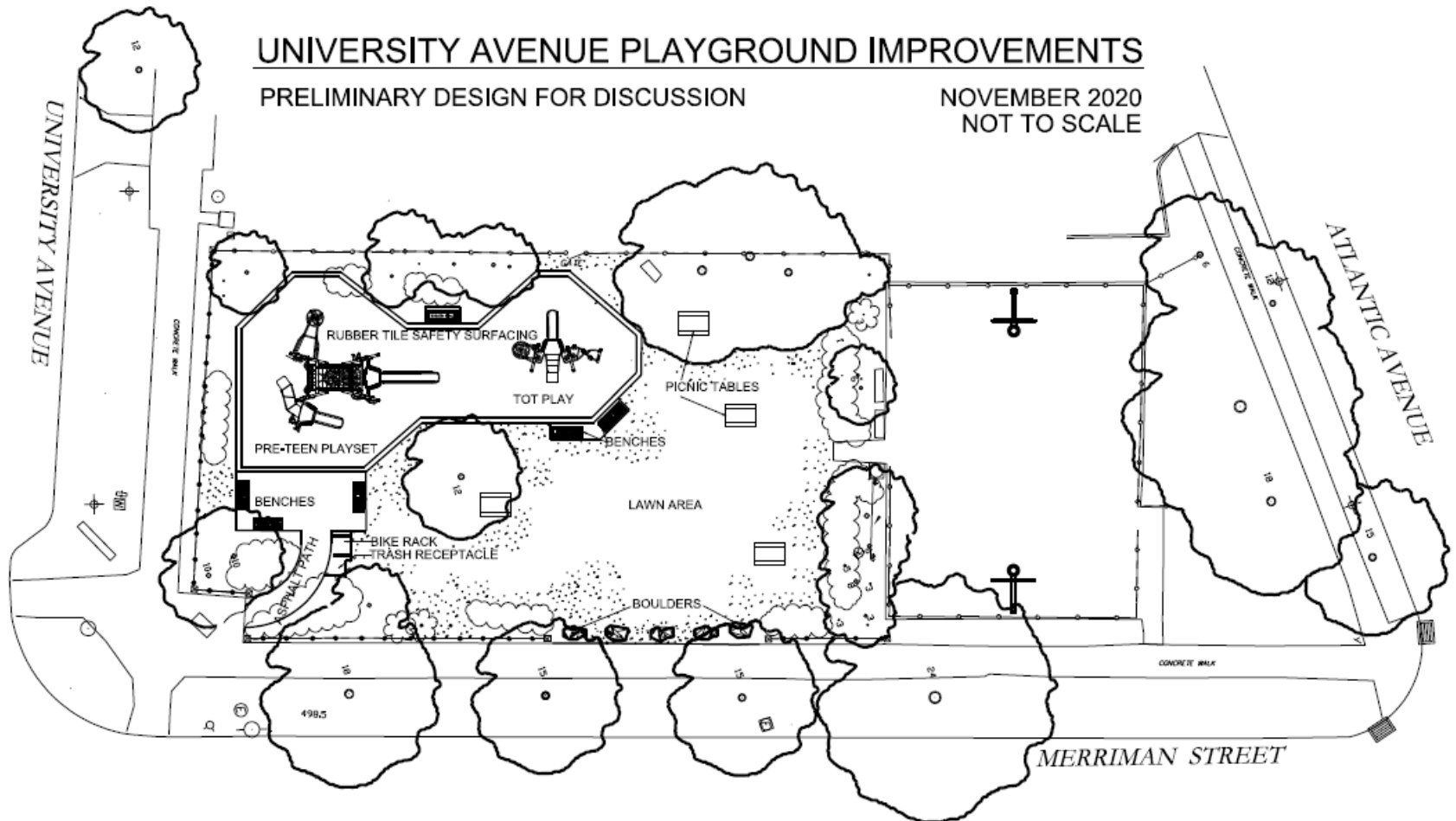

Site Rendering #1



play.site.sport.
800.922.0070 / www.mrcrc.com

Merriman Playground - Rochester, NY
View A



PLAYCORE creates

Site Rendering #2



Site Rendering #3

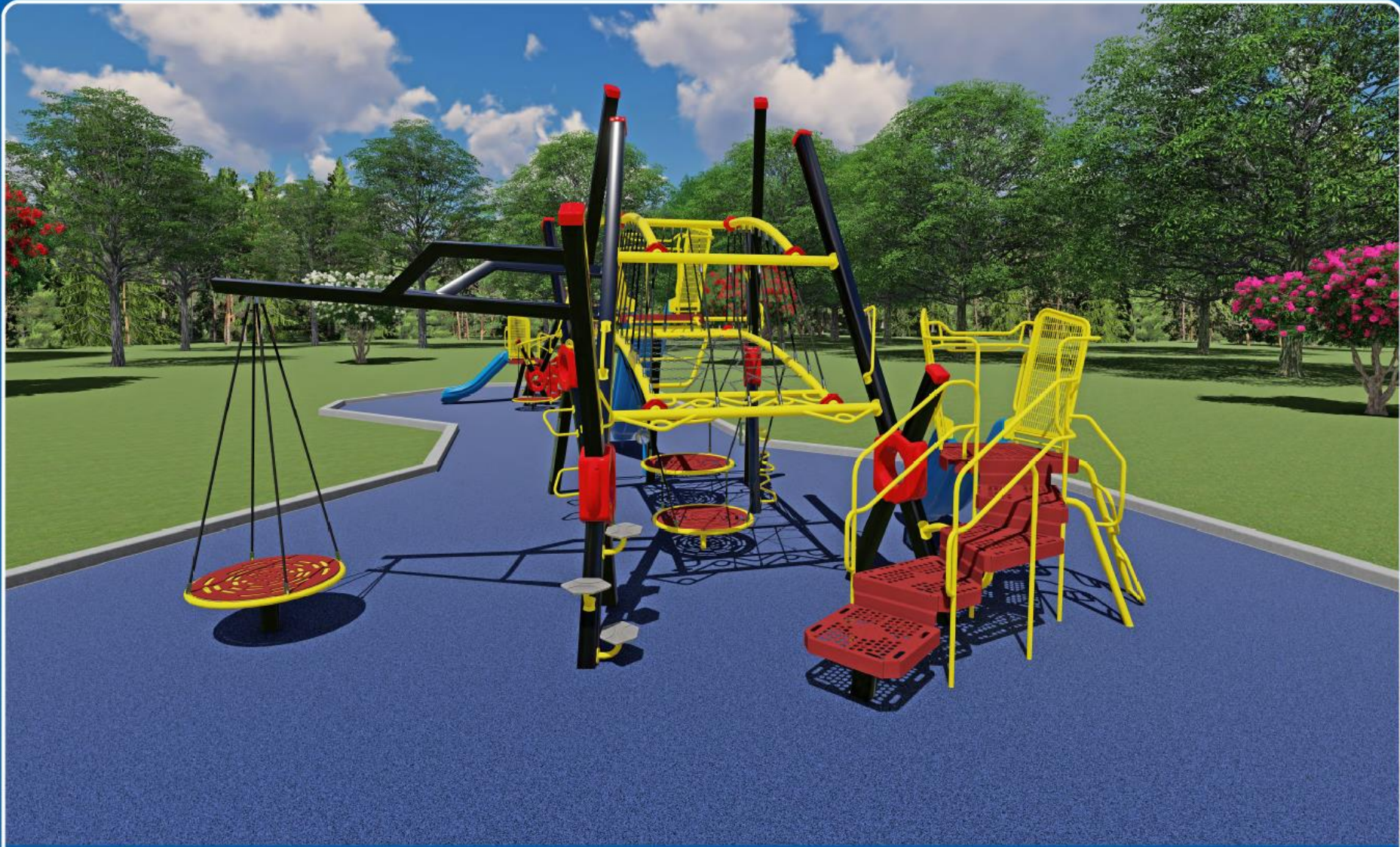

play.site.sport.
800.922.0070 / www.mrcrc.com

Merriman Playground - Rochester, NY
View C



A PLAYCORE Company

Playground Sample Photos #1

Robin Schutte



Playground Sample Photos #2

Robin Schutte



Playground Sample Photos #3

Robin Schutte



Playground Sample Photos #4

Robin Schutte



Playground Sample Photos #5

Robin Schutte



Questions & Answers

Sara Scott

- To ask questions during the meeting, you will need to raise your hand. The facilitator will then unmute and introduce you.

To raise your hand, click on the icon labeled "Participants" at the bottom center of your PC or Mac screen. At the bottom of the window on the right side of the screen, click the button labeled "Raise Hand." Your digital hand is now raised.

Wrap Up

Sara Scott

Thank you for participating!