

Memo



Stantec

Inner Loop – Accident History

Date: August 11, 2009 (Updated May 29, 2013)
To: Bill Holthoff, Stantec
From: Paula Benway, Stantec

Inner Loop Accident Data

The following information covers the accident history for the Inner Loop (Rt. 940T), Union Street and Pitkin Street from the Monroe Avenue interchange to approximately Charlotte Street. *An extensive overall project "Accident History" evaluation that covers the aforementioned limits as well as adjoining and nearby streets and segments is included in the Inner Loop - Accident History Technical Memorandum, dated April 24, 2009, and is referenced herein.*

The most recent information available represents a 38-month period between January 1, 2005 and March 7, 2008. The accident history identified a total of 40 accidents occurred along the Inner Loop in this area. The reportable accidents accounted for 26 (65%) of the total accidents and the non-reportable accidents accounted for 14 (35%) of the total accidents. The following list summarizes the type and number of accidents.

- Fixed Object – 18 (45%)
- Rear End – 10 (25%)
- Sideswipe – 6 (15%)
- Head On – 2 (0.05%)
- Overtaking – 1 (0.025%)
- Right Angle – 1 (0.025%)
- Head-on – 1 (0.025%)
- Unknown – 1 (0.025%)

The accident severity included 13 injuries (32%) and 27 (68%) property damage only. Fifty three percent of all accidents occurred during evening hours with 55% occurring on dry pavement conditions. As indicated above, 45% of the accidents involved collision with fixed objects (guide rail, curbing, abutment, debris). Only four of the 40 accidents occurred at a merge/diverge ramp locations. The accident rate for the corridor was calculated and compared to statewide accident rates for Principal Arterial expressways. The current accident rate is 2.15 accidents per million vehicle miles (acc/mvm) which is below the statewide average of 2.72 acc/mvm. Collision diagrams, detailed accident history, and rate calculations are attached.

Based on the extended accident study area (dated April 24, 2009), the following table summarizes the number of reportable accidents and the calculated accident rates for the corridor including intersections for each adjacent roadway.

Locations experiencing above state or county wide accident rates are highlighted in red. The Inner Loop expressway (Monroe to Charlotte) is experiencing accident occurrences below the statewide average rates. Each of the adjacent corridors is further assessed below.

One Team. Infinite Solutions.

ACCIDENT RATES

Intersection	Number of Accidents	State/County Rate	Actual Rate	
Intersection Rate (excludes midblock accidents)				
Pitkin Street @ <i>East Ave</i>	8	0.34 / 0.22	0.44	ACC/MEV
Pitkin Street @ <i>Broad Street</i>	4	0.34 / 0.22	0.66	ACC/MEV
Pitkin Street @ <i>Monroe/Chestnut</i>	7	0.34 / 0.22	0.26	ACC/MEV
Union Street @ <i>East Ave</i>	17	0.34 / 0.22	1.13	ACC/MEV
Union Street @ <i>Broad St</i>	3	0.19 / 0.22	0.71	ACC/MEV
Monroe Avenue @ <i>Howell St.</i>	5	0.34 / 0.22	0.34	ACC/MEV
Link Rate				
Inner Loop - 940T <i>Monroe-Charlotte</i>	26	2.72	2.15	ACC/MVM

NOTE: accident rate calculations include "reportable" accidents only.

Pitkin Street corridor – 14 accidents occurred over the 38-month period. There were 5(36%) rear-end accidents, 5(36%) right angle, 1(8%) right turn, 1(8%) overtaking, 1(8%) pedestrian, 1(8%) overtaking, 1(8%) unknown accident. Ninety three percent (or 13) of the accidents involved property damage only, with 64% occurring during daylight hours, and with 64% occurring on dry pavement conditions. The East Avenue and Broad Street intersections with Pitkin Street are experiencing accident rates above the state/county wide average rates. Review of the accidents occurring at either intersection does not show a predominant accident pattern.

Union Street corridor – 33 accidents (reportable and non-re-portable) occurred over a 38-month period. There were 13(37%) right angle, 4(11%) rear-end, 4(11%) fixed object, 3(9%) right turn, and 3(8%) unknown, 2(6%) left turn, 2(6%) backing up, and 2(6%) sideswipe accidents. Eighty eight percent (or 29) of the accidents involved property damage only and occurred throughout the daylight/evening hours with 74% occurring on dry pavement conditions. Further review of the actual reports suggests that the rear end accidents were primarily a result of following too closely. The East Avenue intersection with Union Street is experiencing accident occurrences above the state/county wide average rate.

East Avenue Intersection – of the 17 accidents that occurred at this intersection, 12(71%) were right angle accidents. These accidents are attributable to driver inattention and possible visibility constraints related to the bridge railing over the Inner Loop and the building on the southeast quadrant.

Safety Benefits Evaluation

Because the existing accident rates are generally near or below the statewide average (except intersections), it is reasonable to assume the total number of accidents will not go down substantially. Any projected reduction in traffic volume on the combined Inner Loop/Union Street/Pitkin Street corridors due to this project will result in a corresponding increase in volume on the nearby city street network. As such, although accidents may decrease on the project corridor (due to lower volumes), there will most likely be an offsetting increase elsewhere on the nearby city street network.

The project will however reduce the rate of severe accidents (i.e. personal injury crashes) due primarily to a proposed reduction of the speed limit from a high speed 45 mph to a low-speed city street speed of 30 mph. The elimination of numerous non-standard and non-confirming roadway features on the Inner Loop expressway will also help reduce the severity of accidents.

A total of 40 crashes occurred over a three year period along the existing high speed, non-standard expressway section of the Inner Loop. Of the 40 accidents, 13 (or 32.5%) involved personal injuries. By comparison, the low-speed Union and Pitkin Street segments experienced much lower rates of injury accidents during the same study period, with rates of 12% and 7%, respectively. The average rate of injury accidents of the two city streets is therefore 9.5%.

Considering that the project will combine the expressway segment with Union Street, thus creating a single standardized low-speed city street/boulevard, the expected resultant effect will be a reduction of severe accidents related to the existing high speed facility to a similar rate that exists on low-speed Union Street and Pitkin Streets. A reduction from 32.5% (13 injury crashes) to 9.5% (4 injury crashes), is therefore expected. Since the total number of accidents will remain unchanged, the eliminated injury crashes will convert to simple property damage (only) crashes.

Considering there will be no change to the speed limit, accident rates and level of severity on Union and Pitkin Streets are expected to remain unchanged within the project limits.

The quantifiable safety benefits can be derived by first calculating the projected reduction in injury accidents as a direct result of the proposed improvements. As described above, the expected project effect on accident severity is a projected reduction from 13 injury accidents to 4 injury and 9 additional property damage (only) accidents, thus emulating the current rate of injury accidents on the adjacent city streets.

Accident costs for the various types of reported accidents (i.e. Property Damage Only, Injury and Fatalities) were then applied to both the existing accident rates and severity and future rates and severity. Accident costs were derived from TIGER Benefit-Cost Analysis (BCA) Resource Guide, updated on May 15, 2013.

Finally, given consideration to the unique nature of this project, NYSDOT Safety Benefits Evaluation Form TE 164 was used but slightly modified (for clarity purposes) to quantify the monetary benefits of reducing accident severity.

Although not always resulting in monetary benefits, the following considerations for the three corridors were made:

Pitkin Street – Pitkin Street will most likely be converted into an alley way to provide access to adjacent existing and potential new developments in the area only. Major signalized intersections at East Avenue and at Broad Street will be eliminated and no connections south/west of Broad Street is anticipated. With these changes, it was assumed that all the accident patterns observed would be reduced on Pitkin Street. However, it is accepted that the reduction of accidents will most likely be offset by additional accidents on adjacent streets and intersections.

Inner Loop & Union Street – For purposes of estimating safety benefits, although both roadways will ultimately be combined into a single thoroughfare, the statistical data for both the Inner Loop and Union Street were kept separate, as it is expected that there will be little, if any, significant change to the rate and/or level of severity of accidents on Union Street. Union Street will continue to function as it does today, as a low-speed city street. Future accidents on the reconfigured Inner Loop however are expected to emulate those rates and level of severity that exist on Union and Pitkin Streets.

The proposed improvement includes bringing the current Inner Loop (limited access, high speed, expressway) to an at grade configuration along the Union Street corridor. Although Union Street will be converted to a two-way arterial, all entrance/exit ramps will be eliminated and improved intersection geometry with turn lanes, medians, and potential roundabouts along the new Union Street corridor are included. As previously discussed, accident severity reduction includes only the expressway injury-related accidents. A reduction from 13 injury crashes to 4 injury and 9 additional property damage (only) crashes is expected. Based on average accident costs, an Estimated **Annual Safety Benefit of \$460,008** is anticipated.

STANTEC CONSULTING SERVICES INC.

Attachments: Safety Benefits Evaluation Form

STATE OF NEW YORK
DEPARTMENT OF TRANSPORTATION
TRAFFIC AND SAFETY DIVISION
**SAFETY BENEFITS
EVALUATION FORM**

TRAFFIC & SAFETY IDENTIFICATION NUMBER									
EVALUATION OF ALTERNATE NO:									
STUDY PERIOD		From		To		No. of Yrs.			
		1/1/2005		3/7/2008		3.16			

LOCATION	Route No. or Street Name		State Highway No.		From or At Reference Marker				
	Inner Loop (Howell/Monroe to Charlotte St)		Rt. 940T		Howell Street Off - Ramp				
	At Intersection with (if applicable)		State Highway No.		To Reference Marker				
					Charlotte Street Off - Ramp				

PROJECT DATA	PROPOSED IMPROVEMENT:									
	The proposed improvements include the conversion of an existing high speed Inner Loop x-way, with adjacent parallel low speed city streets, back to the original street grid using sustainable low speed street network principles.									
Present AADT: <u>6840</u> Future AADT: <u>6840</u> Volume Correction Factor (VCF): <u>1</u>										

REDUCTION CALCULATION	METHOD I (From Reduction Factor Table)									
	Average Reduction Factor <u> </u> %									
	METHOD II (Engineering Analysis)					METHOD III (For General Upgradings)				
	a. Total Accidents:		<u>40</u>		a. Existing Accident Rate:		<u> </u>			
b. Accidents Reduced:		<u>0</u> (but severity reduced)		b. Future Accident Rate:		<u> </u>				
c. Calculated RF (b/a):		<u>0%</u>		c. Difference (a-b):		<u>0</u>				
				d. Calculated RF (c/a):		<u>#DIV/0!</u> %				

BRIEFLY EXPLAIN HOW EXPECTED REDUCTION WAS DERIVED:									
By converting a high speed x-way to a low speed boulevard, the effect will be a reduction of the severity of accident types. 32.5% of the prior-years' accidents that occurred along the x-way resulted in personal injuries while the two adjacent city streets, Pitkin and Union, experienced 7% and 12% injuries, respectively. By eliminating the the high speed expressway component, the severity of future accidents is expected to emulate those along the existing low speed city streets, estimated to be the average of the two, or 9.5%.									

PRE-PROJECT COST PER ACCIDENT CALCULATION					POST-PROJECT COST PER ACCIDENT CALCULATION				
TYPE	NO. ACC.		COST/ACC	ACC. COST	TYPE	NO. ACC.		COST/ACC	ACC. COST
Fatal	0	x	9100000	= 0	Fatal	0	x	9100000	= 0
Injury	13.0	x	164720	= 2,141,360	Injury	4.0	x	164720	= 658,880
F & I	0.0	x	4632360	= 0	F & I	0.0	x	4632360	= 0
PDO	27.0	x	3206	= 86,562	PDO	36.0	x	3206	= 115,416
Total	40			\$ 2,227,922	Total	40			\$ 774,296
BEFORE COST/ACC (Tot. Acc. Cost/ Tot. Acc.) <u>\$ 55,698</u>					BEFORE COST/ACC (Tot. Acc. Cost/ Tot. Acc.) <u>\$ 19,357</u>				

SAFETY BENEFITS	A. ESTIMATED ANNUAL ACCIDENT COST WITH NO IMPROVEMENT (Pre-Project):									
	ACC/YR	<u>12.66</u>	X	VCF	<u>1</u>	X	BEFORE COST/ACCIDENT	<u>\$55,698</u>	=	<u>\$705,038.61</u>
	B. ESTIMATED ANNUAL ACCIDENT COST WITH PROPOSED IMPROVEMENT (Post-Project):									
	ACC/YR	<u>12.66</u>	X	VCF	<u>1</u>	X	(1.00- <u>0</u> RF)	X	AVG. COST/ACC.	<u>\$ 19,357</u>
ESTIMATED ANNUAL SAFETY BENEFITS (A-B) = \$ <u>460,008</u>										

Memo



Stantec

Inner Loop – Accident History

Date: December 17, 2008
Revised April 24, 2009
To: Bill Holthoff, Stantec
From: Paula Benway, Stantec

Inner Loop Accident Data

The most recent available accident information was obtained for the section of the inner loop from the Rt. 490 interchange in the east to north of the East Main Street interchange. Information available represents a 39-month period between January 1, 2005 and March 7, 2008. The accident history identified a total of 49 accidents occurred along the Inner Loop in this area. The reportable accidents accounted for 30 (61%) of the total accidents and the non-reportable accidents accounted for 19 (39%) of the total accidents. The following list summarizes the types and number of reportable accidents. The rest of the assessment (analysis, rates and potential corrective action) will be related to the reportable type accidents that occurred in the corridor.

- Fixed Object – 17 (57%)
- Sideswipe – 5 (17%)
- Rear End – 4 (13%)
- Right Angle – 1 (3%)
- Head-on – 1 (3%)
- Unknown – 2 (7%)

The accident severity included 13 injuries (43%) and 17 (57%) property damage only. Fifty three percent of all accidents occurred during evening hours with 55% occurring on dry pavement conditions. Seventy percent of the vehicles involved were traveling in a westerly direction. As indicated above, 57% of the accidents involved collision with fixed objects (guide rail, curbing, abutment, debris). Only four of the 30 accidents occurred at a merge/diverge ramp location, with the majority of accidents occurring main line along the horizontal curve between East Main Street and East Avenue. The accident rate for the corridor was calculated and compared to statewide accident rates for Principal Arterial expressways. The current accident rate is 2.48 accidents per million vehicle miles (acc/mvm) which is below the statewide average of 2.72 acc/mvm.

Collision diagrams, detailed accident history, and rate calculations are attached.

Extended Study Area

An extended study area was also reviewed that included at grade adjacent corridors including: East Main Street, Monroe Avenue/Chestnut, Pitkin Street, Union Street, and a portion of Interstate 490. The following table summarizes the number of reportable accidents and the calculated accident rates for the corridor and intersections for each of these adjacent roadways.

One Team. Infinite Solutions.

ACCIDENT RATES

Intersection	Number of Accidents	State/County Rate	Actual Rate	
Intersection Rate (excludes midblock accidents)				
East Main Street @ <i>University/Pitkin</i>	7	0.26 / 0.46	0.33	ACC/MEV
East Main Street @ <i>Inner Loop/University</i>	40	0.26 / 0.46	0.96	ACC/MEV
East Main Street @ <i>Union Street</i>	23	0.26 / 0.46	0.83	ACC/MEV
Pitkin Street @ <i>East Ave</i>	8	0.34 / 0.22	0.44	ACC/MEV
Pitkin Street @ <i>Broad Street</i>	4	0.34 / 0.22	0.66	ACC/MEV
Union Street @ <i>University Ave</i>	14	0.34 / 0.22	0.65	ACC/MEV
Union Street @ <i>East Ave</i>	17	0.34 / 0.22	1.13	ACC/MEV
Union Street @ <i>Broad St</i>	3	0.19 / 0.22	0.71	ACC/MEV
Monroe Avenue @ <i>Inner Loop/ Pitkin St.</i>	7	0.34 / 0.22	0.26	ACC/MEV
Monroe Avenue @ <i>Howell St.</i>	5	0.34 / 0.22	0.34	ACC/MEV
Monroe Avenue @ <i>South Union St.</i>	20	0.34 / 0.22	1.12	ACC/MEV
Link Rate				
Inner Loop - 940T				
<i>Rt. 490-E. Main St.</i>	30	2.72	2.48	ACC/MVM
I-490				
<i>W.of River -E. of Clinton</i>	47	2.72	1.08	ACC/MVM

Locations experiencing above state or county wide accident rates are highlighted in red. Both sections of the expressway system (Inner Loop and I-490) are experiencing accident occurrences below the average rates. Each of the adjacent corridors is further assessed below.

Corridor Breakdown

East Main Street corridor– 80 accidents occurred over a 41-month period from University Avenue in the west to Union Street in the east. There were 27(35%) rear-end accidents, 18(23%) sideswipe, 15(20%) right angle, 6(8%) overtaking, 7(8%) left turn, 2(2%) fixed object, 1 backing, 1 bicycle and 2(2%) unknown accidents that occurred at the three intersections along East Main Street. The severity of these accidents included 15(19%) injuries and 65(81%) property damage only. Seventy four percent of all accidents occurred during daylight hours with 70% occurring on dry pavement conditions. The East Main Street intersections with the Inner Loop/University Avenue and the Union Street intersection are experiencing accident rates above the state/county wide average rates. The Monroe County Department of Transportation investigated East Main Street east of Union Street in July 2006 as part of a PIL. The investigation resulted in traffic signal

timing changes that improved the progression on East Main Street.

Inner Loop/University Intersection – of the 40 accidents that occurred at this intersection, 13(33%) were vehicles sideswiping/overtaking in the left turn lanes on the Inner Loop ramp approach and the University Avenue approach. These accidents are attributable to driver confusion, inattention to turning maneuvers, unsafe lane change or possible narrow lane widths. The other major accident type occurring at this intersection is rear-end accidents 13 (33%) of the total; driver inattention is noted as a contributing factor.

North Union Street Intersection – of the 23 accidents that occurred at this intersection, 8(35%) were vehicles sideswiping/overtaking on the North Union Street northbound approach and the East Main Street westbound approach. These accidents are attributable to driver confusion, inattention to turning maneuvers, unsafe lane changes or possible narrow lane widths. The other major accident type occurring at this intersection is rear-end accidents 8 (35%) of the total; driver inattention is noted as a contributing factor.

Monroe Avenue/Chestnut corridor – 50 accidents occurred over a 41-month period along the section from Chestnut north of Inner Loop to South Union Street intersection to the south. There were 20 (40%) rear-end accidents, 11(22%) right angle, 6(12%) sideswipe, 4(8%) right turn, 3(6%) fixed object, 2(4%) left turn, 1(2%) head on, 1(2%) bicycle, 1(2%) driveway and 1 unknown accident. The severity of these accidents included 66% property damage only, 32% resulted in injuries and one fatality (motorcycle) did occur. Sixty two percent of the accidents occurred during daylight hours, and with 68% occurring on dry pavement conditions. The South Union intersection with Monroe Avenue is experiencing an accident rate above the state/county wide average.

South Union Intersection – of the 20 accidents that occurred at this intersection, 8(40%) were right angle accidents with the South Union approach. These accidents are attributable to driver inattention and visibility constraints. The other major accident type occurring at this intersection is rear-end accidents 7 (35%) of the total; driver inattention is noted as a contributing factor.

Pitkin Street corridor – 12 accidents occurred over a 29-month period. There were 5(42%) rear-end accidents, 3(25%) right angle, 1(8%) right turn, 1(8%) overtaking, 1(8%), pedestrian, 1(8%) unknown accident. Ninety two percent of the accidents involved property damage only, with 58% occurring during daylight hours, and with 58% occurring on dry pavement conditions. The East Avenue and Broad Street intersections with Pitkin Street are experiencing accident rates above the state/county wide average rates. Review of the accidents occurring at either intersection does not show a predominant accident pattern.

Union Street corridor – 61 accidents occurred over a 39-month period. There were 21(34%) right angle, 12(20%) rear-end, 10(16%) left turn, 4(6%) backing up, 3(5%) sideswipe, 3(5%) fixed object, 3(5%) right turn, 3(5%) unknown, 1 driveway and 1 overtaking accident. Eighty four percent of the accidents involved property damage only, and evenly distributed during daylight/evening hours, and with 74% occurred on dry pavement conditions. Further review of the actual reports suggests that the rear end accidents were primarily a result of following too closely. The University Avenue and East Avenue intersections with Union Street are experiencing accident rates above the state/county wide average rates.

University Avenue Intersection – of the 14 accidents that occurred at this intersection,

8(57%) were right angle accidents. These accidents are attributable to driver inattention and possible visibility constraints.

East Avenue Intersection – of the 17 accidents that occurred at this intersection, 12(71%) were right angle accidents. These accidents are attributable to driver inattention and possible visibility constraints related to bridge railing over the Inner Loop and building on the southeast quadrant.

I-490 corridor – 47 accidents occurred over a 33-month period. The 47 accidents consisted of 18(38%) fixed object accidents, 16(34%) rear-end, 8(17%) overtaking, 3(6%) unknown, 1 head-on and 1 sideswipe accident. The accident severity included 16(34%) injuries and 31(66%) property damage only. Sixty six percent of the accidents occurred during daylight hours, and with 60% occurring on dry pavement conditions. The majority of fixed object accidents involved unsafe travel speeds for the conditions (wet, construction, grade, or curvature of road). It should be noted that sections of I-490 included in this assessment was under construction during the time represented by this safety assessment. As such, caution should be used in review or interpretation of the findings.

STANTEC CONSULTING SERVICES INC.

Attachments: Accident Rate Calculations, Collision Diagrams, Detailed Accident History

ACCIDENT RATE CALCULATIONS

Project Name: **Inner Loop**
 Date: 12/10/2008

Intersection Rate

(excludes midblock accidents)

East Main Street @ University Ave/Pitkin	$\frac{\begin{array}{l} \# \text{ Accidents} \\ 7 \end{array}}{\begin{array}{l} \text{Vehicles/Day} \\ 16,950 \end{array}} \times \frac{\begin{array}{l} \text{Per Million Entering Vehicles} \\ 1,000,000 \end{array}}{\begin{array}{l} \# \text{ of Years} \\ 3.4 \end{array}} \times \frac{\begin{array}{l} \text{Days/Year} \\ 365 \end{array}}{\begin{array}{l} \text{Days/Year} \\ 365 \end{array}} = \frac{7000000}{21034950} = \boxed{0.33} \text{ ACC/MEV}$	0.26 Statewide Rate 0.46 County Rate
Inner Loop/University	$\frac{\begin{array}{l} \# \text{ Accidents} \\ 40 \end{array}}{\begin{array}{l} \text{Vehicles/Day} \\ 33,450 \end{array}} \times \frac{\begin{array}{l} \text{Per Million Entering Vehicles} \\ 1,000,000 \end{array}}{\begin{array}{l} \# \text{ of Years} \\ 3.4 \end{array}} \times \frac{\begin{array}{l} \text{Days/Year} \\ 365 \end{array}}{\begin{array}{l} \text{Days/Year} \\ 365 \end{array}} = \frac{40000000}{41511450} = \boxed{0.96} \text{ ACC/MEV}$	0.26 Statewide Rate 0.46 County Rate
Union Street	$\frac{\begin{array}{l} \# \text{ Accidents} \\ 23 \end{array}}{\begin{array}{l} \text{Vehicles/Day} \\ 22,350 \end{array}} \times \frac{\begin{array}{l} \text{Per Million Entering Vehicles} \\ 1,000,000 \end{array}}{\begin{array}{l} \# \text{ of Years} \\ 3.4 \end{array}} \times \frac{\begin{array}{l} \text{Days/Year} \\ 365 \end{array}}{\begin{array}{l} \text{Days/Year} \\ 365 \end{array}} = \frac{23000000}{27736350} = \boxed{0.83} \text{ ACC/MEV}$	0.26 Statewide Rate 0.46 County Rate
Pitkin Street @ East Ave	$\frac{\begin{array}{l} \# \text{ Accidents} \\ 8 \end{array}}{\begin{array}{l} \text{Vehicles/Day} \\ 16,450 \end{array}} \times \frac{\begin{array}{l} \text{Per Million Entering Vehicles} \\ 1,000,000 \end{array}}{\begin{array}{l} \# \text{ of Years} \\ 3 \end{array}} \times \frac{\begin{array}{l} \text{Days/Year} \\ 365 \end{array}}{\begin{array}{l} \text{Days/Year} \\ 365 \end{array}} = \frac{8000000}{18012750} = \boxed{0.44} \text{ ACC/MEV}$	0.34 Statewide Rate 0.22 County Rate
Broad Street	$\frac{\begin{array}{l} \# \text{ Accidents} \\ 4 \end{array}}{\begin{array}{l} \text{Vehicles/Day} \\ 5,550 \end{array}} \times \frac{\begin{array}{l} \text{Per Million Entering Vehicles} \\ 1,000,000 \end{array}}{\begin{array}{l} \# \text{ of Years} \\ 3 \end{array}} \times \frac{\begin{array}{l} \text{Days/Year} \\ 365 \end{array}}{\begin{array}{l} \text{Days/Year} \\ 365 \end{array}} = \frac{4000000}{6077250} = \boxed{0.66} \text{ ACC/MEV}$	0.34 Statewide Rate 0.22 County Rate
Union Street @ University Ave	$\frac{\begin{array}{l} \# \text{ Accidents} \\ 14 \end{array}}{\begin{array}{l} \text{Vehicles/Day} \\ 19,600 \end{array}} \times \frac{\begin{array}{l} \text{Per Million Entering Vehicles} \\ 1,000,000 \end{array}}{\begin{array}{l} \# \text{ of Years} \\ 3 \end{array}} \times \frac{\begin{array}{l} \text{Days/Year} \\ 365 \end{array}}{\begin{array}{l} \text{Days/Year} \\ 365 \end{array}} = \frac{14000000}{21462000} = \boxed{0.65} \text{ ACC/MEV}$	0.34 Statewide Rate 0.22 County Rate
East Ave	$\frac{\begin{array}{l} \# \text{ Accidents} \\ 17 \end{array}}{\begin{array}{l} \text{Vehicles/Day} \\ 13,700 \end{array}} \times \frac{\begin{array}{l} \text{Per Million Entering Vehicles} \\ 1,000,000 \end{array}}{\begin{array}{l} \# \text{ of Years} \\ 3 \end{array}} \times \frac{\begin{array}{l} \text{Days/Year} \\ 365 \end{array}}{\begin{array}{l} \text{Days/Year} \\ 365 \end{array}} = \frac{17000000}{15001500} = \boxed{1.13} \text{ ACC/MEV}$	0.34 Statewide Rate 0.22 County Rate
Broad St	$\frac{\begin{array}{l} \# \text{ Accidents} \\ 3 \end{array}}{\begin{array}{l} \text{Vehicles/Day} \\ 3,850 \end{array}} \times \frac{\begin{array}{l} \text{Per Million Entering Vehicles} \\ 1,000,000 \end{array}}{\begin{array}{l} \# \text{ of Years} \\ 3 \end{array}} \times \frac{\begin{array}{l} \text{Days/Year} \\ 365 \end{array}}{\begin{array}{l} \text{Days/Year} \\ 365 \end{array}} = \frac{3000000}{4215750} = \boxed{0.71} \text{ ACC/MEV}$	0.19 Statewide Rate 0.22 County Rate
Monroe Avenue @ Inner Loop/ Pitkin St.	$\frac{\begin{array}{l} \# \text{ Accidents} \\ 7 \end{array}}{\begin{array}{l} \text{Vehicles/Day} \\ 21,310 \end{array}} \times \frac{\begin{array}{l} \text{Per Million Entering Vehicles} \\ 1,000,000 \end{array}}{\begin{array}{l} \# \text{ of Years} \\ 3.4 \end{array}} \times \frac{\begin{array}{l} \text{Days/Year} \\ 365 \end{array}}{\begin{array}{l} \text{Days/Year} \\ 365 \end{array}} = \frac{7000000}{26445710} = \boxed{0.26} \text{ ACC/MEV}$	0.34 Statewide Rate 0.22 County Rate
Howell St.	$\frac{\begin{array}{l} \# \text{ Accidents} \\ 5 \end{array}}{\begin{array}{l} \text{Vehicles/Day} \\ 11,750 \end{array}} \times \frac{\begin{array}{l} \text{Per Million Entering Vehicles} \\ 1,000,000 \end{array}}{\begin{array}{l} \# \text{ of Years} \\ 3.4 \end{array}} \times \frac{\begin{array}{l} \text{Days/Year} \\ 365 \end{array}}{\begin{array}{l} \text{Days/Year} \\ 365 \end{array}} = \frac{5000000}{14581750} = \boxed{0.34} \text{ ACC/MEV}$	0.34 Statewide Rate 0.22 County Rate
South Union St.	$\frac{\begin{array}{l} \# \text{ Accidents} \\ 20 \end{array}}{\begin{array}{l} \text{Vehicles/Day} \\ 14,400 \end{array}} \times \frac{\begin{array}{l} \text{Per Million Entering Vehicles} \\ 1,000,000 \end{array}}{\begin{array}{l} \# \text{ of Years} \\ 3.4 \end{array}} \times \frac{\begin{array}{l} \text{Days/Year} \\ 365 \end{array}}{\begin{array}{l} \text{Days/Year} \\ 365 \end{array}} = \frac{20000000}{17870400} = \boxed{1.12} \text{ ACC/MEV}$	0.34 Statewide Rate 0.46 County Rate

DETAILS OF ACCIDENT HISTORY
 Sear-Brown Group

Diagram: Inner Loop
 County of Monroe
 Town of City of Rochester

Street Name: Inner Loop (Rt. 940T)
Route Number:
Location: Inner Loop
Milepost: E. Main St To: I-490
Date of Report: 1/13/200

P.I.N. _____
Case No. _____
File _____
By _____
Page Number 1

PERIOD STUDIED
 From 1/1/2005
 To: 3/7/2008
 39 Months

(1) No.	(2) Date	(3) Time	(4)	(5)	(6)	(7)	(8)	(9)	(10) Apparent Contributing Factors	(11) Acc. Type	(12) Description		
6001	6/5/2006	16:15	V	S	L	R	S	1	2	1	17,13	Side	V2 STRUCK V1 AT EXIT LANE FOR MONROE AVE. (7) Failure to Yield Right of Way (13) Passing or Lane Usage Improper
6004	12/16/2007	5:43	Inj	4	4	4	2	4	2	12,19	12,19	FixO	V1 STRUCK GUIDE RAIL, THEN STRUCK GUIDE RAIL WITH LEFT SIDE (2) Alcohol Involvement (19) Unsafe Speed
6005	2/9/2007	0:29	Inj	4	4	4	4	4	4	4,66	4,66	FixO	V1 SPUN OUT OF CONTROL, HITTING WALL & FLIPPING ONTO IT'S ROOF. (2) Alcohol Involvement (66) Pavement Slippery
6006	3/7/2008	21:30	Inj	4	6	4	4	6	4	4,66	4,66	FixO	V1 HIT ICY PATCH ON THE ROAD , SPUN OUT & HIT GUARD RAIL. (66) Pavement Slippery
6009	7/5/2007	1:00	PDO	4	1	1	1	1	1	1,2,13	1,2,13	FixO	V1 LEFT IT'S LANE & STRUCK GUARD RAIL (2) Alcohol Involvement (13) Passing or Lane Usage Improper
6011	6/10/2005	16:05	PDO	1	2	1	1	1	1	1,13	1,13	Side	V1 PASS V2, LOST CONTROL STRIKING V2 (13) Passing or Lane Usage Improper
6012	2/8/2006	16:16	Inj	1	1	1	1	1	1	29	29	REnd	Acc. Main St to Acc. E. Ave (9) Following Too Closely
6013	11/16/2006	18:29	PDO	4	5	2	3	6	6	3,66	3,66	FixO	Acc. Main St to Acc. E. Ave (66) Pavement Slippery
6016	6/2/2007	12:05	Inj	1	1	1	1	1	1	14	14	RANG	rmp from Main St (4) Driver Inattention
6017	9/22/2006	7:49	PDO	1	5	1	1	1	1	1,19,13	1,19,13	FixO	Acc. Main St to Acc. E. Ave (19) Unsafe Speed (13) Passing or Lane Usage Improper
6018	4/8/2007	14:23	Inj	1	5	1	1	1	1	19	19	REnd	Acc. Main St to Acc. E. Ave (9) Following Too Closely
6019	4/4/2005	22:40	Inj	4	1	1	1	2	2	20,19	20,19	Side	Acc. Main St to Acc. E. Ave (20) Unsafe Lane Changing (19) Unsafe Speed
6020	10/19/2006	19:00	Inj	4	4	2	3	19	66	66	66	FixO	Acc. Main St to Acc. E. Ave (19) Unsafe Speed (66) Pavement Slippery
6021	1/24/2007	1:40	Inj	4	5	2	2	13	13	13	13	FixO	Acc. Main St to Acc. E. Ave (13) Passing or Lane Usage Improper

DETAILS OF ACCIDENT HISTORY
 Sear-Brown Group

Diagram: Inner Loop
 County of Monroe
 Town of City of Rochester

Street Name: Inner Loop (Rt. 940T)
Route Number:
Location: Inner Loop
Milepost: E. Main St To: I-490
Date of Report: 1/13/200

P.I.N.
Case No.
File
By
Page Number 2

PERIOD STUDIED
 From 1/1/2005
 To: 3/7/2008
 39 Months

(1) No.	(2) Date	(3) Time	(4) V	(5) S	(6) L	(7) R	(8) S	(9) U	(10) Apparent Contributing Factors	(11) Acc. Type	(12) Description
6022	1/26/2007	23:35		PDO	4	5	4	2	19,66	FixO	Acc. Main St to Acc. E. Ave (19) Unsafe Speed (66) Pavement Slippery
6023	2/15/2007	8:02		PDO	1	5	4	1	19,66	FixO	Acc. Main St to Acc. E. Ave (19) Unsafe Speed (66) Pavement Slippery
6024	2/15/2007	9:45		Inj	1	1	4	1	19,66	REnd	Acc. Main St to Acc. E. Ave (19) Unsafe Speed (66) Pavement Slippery
6025	7/5/2007	0:10		PDO	4	1	1	1,2,13		FixO	Acc. Main St to Acc. E. Ave (2) Alcohol Involvement (13) Passing or Lane Usage Improper
6026	10/19/2006	18:22		PDO	4	1	2	3	19,64	REnd	Main St Ramp (19) Unsafe Speed (64) Obstruction/Debris
6027	1/20/2005	8:04		PDO	1	1	4	4	19,66	FixO	Access E. Ave to Ramp Chapman St. (19) Unsafe Speed (66) Pavement Slippery
6028	2/16/2007	4:30		PDO	4	1	4	4	66	Side	Access E. Ave to Ramp Chapman St. (66) Pavement Slippery
6029	6/10/2005	16:05		PDO	1	1	1	1	13	Side	Access Ramp Chapman St to Access Buena St (13) Passing or Lane Usage Improper
6030	1/1/2005	4:24		Inj	4	1	1	2		FixO	Slip Ramp from Pitkin (2) Alcohol Involvement
6032	5/26/2007	11:25		PDO	1	6	1	1	19,47	FixO	Ramp Chapman St to Access Buena St (19) Unsafe Speed (47) Tire Failure/Inadequate
6033	12/20/2006	6:45		PDO	2	1	1	1	64	Unkn	Ramp to Buena St - V1 hit debris in the road (64) Obstruction/Debris
6034	7/27/2007	11:17		PDO	4	5	1	1	2,20	FixO	I-490East Ramp-crashed into attenuator at diverge pt. (2) Alcohol Involvement (20) Unsafe Lane Changing
6038	9/13/2006	22:45	1	PDO	4	1			2,60	Unkn	I-490East Ramp - truck on fire in construction zone (60) Other Vehicular
6039	5/26/2007	11:25	1	PDO	1	6	1	1	19,47	FixO	South overpass - going straight, hit curb, unsafe speed (19) Unsafe Speed (47) Tire Failure/Inadequate

P.I.N. _____
Case No. _____
File _____
By _____
Page Number 3

Street Name: Inner Loop (Rt. 940T)
Route Number: _____
Location: Inner Loop
Milepost: E. Main St To: I-490
Date of Report: 1/13/200

Diagram: Inner Loop
 County of Monroe
 Town of City of Rochester

DETAILS OF ACCIDENT HISTORY
 Sear-Brown Group

PERIOD STUDIED
 From 1/1/2005
 To: 3/7/2008
 39 Months

(1) No.	(2) Date	(3) Time	(4) (5) V e h i c l e s	(6) (7) (8) (9) R o a d C o n d i t i o n s	(10) Apparent Contributing Factors	(11) H-On	(12) Description
6040	1/5/2008	2:18	2 Inj	4 1 1	217,20	H-On	E. Clinton Overpass- wrong way on Inner loop (17) Traffic Control Disregarded (20) Unsafe Lane Changing
6041	1/11/2008	6:31	1 Inj	2 4 2	319,66	FixO	W of Clinton overpass - unsafe speed, pavement slippery (19) Unsafe Speed (66) Pavement Slippery

Location: Inner Loop

Town: City of Rochester

13-Jan-09

County: Monroe

Milepost: E. Main St

To: 1-490

Time of Day	No. of Accidents	% of Total	Direction	# Veh	% of Total	Direction	# Veh	% of Total
6 AM - 10 AM	6	20	North:	0	0	NorthEast:	0	0
10:00 AM - 4 PM	5	17	South:	1	2.3	NorthWest:	1	2.3
4 PM - 7 PM	6	20	East:	8	19	SouthEast:	3	7
7 PM - 12 MID	5	17	West:	30	70	SouthWest:	0	0
12 MID - 6 AM	8	27	Unknown:	0	0			
Unspecified	0	0				Total	43	
Total	30							

Weather	No. of Accidents	% of Total	Acc. Type	# Veh	% of Total	Acc. Type	# Veh	% of Total
Clear:	15	50	Sideswipe:	5	17	Bicycle:	0	0
Cloudy:	7	23	Rear End:	4	13	Right Turn:	0	0
Fog:	0	0	Right Angle:	1	3.3	Driveway:	0	0
Rain:	4	13	Left Turn:	0	0	Backing:	0	0
Sleet:	0	0	Pedestrian:	0	0	Overtaking:	0	0
Snow:	4	13	Fixed Object:	17	57	Unknown:	2	6.7
Unknown:	0	0	Head on:	1	3.3			
Total	30					Total	30	

Pavement	No. of Accidents	% of Total	Accident Severity	No. of Accidents	% of Total
Dry:	16	55	Fatal:	0	0
Muddy:	0	0	Non-Fatal Injury:	13	43
Other:	0	0	Property damage only:	17	57
Slush:	0	0	Non-reportable:	0	0
Snow/Ice:	7	24	Total	30	
Wet:	6	21			
Unknown:	0	0			
Total	29				

Type of Vehicle	No. of Accidents	% of Total
Passenger Cars:	43	98
Commercial Vehicles:	1	2.3
Total	44	

Time of Year	No. of Accidents	% of Total	Light Condition	No. of Accidents	% of Total
Winter (Dec-Feb)	13	43	Dark Road-Lighted:	16	53
Spring (Mar-May)	5	17	Dark Road-Unlighted:	0	0
Summer (Jun-Aug)	7	23	Dawn:	2	6.7
Fall (Sep-Nov)	5	17	Daylight:	12	40
Total	30		Dusk:	0	0
			Unknown:	0	0
			Total	30	

DETAILS OF ACCIDENT HISTORY
 Sear-Brown Group

Diagram: East Main
 County of Monroe
 Town of City of Rochester

Street Name: East Main St Corridor
Route Number:
Location: East Main St
Milepost: University Ave To: Union Street
Date of Report: 1/13/200

P.I.N. _____
Case No. _____
File _____
By _____
Page Number 1

PERIOD STUDIED
 From 1/1/2005
 To: 5/10/200
 41 Months

(1) No.	(2) Date	(3) Time	(4) V	(5) S	(6) L	(7) R	(8) S	(9) W	(10) Apparent Contributing Factors	(11) Acc. Type	(12) Description
1019	10/2/2005	11:50	2	PDO	1	1	1	1	14,9	REnd	V1 rear-ended v2 while V2 was stopped in traffic. (4) Driver Inattention (9) Following Too Closely
1021	9/19/2006	12:03	2	PDO	1	1	1	1	18,20	Side	Vehicles turning left in adjoining lanes when v1 veered into v2. (18) Turning Improperly (20) Unsafe Lane Changing
1023	5/23/2007	13:40	2	PDO	1	1	1	1	14	Side	V1 sideswiped the parked v2. (4) Driver Inattention
1033	1/3/2006	16:20	2	PDO	1	1	1	1	269,7	RAng	V1 was allowed to enter by v2 stopped vehicles in Lanes 1 & 2 but entering lane 3 struck V2 (69) View Obstructed/Limited (7) Failure to Yield Right of Way
1034	9/9/2005	13:38	2	PDO	1	1	1	1	19	REnd	(9) Following Too Closely
1035	3/28/2006	9:10	2	Inj	1	2	1	1		Left	V2 in intersection when light turned red. V1 started before V2 cleared
1037	3/2/2007	22:50	2	PDO	4	1	1	1	1, 18	Left	V2 turned into the path of V1 (18) Turning Improperly
1038	6/2/2007	12:05	2	Inj	1	1	1	1	14	RAng	V1 struck v2. (4) Driver Inattention
1039	4/4/2007	8:06	2	PDO	1	1	2	3, 18,13	Side	V2 was sideswiped by v1. (18) Turning Improperly (13) Passing or Lane Usage Improper	
1040	3/6/2007	22:11	2	PDO	4	1	4	2, 7	Left	(7) Failure to Yield Right of Way	
1041	3/26/2006	13:35	2	PDO	1	1	1	1	217	RAng	(17) Traffic Control Disregarded
1042	6/10/2005	13:33	2	PDO	1	1	2	2,4,20	Side	V1 clipped mirror on V2 while going around a third uninvolved vehicle. (4) Driver Inattention (20) Unsafe Lane Changing	
1043	7/6/2005	1:16	2	PDO	1	1	2	3,7,17	RAng	V1 ran red light and struck V2 (7) Failure to Yield Right of Way (17) Traffic Control Disregarded	
1044	9/17/2005	15:29	2	PDO	1	1	1	1, 17	RAng	V1 struck V2 who had failed to stop for the red light. (17) Traffic Control Disregarded	

DETAILS OF ACCIDENT HISTORY
 Sear-Brown Group

Diagram: East Main
 County of Monroe
 Town of City of Rochester

Street Name: East Main St Corridor
Route Number:
Location: East Main St
Milepost: University Ave To: Union Street
Date of Report: 1/13/200

P.I.N.
Case No.
File
By
Page Number 2

PERIOD STUDIED
 From 1/1/2005
 To: 5/10/200
 41 Months

(1) No.	(2) Date	(3) Time	(4) V	(5) S	(6) L	(7) R	(8) S	(9) W	(10) Apparent Contributing Factors	(11) Acc. Type	(12) Description
1045	9/26/2005	21:52	2	PDO	4	4	1	14		Over	(4) Driver Inattention
1046	10/22/2005	20:06	2	Inj	4	1	2	3, 17		RAng	V2 ran a red light and was struck by V1 (17) Traffic Control Disregarded
1047	10/25/2005	7:35	2	Inj	1	1	2	3, 17		RAng	V1 & 2 collided in the intersection and claim both had a green light. (17) Traffic Control Disregarded
1048	12/7/2005	7:45	2	PDO	1	1	2	2, 26		REnd	V2 stopped quickly to avoid vehicle running a red light and was rearended by V2 (26) Reaction to Other Uninvolved Vehicle
1049	12/27/2005	17:12	2	PDO	4	1	1	23		Back	V1 backed into V2 (3) Backing Unsafely
1050	3/27/2006	13:50	2	PDO	1	1	1	14		REnd	(4) Driver Inattention
1051	5/19/2006		3	PDO	1	1	2	3, 17		RAng	V1 ran the red light and was struck by v2 and V3. (17) Traffic Control Disregarded
1052	8/12/2006	9:05		PDO	1	1	1	14		REnd	(4) Driver Inattention
1054	11/2/2006	12:33	2	Inj	1	1	1	1, 17, 17, 7		RAng	V1&2 struck each other. Both drivers claimed that they had a green light. (17) Traffic Control Disregarded (17) Traffic Control Disregarded (7) Failure to Yield Right of Way
1055	1/2/2007	16:06	2	PDO	3	4	1	1, 18		Side	V1 straight in a left turnlane and struck v2, in a left turnlane (18) Turning Improperly
1056	5/3/2007	23:35	2	PDO	4	1	1	2, 2, 20		Side	V1 sideswiped V2 and left the scene (2) Alcohol Involvement (20) Unsafe Lane Changing
1057	5/29/2007	18:15	2	PDO	1	1	1	4		REnd	(4) Driver Inattention
1058	6/28/2007	17:15	2	PDO	1	1	1	14		REnd	(4) Driver Inattention
1059	7/27/2007	17:16	2	PDO	1	1	1	1, 13		Side	Both vehicles were turning left and V2 drifted into v1's lane. (13) Passing or Lane Usage Improper

DETAILS OF ACCIDENT HISTORY
Sear-Brown Group

Diagram: East Main
County of Monroe
Town of City of Rochester

Street Name: East Main St Corridor
Route Number: _____
Location: East Main St
Milepost: University Ave To: Union Street
Date of Report: 1/13/200

P.I.N. _____
Case No. _____
File _____
By _____
Page Number 3

PERIOD STUDIED
From 1/1/2005
To: 5/10/200
41 Months

(1) No.	(2) Date	(3) Time	(4) V	(5) S	(6) L	(7) R	(8) S	(9) W	(10) Apparent Contributing Factors	(11) Acc. Type	(12) Description
1060	8/29/2007	13:59	2	PDO	1	4	1	17,20		Over	V1 U-turn from the right lane and turned in front of V2 (7) Failure to Yield Right of Way (20) Unsafe Lane Changing
1061	4/22/2008	9:00	2	PDO	1	1	1	113		Side	V1 struck V2 with its trailer while they were both turning left (13) Passing or Lane Usage Improper
1062	5/6/2008	16:02	2	PDO	1	1	1	213		Over	(13) Passing or Lane Usage Improper
1063	5/10/2008	13:34	3	PDO	1	1	1	117,4		RAng	V1 tried to make the light and Struck V2&3 (17) Traffic Control Disregarded (4) Driver Inattention
1068	9/8/2006	22:40	2	PDO	4	1	1	213		Over	V1 merge to right lane and struck v2 (13) Passing or Lane Usage Improper
1071	7/2/2007	10:32	2	PDO	1	1	1	19		REnd	(9) Following Too Closely
1072	7/2/2007	10:32	2	PDO	1	1	1	29		REnd	(9) Following Too Closely
1074	11/20/2007	16:30	3	PDO	1	1	1	19		REnd	V3 sudden stop causing V2 to stop. V1 hit v2 which caused V2 of hit V3 (9) Following Too Closely
1075	12/11/2007	13:00	2	PDO	1	1	2	39		REnd	(9) Following Too Closely
1076	1/11/2008	10:02	2	PDO	1	1	2	226		Side	V1 avoiding another vehicle struck v2 who was the right lane. (26) Reaction to Other Uninvolved Vehicle
1077	1/21/2008	19:05	2	PDO	4	1	1	213		Over	V1 drove by V2 and struck V1's mirror. (13) Passing or Lane Usage Improper
1078	2/9/2008	13:35	2	PDO	1	1	4	24,9		REnd	V2 stopped suddenly to let a NYS Trooper by and v1 struck V2 (4) Driver Inattention (9) Following Too Closely
1079	3/7/2008	8:30	3	Inj	1	1	2	269,7,69		Left	V1 struck V2 as it made a left turn causing it to spin out and hit a parked car (69) View Obstructed/Limited (7) Failure to Yield Right of Way (69) View Obstructed/Limited
1081	7/12/2005	8:10	2	PDO	1	1	1	17		Left	(7) Failure to Yield Right of Way

DETAILS OF ACCIDENT HISTORY
Sear-Brown Group

Diagram: East Main
County of Monroe
Town of City of Rochester

Street Name: East Main St Corridor
Route Number:
Location: East Main St
Milepost: University Ave To: Union Street
Date of Report: 1/13/200

P.I.N. _____
Case No. _____
File _____
By _____
Page Number 4

PERIOD STUDIED
From 1/1/2005
To: 5/10/200
41 Months

(1) No.	(2) Date	(3) Time	(4) (5) V e h i c l e	(6) (7) L g h t C o n d	(8) (9) R o a d C o n d	(10) Apparent Contributing Factors	(11) Acc. Type	(12) Description		
1082	9/1/2005	16:06	2 PDO	1	1	1	1	145	Unkn	V1's mirror struck V2 (45) Oversized Vehicle
1084	2/1/2006	14:56	2 PDO	1	1	2	2		REnd	V2 stopped and V1 tried to go around it but clipped the back of V2
1091	8/29/2007	19:27	1 PDO	1	1	1	1		FixO	V1 swerved into pole
1093	2/2/2006	1:09	1 PDO	4	1	1	12		FixO	(2) Alcohol Involvement
1094	1/17/2007		2 PDO	0	1	1	1		REnd	E. Main St. @ Union St
1095	4/14/2006	21:14	2 Inj	4	1	1	1		Unkn	E. Main St. @ Union St.
1097	1/1/2005	18:32	2 Inj	4	1	1	12		RAng	E. Main St. @ Pitkin St (2) Alcohol Involvement
1099	10/25/2005	7:35	2 Inj	1	1	2	3 17,17		RAng	E. Main St. @ Pitkin St (17) Traffic Control Disregarded (17) Traffic Control Disregarded
1100	5/3/2007	23:50	PDO	4	2	1	12,9		REnd	V2 stopped at red light, V1 RE V2, then backed up and sideswiped V2 as it passed it (2) Alcohol Involvement (9) Following Too Closely
1101	2/9/2007	13:45	Inj	1	2	2	29		REnd	V2 stopped at light, V1 RE V2 following too closely (9) Following Too Closely
1102	2/27/2007	9:20	PDO	1	2	1	14		REnd	V2 stopped, V1 lost control, spun around RE V2 (4) Driver Inattention
1103	2/27/2008	9:00	PDO	1	2	4	2 19,66		REnd	V2 stopped, V1 RE V2, unsafe speed, pavement slippery (19) Unsafe Speed (66) Pavement Slippery
1104										Add Accidents under: University Ave + Union St Corridors

Location: East Main St

Town: City of Rochester

12-Jan-09

County: Monroe

Milepost: University Ave

To: Union Street

Time of Day	No. of Accidents	% of Total	Direction	# Veh	% of Total	Direction	# Veh	% of Total
6 AM - 10 AM	11	21	North:	10	9.3	NorthEast:	1	0.9
10:00 AM - 4 PM	19	37	South:	19	18	NorthWest:	1	0.9
4 PM - 7 PM	10	19	East:	21	20	SouthEast:	5	4.7
7 PM - 12 MID	10	19	West:	49	46	SouthWest:	1	0.9
12 MID - 6 AM	2	3.8	Unknown:	0	0			
Unspecified	0	0						
Total	52					Total	107	

Weather	No. of Accidents	% of Total	Acc. Type	# Veh	% of Total	Acc. Type	# Veh	% of Total
Clear:	29	55	Sideswipe:	9	17	Bicycle:	0	0
Cloudy:	17	32	Rear End:	18	33	Right Turn:	0	0
Fog:	0	0	Right Angle:	12	22	Driveway:	0	0
Rain:	7	13	Left Turn:	5	9.3	Backing:	1	1.9
Sleet:	0	0	Pedestrian:	0	0	Overtaking:	5	9.3
Snow:	0	0	Fixed Object:	2	3.7	Unknown:	2	3.7
Unknown:	0	0	Head on:	0	0			
Total	53					Total	54	

Pavement	No. of Accidents	% of Total	Accident Severity	No. of Accidents	% of Total
Dry:	38	70	Fatal:	0	0
Muddy:	0	0	Non-Fatal Injury:	10	19
Other:	0	0	Property damage only:	44	81
Slush:	0	0	Non-reportable:	0	0
Snow/Ice:	3	5.6	Total	54	
Wet:	13	24			
Unknown:	0	0			

Type of Vehicle	No. of Accidents	% of Total
Passenger Cars:	108	100
Commercial Vehicles:	0	0
Total	108	

Time of Year	No. of Accidents	% of Total	Light Condition	No. of Accidents	% of Total
Winter (Dec-Feb)	15	28	Dark Road-Lighted:	12	22
Spring (Mar-May)	16	30	Dark Road-Unlighted:	0	0
Summer (Jun-Aug)	11	20	Dawn:	0	0
Fall (Sep-Nov)	12	22	Daylight:	40	74
Total	54		Dusk:	1	1.9
			Unknown:	1	1.9
			Total	54	

DETAILS OF ACCIDENT HISTORY
 Sear-Brown Group

Diagram: University
 County of Monroe
 Town of City of Rochester

Street Name: University Ave Corridor
Route Number:
Location: University Ave
Milepost: E. Main St To: Union St
Date of Report: 1/13/200

P.I.N. _____
Case No. _____
File _____
By _____
Page Number 1

PERIOD STUDIED
 From 4/2/2005
 To: 4/9/2008
 37 Months

(1) No.	(2) Date	(3) Time	(4)	(5)	(6)	(7)	(8)	(9)	(10) Apparent Contributing Factors	(11) Acc. Type	(12) Description
2002	7/19/2005	13:15	V	S	L	R	S	1	24,20	Side	V1 changed lanes and struck V2 (4) Driver Inattention (20) Unsafe Lane Changing
2003	8/15/2005	12:39	e	h	g	o	u	1	117	REnd	V1 struck V2 after V2 stopped for an emergency vehicle. (17) Traffic Control Disregarded
2004	1/5/2006	13:40	h	v	h	a	r	2	220,13	Over	(20) Unsafe Lane Changing (13) Passing or Lane Usage Improper
2005	1/18/2006	7:57	i	e	t	c	o	2	24	REnd	V1 was cut off and stopped when struck by V2 (4) Driver Inattention
2006	6/21/2006	21:12	s	y	o	n	d	1	17	Over	V1 merged over and struck V2. (7) Failure to Yield Right of Way
2007	7/20/2006	8:49	e	s	o	n	d	1	19	REnd	V2 stopped for pedestrians and V1 rear-ended V 2. (9) Following Too Closely
2008	8/23/2006	14:40	i	e	c	o	n	1	24	Bike	V2 was struck by Bicycle as v2 was turning left (4) Driver Inattention
2009	12/29/2006	23:55	h	i	c	o	n	4	29	REnd	(9) Following Too Closely
2010	2/6/2007	16:13	e	s	o	n	d	1	2, 9	REnd	V1 stopped abruptly and V2 rear-ended it, and V3 rear ended Vehicle 2. (9) Following Too Closely
2011	3/24/2007	18:49	i	n	j	u	r	2	39,4	REnd	(9) Following Too Closely (4) Driver Inattention
2012	4/7/2007	22:20	P	D	O			4	418,4	Over	V1 in the left lane and went straight, v2 turned left from middle lane. V1 hit V2 on the left side. (18) Turning Improperly (4) Driver Inattention
2013	7/9/2006	12:01	P	D	O			1	1, 17	RAng	(17) Traffic Control Disregarded
2014	1/13/2007	10:13	i	n	j	u	r	1	34,17	RAng	(4) Driver Inattention (17) Traffic Control Disregarded
2015	3/3/2007	8:20	P	D	O			1	1, 17	RAng	V2 ran red light and struck V1 (17) Traffic Control Disregarded

DETAILS OF ACCIDENT HISTORY
 Sear-Brown Group

Diagram: University
 County of Monroe
 Town of City of Rochester

Street Name: University Ave Corridor
Route Number:
Location: University Ave
Milepost: E. Main St To: Union St
Date of Report: 1/13/200

P.I.N. _____
Case No. _____
File _____
By _____
Page Number 2

PERIOD STUDIED
 From 4/2/2005
 To: 4/9/2008
 37 Months

(1) No.	(2) Date	(3) Time	(4)	(5)	(6)	(7)	(8)	(9)	(10) Apparent Contributing Factors	(11) Acc. Type	(12) Description
			V	S	L	R	S				
			e	e	g	o	u				
			h	h	h	a	r	W			
			i	v	t	r	f	e			
			c	e	C	C	e	a			
			l	r	o	o	n	t			
			e	i	n	n	d	h			
			s	t	d	d	r	e			
			y								
2016	10/4/2007	14:48	PDO	1	1	1	1	1, 7		Left	(7) Failure to Yield Right of Way
2017	11/3/2007	14:25	Inj	1	1	1	1	1, 20, 7		RAng	(20) Unsafe Lane Changing (7) Failure to Yield Right of Way
2018	12/18/2007	21:47	PDO	4	1	4	1			RAng	
2019	4/9/2008	17:28	PDO	1	1	1	1	17		RAng	(7) Failure to Yield Right of Way
2020	4/2/2005	22:40	Inj	4	1	1	1	1		Left	16648 rmp W. Main St. to NY940T E. Main St
2021	4/4/2007	8:00	PDO	1	1	2	3			Over	16648 rmp W. Main St. to NY940T E. Main St
2022											Add Accidents under: E. Main Street + Union St. Corridors

Location: University Ave

Town: City of Rochester

13-Jan-09

County: Monroe

Milepost: E. Main St

To: Union St

Time of Day	No. of Accidents	% of Total	Direction	# Veh	% of Total	Direction	# Veh	% of Total
6 AM - 10 AM	4	20	North:	25	63	NorthEast:	1	2.5
10:00 AM - 4 PM	8	40	South:	3	7.5	NorthWest:	1	2.5
4 PM - 7 PM	3	15	East:	0	0	SouthEast:	1	2.5
7 PM - 12 MID	5	25	West:	9	23	SouthWest:	0	0
12 MID - 6 AM	0	0	Unknown:	0	0			
Unspecified	0	0				Total	40	
Total	20							

Weather	No. of Accidents	% of Total	Acc. Type	# Veh	% of Total	Acc. Type	# Veh	% of Total
Clear:	10	50	Sideswipe:	1	5	Bicycle:	1	5
Cloudy:	6	30	Rear End:	6	30	Right Turn:	0	0
Fog:	0	0	Right Angle:	6	30	Driveway:	0	0
Rain:	3	15	Left Turn:	2	10	Backing:	0	0
Sleet:	0	0	Pedestrian:	0	0	Overtaking:	4	20
Snow:	1	5	Fixed Object:	0	0	Unknown:	0	0
Unknown:	0	0	Head on:	0	0			
Total	20					Total	20	

Pavement	No. of Accidents	% of Total	Accident Severity	No. of Accidents	% of Total
Dry:	13	65	Fatal:	0	0
Muddy:	0	0	Non-Fatal Injury:	4	20
Other:	0	0	Property damage only:	16	80
Slush:	0	0	Non-reportable:	0	0
Snow/Ice:	1	5	Total	20	
Wet:	6	30			
Unknown:	0	0	Type of Vehicle	No. of Accidents	% of Total
Total	20		Passenger Cars:	41	
			Commercial Vehicles:		
			Total		

Time of Year	No. of Accidents	% of Total	Light Condition	No. of Accidents	% of Total
Winter (Dec-Feb)	6	30	Dark Road-Lighted:	5	25
Spring (Mar-May)	6	30	Dark Road-Unlighted:	0	0
Summer (Jun-Aug)	6	30	Dawn:	0	0
Fall (Sep-Nov)	2	10	Daylight:	15	75
Total	20		Dusk:	0	0
			Unknown:	0	0
			Total	20	

DETAILS OF ACCIDENT HISTORY
Sear-Brown Group

Diagram: East Ave/U
County of Monroe
Town of City of Rochester

Street Name: East Ave Corridor
Route Number:
Location: East Ave/Union St
Milepost: To: Union St.
Date of Report: 1/13/200

P.I.N. _____
Case No. _____
File _____
By _____
Page Number 1

PERIOD STUDIED
From 9/13/200
To: 4/2/2008
32 Months

(1) No.	(2) Date	(3) Time	(4) V	(5) S	(6) L	(7) R	(8) S	(9) U	(10) Apparent Contributing Factors	(11) Acc. Type	(12) Description
3011	8/5/2006	2:38		PDO	4	1	1	1	117	Left	(17) Traffic Control Disregarded
3012	7/21/2006	20:01	2	Inj	1	1	1	1		REnd	V1 stopped abruptly rear ended by V2.
3018	9/13/2005	8:06		PDO	1	1	1	1	14,18	Right	V1 was turning right and turned into V2 (4) Driver Inattention (18) Turning Improperly
3019	9/15/2005	18:03		PDO	1	1	1	1	17,4	Unkn	V3 stopped to let V 1 into traffic, V2 struck V1 making a left (7) Failure to Yield Right of Way (4) Driver Inattention
3020	9/16/2005	22:10		PDO	4	1	1	1	1	RAng	
3021	10/2/2005	4:00		PDO	4	1	1	1	14	RAng	V1 went the wrong way on N. Union, entered intersection and struck V2 (4) Driver Inattention
3022	1/6/2006	22:45		PDO	4	1	4	4		RAng	
3023	6/3/2006	20:59		Inj	4	1	2	3	64,7	Left	(64) Obstruction/Debris (7) Failure to Yield Right of Way
3024	6/5/2006	11:53		Inj	1	1	1	1	1	RAng	
3025	6/7/2006	20:10		PDO	1	1	1	1	1, 17	RAng	(17) Traffic Control Disregarded
3026	8/24/2006	15:43		PDO	1	1	1	1	117	RAng	(17) Traffic Control Disregarded
3027	8/22/2006	16:21		PDO	1	1	1	1	27	Right	(7) Failure to Yield Right of Way
3028	11/20/2006	10:15		PDO	1	1	2	2	17	RAng	(17) Traffic Control Disregarded
3029	12/17/2006	20:14		PDO	4	1	2	2	17	RAng	(17) Traffic Control Disregarded

DETAILS OF ACCIDENT HISTORY
 Sear-Brown Group

Diagram: East Ave/U
 County of Monroe
 Town of City of Rochester

Street Name: East Ave Corridor
Route Number:
Location: East Ave/Union St
Milepost: To: Union St.
Date of Report: 1/13/200

P.I.N. _____
Case No. _____
File _____
By _____
Page Number 2

PERIOD STUDIED
 From 9/13/200
 To: 4/2/2008
 32 Months

(1) No.	(2) Date	(3) Time	(4) V	(5) S	(6) L	(7) R	(8) S	(9) W	(10) Apparent Contributing Factors	(11) Acc. Type	(12) Description
3030	12/23/2006	10:23	6	Inj	1	1	1	2,17		RAng	V1 hit V2, force V2 over the curb , hit parked V3&4 (17) Traffic Control Disregarded
3031	1/4/2007	11:21		Inj	1	1	1	17,7		RAng	V1 & 2 collided and caused V1 to spin out and strike parked V3 & 4. (17) Traffic Control Disregarded (7) Failure to Yield Right of Way
3032	1/12/2007	18:12		PDO	4	1	2	3, 7,69		RAng	(7) Failure to Yield Right of Way (69) View Obstructed/Limited
3033	5/8/2007	11:51		PDO	1	1	1	17,17		RAng	(7) Failure to Yield Right of Way (17) Traffic Control Disregarded
3034	4/2/2008	20:23		PDO	3	1	1	17,69		Left	v2 lt out of drive, view obstructed by parked veh; was struck by V1 westbound (7) Failure to Yield Right of Way (69) View Obstructed/Limited
3035	11/2/2005	21:57		PDO	4	1	1	118		Left	East Ave @ Union St (18) Turning Improperly
3036	4/22/2006	21:57		PDO	4	1	1	1,17		RAng	East Ave @ Union St (17) Traffic Control Disregarded
3037	6/7/2006	20:10		PDO	1	1	1	117		RAng	East Ave @ N. Union St (17) Traffic Control Disregarded
3038											Add accidents found: Pitkin St. corridor

Location: East Ave/Union

Town: City of Rochester

13-Jan-09

County: Monroe

Milepost:

To: Union St.

Time of Day	No. of Accidents	% of Total	Direction	# Veh	% of Total	Direction	# Veh	% of Total
6 AM - 10 AM	1	4.5	North:	17	34	NorthEast:	1	2
10:00 AM - 4 PM	6	27	South:	5	10	NorthWest:	1	2
4 PM - 7 PM	3	14	East:	12	24	SouthEast:	0	0
7 PM - 12 MID	10	45	West:	14	28	SouthWest:	0	0
12 MID - 6 AM	2	9.1	Unknown:	0	0			
Unspecified	0	0				Total	50	
Total	22							

Weather	No. of Accidents	% of Total	Acc. Type	# Veh	% of Total	Acc. Type	# Veh	% of Total
Clear:	15	68	Sideswipe:	0	0	Bicycle:	0	0
Cloudy:	4	18	Rear End:	1	4.5	Right Turn:	2	9.1
Fog:	0	0	Right Angle:	14	64	Driveway:	0	0
Rain:	2	9.1	Left Turn:	4	18	Backing:	0	0
Sleet:	0	0	Pedestrian:	0	0	Overtaking:	0	0
Snow:	1	4.5	Fixed Object:	0	0	Unknown:	1	4.5
Unknown:	0	0	Head on:	0	0			
Total	22					Total	22	

Pavement	No. of Accidents	% of Total	Accident Severity	No. of Accidents	% of Total
Dry:	17	77	Fatal:	0	0
Muddy:	0	0	Non-Fatal Injury:	5	23
Other:	0	0	Property damage only:	17	77
Slush:	0	0	Non-reportable:	0	0
Snow/Ice:	1	4.5	Total	22	
Wet:	4	18			
Unknown:	0	0	Type of Vehicle	No. of Accidents	% of Total
Total	22		Passenger Cars:	50	94
			Commercial Vehicles:	3	5.7
			Total	53	

Time of Year	No. of Accidents	% of Total	Light Condition	No. of Accidents	% of Total
Winter (Dec-Feb)	5	23	Dark Road-Lighted:	9	41
Spring (Mar-May)	3	14	Dark Road-Unlighted:	0	0
Summer (Jun-Aug)	8	36	Dawn:	0	0
Fall (Sep-Nov)	6	27	Daylight:	12	55
Total	22		Dusk:	1	4.5
			Unknown:	0	0
			Total	22	

DETAILS OF ACCIDENT HISTORY
 Sear-Brown Group

Diagram: Union St.
 County of Monroe
 Town of City of Rochester

Street Name: Union St. Corridor
Route Number: _____
Location: Union St.
Milepost: S. Union St To: E. Main St
Date of Report: 1/13/200

P.I.N. _____
Case No. _____
File _____
By _____
Page Number 1

PERIOD STUDIED
 From 3/17/200
 To: 5/31/200
 39 Months

(1) No.	(2) Date	(3) Time	(4)	(5)	(6)	(7)	(8)	(9)	(10) Apparent Contributing Factors	(11) Acc. Type	(12) Description
4001	10/28/2006	2:27	V	S	L	R	S	2	320	Over	V1 ENTERED V2'S LANE AND STRUCK V2 (20) Unsafe Lane Changing
4002	7/23/2006	8:48	e	h	g	o	u	1	218	Unkn	V1 TURNED IN FRON OF V2 IN AN ATTEMPT TO TURN INTO A DRIVEWAY (18) Turning Improperly
4004	12/16/2006	0:50	i	e	h	a	r	1	118	Dry	V1 EXITING LOT STRUCK V2 ENTERING PARKING LOT (18) Turning Improperly
4005	6/13/2006	16:15	c	r	C	C	C	1	14	FixO	V1 STRUCK PARKING SIGN (4) Driver Inattention
4006	6/11/2006	0:00	l	i	o	o	o	1	126	Right	V1 (MOTORCYCLE) STOPPED TO turn RIGHT INTO PARKING LOT (26) Reaction to Other Uninvolved Vehicle
4008	5/15/2007	8:10	s	e	P	D	O	1	2	Rang	V2 STRUCK V1 AS V1 WAS MAKING LEFT TURN
4009	6/12/2007	8:47	e	v	P	D	O	1	17	Rang	V1 FAILED TO STOP FOR RED LIGHT & STRUCK V2 (7) Failure to Yield Right of Way
4010	7/28/2007	2:20	i	c	P	D	O	4	1,13,17	Left	V2 TURNED LEFT IN FRONT OF V1. V1 STRUCK V2 (13) Passing or Lane Usage Improper (17) Traffic Control Disregarded
4011	11/30/2007	23:45	e	h	P	D	O	4	1	Left	V2 TURNED LEFT IN FRONT OF V1, V1 STRUCK V2 (18) Turning Improperly (20) Unsafe Lane Changing
4012	12/1/2007	13:36	v	e	P	D	O	1	17	Rang	V2 RAN RED LIGHT & STRUCK V1. V2 FLED SCENE (7) Failure to Yield Right of Way
4013	4/20/2008	10:54	i	c	P	D	O	1	217	Rang	V1 WENT THRU RED LIGHT & STRUCK V2 (17) Traffic Control Disregarded
4015	10/9/2006	21:00	e	v	P	D	O	4	1	Back	V1 BACKED INTO V2 WHILE V2 WAS PARKED
4016	11/3/2006	22:34	s	e	P	D	O	4	1	Left	V2 TURN LEFT, V1 STRUCK V2 BOTH IN LEFT LANES (13) Passing or Lane Usage Improper
4018	5/3/2007	17:25	e	h	P	D	O	1	4	FixO	V1 SWERVED TO AVOID V2, STRUCK CURB (26) Reaction to Other Uninvolved Vehicle

DETAILS OF ACCIDENT HISTORY
 Sear-Brown Group
 P.I.N. _____
 Case No. _____
 File _____
 By _____
 Page Number 2

Diagram: Union St.
 County of Monroe
 Town of City of Rochester
 Street Name: Union St. Corridor
 Route Number:
 Location: Union St.
 Milepost: S. Union St To: E. Main St
 Date of Report: 1/13/200

PERIOD STUDIED
 From 3/17/200
 To: 5/31/200
 39 Months

(1) No.	(2) Date	(3) Time	(4)	(5)	(6)	(7)	(8)	(9)	(10) Apparent Contributing Factors	(11) Acc. Type	(12) Description
4019	5/5/2006	8:45	V	S	L	R	S	1	1	14	Side V1 STARTED TO SWITCH LANES & SIDESWIPE V2 (4) Driver Inattention
4021	3/31/2006	11:07	e	h	g	o	u	1	1	19	REnd V2 STOPPED & V1 REAR-ENDED V2 (9) Following Too Closely
4022	10/30/2005	1:30	v	h	h	a	r	4	1	14	Back V1 WAS PARKED & V2 WAS STOPPED AT CORNER. V1 BACKED INTO V2 (4) Driver Inattention
4023	12/10/2005	17:18	i	e	t	c	o	4	1	14	REnd V2 STOPPED & TRAFFIC LIGHT & V1 REAR-ENDED V2 (4) Driver Inattention
4025	5/31/2006	23:50	e	r	c	o	r	4	1	24	Side V2 PARKED. V1 TURNED RIGHT INTO THE PARK LOT STRUCK V2 (4) Driver Inattention
4026	1/22/2008	10:52	l	i	o	n	e	1	1	23	Back V1 BACKING INTO DRIVEWAY & STRUCK V2 STOPPED IN TRAFFIC (3) Backing Unsafely
4027	10/12/2007	14:32	e	s	e	r	d	1	1	14	REnd V1 (RTS BUS) REAR-ENDED V2. (4) Driver Inattention
4028	8/12/2007	2:41	y	o	n	d	o	4	1	17,17	RAng V2 STRUCK BY V1 WHICH THEN FLED SCENE (7) Failure to Yield Right of Way (17) Traffic Control Disregarded
4029	2/16/2007	2:25						4	1	42,19	Unkn V1 HIGH RATE OF SPEED, SLID ICY ROAD, CURB (2) Alcohol Involvement (19) Unsafe Speed
4031	5/20/2006	1:02						4	1	39,26	REnd V2 AVOID UNKNOWN VEHICLE, REAR-ENDED BY V1 (9) Following Too Closely (26) Reaction to Other Uninvolved Vehicle
4032	11/17/2005	0:30						4	1	22	FixO V1 SWERVED OFF ROAD, OVER CURB, STRUCK TREE (2) Alcohol Involvement
4033	4/4/2008	8:40						1	1	2,320,7	Side V1 CHANGED LANES & struck v2 (20) Unsafe Lane Changing (7) Failure to Yield Right of Way
4035	6/9/2006	14:00						1	1	220	Left V1 WAS CHANGING LANES WHEN IT STRUCK V2 (20) Unsafe Lane Changing
4036	8/26/2005	1:49						1	1	22,3	Left V1 BACKING DOWN STREET INTO V2. (2) Alcohol Involvement (3) Backing Unsafely

DETAILS OF ACCIDENT HISTORY
 Sear-Brown Group

Diagram: Union St.
 County of Monroe
 Town of City of Rochester

Street Name: Union St. Corridor
Route Number:
Location: Union St.
Milepost: S. Union St To: E. Main St
Date of Report: 1/13/200

P.I.N. _____
Case No. _____
File _____
By _____
Page Number 3

PERIOD STUDIED
 From 3/17/200
 To: 5/31/200
 39 Months

(4) (5) (6) (7) (8) (9)

(1) No.	(2) Date	(3) Time	(4)	(5)	(6)	(7)	(8)	(9)	(10) Apparent Contributing Factors	(11) Acc. Type	(12) Description
4037	4/29/2006	1:34								Left	V1 TURNED LEFT, WRONG WAY, ONE WAY ST. SIDESWIPING V2 & V3 (2) Alcohol Involvement (19) Unsafe Speed
4038	3/11/2008	15:43								REnd	V2 PARKED WHEN V1 SWERVED V1 REAR-ENDED V2 (9) Following Too Closely
4041	5/31/2008	4:32								RAng	V1 VEHICLE WOULD NOT TURN & STRUCK CURB (5) Driver Inexperience
4043	3/31/2006	11:07								REnd	V1 EXITED INNER LOOP & STRUCK V2 (9) Following Too Closely
4044	1/2/2006	22:55								REnd	V1 REAR-ENDED V2 PARKED. (2) Alcohol Involvement (47) Tire Failure/Inadequate
4045	4/5/2008	2:45								REnd	V1 ATTEMPTED TO STOP & REAR-ENDED V2 (9) Following Too Closely (66) Pavement Slippery
4046	3/15/2008	13:50								RAng	V2 ENTERED INTERSECTION & WAS STRUCK BY V1.
4047	12/12/2007	17:59								REnd	V2 STOPPED TO AVOID ANOTHER V & WAS REAR-ENDED BY V1 (26) Reaction to Other Uninvolved Vehicle
4049	2/22/2008	19:15								REnd	V2 STOPPED AT RED LIGHT AND WAS REAR-ENDED BY V1. (4) Driver Inattention
4050	3/17/2005	23:41								Back	V1 TURNED THE WRONG WAY ONTO ONE-WAY STREET, THEN BACKED UP & STRUCK V2 (2) Alcohol Involvement (3) Backing Unsafely
4051	3/31/2006	11:07								REnd	S. Union St @ Griffith St (9) Following Too Closely
4052											Add accidents found: E. Main+ University+East Ave+Broad+Monroe corridors

Location: Union St.

Town: City of Rochester

13-Jan-09

County: Monroe

Milepost: S. Union St

To: E. Main St

Time of Day	No. of Accidents	% of Total	Direction	# Veh	% of Total	Direction	# Veh	% of Total
6 AM - 10 AM	5	13	North:	41	56	NorthEast:	4	5.5
10:00 AM - 4 PM	10	26	South:	9	12	NorthWest:	5	6.8
4 PM - 7 PM	4	10	East:	6	8.2	SouthEast:	2	2.7
7 PM - 12 MID	7	18	West:	6	8.2	SouthWest:	0	0
12 MID - 6 AM	13	33	Unknown:	0	0			
Unspecified	0	0				Total	73	
Total	39							

Weather	No. of Accidents	% of Total	Acc. Type	# Veh	% of Total	Acc. Type	# Veh	% of Total
Clear:	19	49	Sideswipe:	3	7.7	Bicycle:	0	0
Cloudy:	15	38	Rear End:	11	28	Right Turn:	1	2.6
Fog:	0	0	Right Angle:	7	18	Driveway:	1	2.6
Rain:	3	7.7	Left Turn:	6	15	Backing:	4	10
Sleet:	0	0	Pedestrian:	0	0	Overtaking:	1	2.6
Snow:	2	5.1	Fixed Object:	3	7.7	Unknown:	2	5.1
Unknown:	0	0	Head on:	0	0			
Total	39					Total	39	

Pavement	No. of Accidents	% of Total	Accident Severity	No. of Accidents	% of Total
Dry:	28	74	Fatal:	0	0
Muddy:	0	0	Non-Fatal Injury:	5	13
Other:	0	0	Property damage only:	34	87
Slush:	1	2.6	Non-reportable:	0	0
Snow/Ice:	1	2.6	Total	39	
Wet:	8	21			
Unknown:	0	0	Type of Vehicle	No. of Accidents	% of Total
Total	38		Passenger Cars:	73	
			Commercial Vehicles:		
			Total		

Time of Year	No. of Accidents	% of Total	Light Condition	No. of Accidents	% of Total
Winter (Dec-Feb)	8	21	Dark Road-Lighted:	21	54
Spring (Mar-May)	16	41	Dark Road-Unlighted:	0	0
Summer (Jun-Aug)	8	21	Dawn:	0	0
Fall (Sep-Nov)	7	18	Daylight:	18	46
Total	39		Dusk:	0	0
			Unknown:	0	0
			Total	39	

DETAILS OF ACCIDENT HISTORY
 Sear-Brown Group

Diagram: Monroe Av
 County of Monroe
 Town of City of Rochester

Street Name: Monroe Ave Corridor
Route Number:
Location: Monroe Ave
Milepost: Chestnut To: Alexander St.
Date of Report: 1/13/200

P.I.N. _____
Case No. _____
File _____
By _____
Page Number 1

PERIOD STUDIED
 From 1/4/2005
 To: 5/28/200
 41 Months

(1) No.	(2) Date	(3) Time	(4) V	(5) S	(6) L	(7) R	(8) S	(9) W	(10) Apparent Contributing Factors	(11) Acc. Type	(12) Description
5001	5/18/2006	13:44		PDO	1	1	2	27		RAng	V1 WENT THRU RED LIGHT & STRUCK V2 (7) Failure to Yield Right of Way
5002	7/8/2006	12:22		PDO	1	1	1	19		REnd	V2 STOPPED IN TRAFFIC & WAS REAR-ENDED BY V1 (9) Following Too Closely
5003	11/7/2007	22:45		PDO	4	1	1	217		RAng	V1 WENT THRU A RED LIGHT & WAS STRUCK BY V2 (17) Traffic Control Disregarded
5004	5/28/2008	22:59		PDO	4	1	1	17,18		RAng	V1 MAKE A WRONG TURN ON A ONE WAY ST. V1 THEN MADE A U-TURN & STRUCK V2 (7) Failure to Yield Right of Way (18) Turning Improperly
5005	6/3/2006	19:52		Inj	1	1	2	217		RAng	V2 WENT THRU RED LIGHT & WAS STRUCK BY V1. V2 THEN STRUCK V3 (17) Traffic Control Disregarded
5006	1/4/2005	10:15		PDO	1	1	1	24,7		RAng	V2 ATTEMPTED TO MAKE A LEFT TURN & WAS STRUCK BY V1 (4) Driver Inattention (7) Failure to Yield Right of Way
5007	6/22/2006	8:48		PDO	1	1	1	24		REnd	V2 STOPPED, V1 LIGHT TURN GREEN & THOUGHT V2 HAD STARTED TO MOVE (4) Driver Inattention
5008	7/28/2006	23:05		Inj	4	1	1	14		REnd	V2 STOPPED TO MAKE A LEFT TURN WHEN V1 REAR-ENDED V2 (4) Driver Inattention
5009	7/5/2005	15:00		PDO	1	1	2	27		Side	V1 ATTEMPTED TO ENTER TRAFFIC & STRUCK V2 (7) Failure to Yield Right of Way
5010	12/31/2005	19:43		Inj	4	1	1	14,7		REnd	V2 STOPPED TO turn LEFT, V1 REAR-ENDED V2 (4) Driver Inattention (7) Failure to Yield Right of Way
5011	9/25/2005	15:21		PDO	1	1	1	117,7		RAng	V2 ran a RED LIGHT & STRUCK BY V1 (17) Traffic Control Disregarded (7) Failure to Yield Right of Way
5012	12/22/2005	0:06		PDO	4	1	2	218,69		Drwy	V1 EXITED PARKING LOT INTO PATH OF V2 (18) Turning Improperly (69) View Obstructed/Limited
5013	2/24/2006	9:02		PDO	1	1	2	27		Right	V2 TURNED IN FRONT OF V1 & WAS STRUCK BY V1 (7) Failure to Yield Right of Way
5014	6/22/2007	17:51		PDO	1	1	1	1		Right	V1 TURNED RIGHT & STRUCK PARKED V2, PUSHING IT INTO V3

DETAILS OF ACCIDENT HISTORY
 Sear-Brown Group

Diagram: Monroe Av
 County of Monroe
 Town of City of Rochester

Street Name: Monroe Ave Corridor
Route Number:
Location: Monroe Ave
Milepost: Chestnut To: Alexander St.
Date of Report: 1/13/200

P.I.N. _____
Case No. _____
File _____
By _____
Page Number 2

PERIOD STUDIED
 From 1/4/2005
 To: 5/28/200
 41 Months

(1) No.	(2) Date	(3) Time	(4)	(5)	(6)	(7)	(8)	(9)	(10) Apparent Contributing Factors	(11) Acc. Type	(12) Description
5015	3/28/2007	17:25	PDO	1	1	1	1	19		REnd	V1 REAR-ENDED V2 (9) Following Too Closely
5016	3/31/2008	14:33	PDO	1	1	1	226,26			REnd	V1 REAR-ENDED V2 (26) Reaction to Other Uninvolved Vehicle (26) Reaction to Other Uninvolved Vehicle
5017	7/22/2005	16:47	PDO	1	1	1	17			Side	V1 PULLED INTO TRAFFIC FROM CURB & STRUCK V2 (7) Failure to Yield Right of Way
5019	9/28/2007	0:15	PDO	4	1	1	1			Side	V2 PARKED , STRUCK BY ANOTHER VEHICLE
5020	4/5/2008		PDO	1			13			Side	V1 (UNKNOWN) SIDESWIPE V2 & V3 AS both PARKED (13) Passing or Lane Usage Improper
5023	3/14/2008	14:08	Inj	1	1	1	29,42			REnd	V2 SLOWED FOR TRAFFIC, V1 REAR-ENDED V2. (9) Following Too Closely (42) Brakes Defective
5024	3/14/2008	14:08	Inj	1	1	1	29,42			REnd	V2 SLOWED FOR TRAFFIC, V1 REAR-ENDED V2. (9) Following Too Closely (42) Brakes Defective
5025	7/13/2007	2:11	Inj	4	1	2	34			Right	V1 WRONG WAY-ONE WAY ST., TURNED RIGHT & STRUCK PEDESTRIAN (4) Driver Inattention
5026	6/13/2005	14:36	PDO	1	1	1	19			REnd	V2 STOPPED IN TRAFFIC & WAS REAR-ENDED BY V1 (9) Following Too Closely
5028	7/8/2005	2:08	PDO	4	1	1	12,13			REnd	V2 PARKED. V1 REAR-ENDED V2, THEN STRUCK SIGN & WALL (2) Alcohol Involvement (13) Passing or Lane Usage Improper
5029	12/21/2005	15:49	Inj	1	1	2	29			REnd	V2 STOPPED FOR LIGHT WHEN LIGHT TURNED GREEN, V1 REAR-ENDED V2 (9) Following Too Closely
5031	2/19/2006	1:58	PDO	4	1	2	1			REnd	V2 PARKED. V1 STRUCK V2 & FLED SCENE.
5032	9/27/2005	1:10	PDO	4	1	1	1			FixO	V1 OVER CURB & STRUCK TREE
5033	10/7/2005	13:20	PDO	1	1	2	37			Right	V1 PULLED FROM CURB INTO TRAFFIC & STRUCK V2 (7) Failure to Yield Right of Way

DETAILS OF ACCIDENT HISTORY
Sear-Brown Group

Diagram: Monroe Av
County of Monroe
Town of City of Rochester

Street Name: Monroe Ave Corridor
Route Number:
Location: Monroe Ave
Milepost: Chestnut To: Alexander St.
Date of Report: 1/13/200

P.I.N. _____
Case No. _____
File _____
By _____
Page Number 3

PERIOD STUDIED
From 1/4/2005
To: 5/28/200
41 Months

(1) No.	(2) Date	(3) Time	(4) V	(5) S	(6) L	(7) R	(8) S	(9) W	(10) Apparent Contributing Factors	(11) Acc. Type	(12) Description
5034	2/18/2007	7:30	Inj	1	1	1	1	1	166	Unkn	V1 SLIDE ON SLIPPERY PAVEMENT & STRUCK GUIDE RAIL. (66) Pavement Slippery
5035	5/25/2007	9:58	Inj	1	1	1	1	1	17,7	RAng	V1 STRUCK V2 WHICH WAS IN THE INTERSECTION. (7) Failure to Yield Right of Way (7) Failure to Yield Right of Way
5036	4/8/2007	19:06	PDO	1	1	1	1	1	260,13	Side	V1 STOPPED MAKE A LEFT TURN. V2 PASS V1 ON LEFT. V1 THEN STRUCK V2 (60) Other Vehicular (13) Passing or Lane Usage Improper
5037	8/20/2007	14:13	PDO	1	1	2	3	17	317	RAng	V2 STOPPED, WHEN LIGHT CHANGED V2 ENTERED INTERSECTION & STRUCK BY V1 (17) Traffic Control Disregarded
5038	8/17/2007	17:26	PDO	1	1	2	3	66	39,66	REnd	V1 REAR-ENDED V2, PUSHING IT INTO V3 (9) Following Too Closely (66) Pavement Slippery
5040	3/19/2006	2:30	PDO	4	4	1	1	13	113	FixO	D1 STRUCK THE MEDIAN and sign (13) Passing or Lane Usage Improper
5041	7/3/2006	1:56	Fat	4	4	1	1	1	1	FixO	V1 (MOTORCYCLE) LOST CONTROL & HIT CURB, LIGHT POLE
5042	9/5/2006	20:08	Inj	4	1	1	1	2	217	RAng	V1 WENT THRU A RED LIGHT & STRUCK V2 (17) Traffic Control Disregarded
5044	9/19/2006	10:07	PDO	1	1	1	1	1	117	RAng	V1 (BUS) ENTERED THE INTERSECTION & STRUCK V2. (17) Traffic Control Disregarded
5047	12/27/2005	17:34	Inj	4	1	1	1	2	7	Left	Ref. Mirkr. 31 4303 2042 (7) Failure to Yield Right of Way
5048	10/26/2007	15:54	Inj	1	1	2	3			REnd	Ref. Mirkr. 31 4303 2042
5049	12/3/2007	11:40	Inj	1	1	2	4	4	4,4	RAng	Ref. Mirkr. 31 4303 2042 (4) Driver Inattention (4) Driver Inattention
5051	3/16/2007	21:20	PDO	4	1	4	4	18,60	60	REnd	V1 was parallel parking and struck V2, turning improperly, other vehicular (18) Turning Improperly (60) Other Vehicular
5052	5/30/2006	11:22	Inj	1	1	1	1	1	14	Bike	Monroe Ave @ Linwood Pl (14) Pedestrian's Error/Confusion

DETAILS OF ACCIDENT HISTORY
 Sear-Brown Group

Diagram: Monroe Av
 County of Monroe
 Town of City of Rochester

Street Name: Monroe Ave Corridor
Route Number:
Location: Monroe Ave
Milepost: Chestnut To: Alexander St.
Date of Report: 1/13/200

P.I.N. _____
Case No. _____
File _____
By _____
Page Number 4

PERIOD STUDIED
 From 1/4/2005
 To: 5/28/200
 41 Months

(1) No.	(2) Date	(3) Time	(4)	(5)	(6)	(7)	(8)	(9)	(10) Apparent Contributing Factors	(11) Acc. Type	(12) Description
5053	5/21/2007	15:00	V	S	L	R	S			REnd	V1 stopped at signal then drove forward and struck V2, inattentation, failure to yield (4) Driver Inattentation (7) Failure to Yield Right of Way
5054	11/3/2005	0:15	e	h	g	o	a	W		H-On	V1 struck median and sign post, driver inattentation (4) Driver Inattentation
5055	7/4/2006	23:14	i	c	h	r	r	e		REnd	V1 rear ended V2 who was stopped at light. V1 states breaks defective (42) Brakes Defective
5056			l	e	t	c	o	a			Additional Accidents on Union Street summary

Location: Monroe Ave

Town: City of Rochester

13-Jan-09

County: Monroe

Milepost: Chestnut

To: Alexander St.

Time of Day	No. of Accidents	% of Total	Direction	# Veh	% of Total	Direction	# Veh	% of Total
6 AM - 10 AM	4	9.1	North:	9	11	NorthEast:	2	2.4
10:00 AM - 4 PM	17	39	South:	13	16	NorthWest:	4	4.9
4 PM - 7 PM	5	11	East:	39	48	SouthEast:	2	2.4
7 PM - 12 MID	9	20	West:	12	15	SouthWest:	1	1.2
12 MID - 6 AM	9	20	Unknown:	0	0			
Unspecified	0	0				Total	82	
Total	44							

Weather	No. of Accidents	% of Total	Acc. Type	# Veh	% of Total	Acc. Type	# Veh	% of Total
Clear:	22	50	Sideswipe:	5	11	Bicycle:	1	2.2
Cloudy:	15	34	Rear End:	17	38	Right Turn:	4	8.9
Fog:	0	0	Right Angle:	11	24	Driveway:	1	2.2
Rain:	5	11	Left Turn:	1	2.2	Backing:	0	0
Sleet:	0	0	Pedestrian:	0	0	Overtaking:	0	0
Snow:	2	4.5	Fixed Object:	3	6.7	Unknown:	1	2.2
Unknown:	0	0	Head on:	1	2.2			
Total	44					Total	45	

Pavement	No. of Accidents	% of Total	Accident Severity	No. of Accidents	% of Total
Dry:	30	68	Fatal:	1	2.2
Muddy:	0	0	Non-Fatal Injury:	14	31
Other:	0	0	Property damage only:	30	67
Slush:	0	0	Non-reportable:	0	0
Snow/Ice:	1	2.3	Total	45	
Wet:	13	30			
Unknown:	0	0	Type of Vehicle	No. of Accidents	% of Total
Total	44		Passenger Cars:	87	
			Commercial Vehicles:		
			Total		

Time of Year	No. of Accidents	% of Total	Light Condition	No. of Accidents	% of Total
Winter (Dec-Feb)	9	20	Dark Road-Lighted:	17	39
Spring (Mar-May)	13	29	Dark Road-Unlighted:	0	0
Summer (Jun-Aug)	14	31	Dawn:	0	0
Fall (Sep-Nov)	9	20	Daylight:	27	61
Total	45		Dusk:	0	0
			Unknown:	0	0
			Total	44	

DETAILS OF ACCIDENT HISTORY
 Sear-Brown Group

Diagram: East Broad
 County of Monroe
 Town of City of Rochester

Street Name: E. Broad St Corridor
Route Number:
Location: East Broad St
Milepost: Savanah St To: Union St
Date of Report: 1/13/200

P.I.N. _____
Case No. _____
File _____
By _____
Page Number 1

PERIOD STUDIED
 From 10/23/20
 To: 5/23/200
 32 Months

(1) No.	(2) Date	(3) Time	(4) V e h i c l e	(5) S e v e r i t y	(6) L g h t	(7) R o a d	(8) S u r f a c e	(9) W e a t h e r	(10) Apparent Contributing Factors	(11) Acc. Type	(12) Description
7004	5/4/2007	4:05	PDO	4	1	1	1	1	117	FixO	V1 TURNED LEFT & DROVE OVER MEDIAN & SIGN. (17) Traffic Control Disregarded
7005	11/4/2006	23:39	PDO	4	1	1	1	113		FixO	V1 FAILED TO STOP AT STOP SIGN, WENT ACROSS INTERSECTION & HIT THE FIRE HYDRANT (13) Passing or Lane Usage Improper
7006	10/23/2005	14:05	PDO	1	1	2	3,4,20			Side	V1 SIDESWIPE V2. V2 DROVE OVER MEDIAN & OVER A STREET SIGN (4) Driver Inattention (20) Unsafe Lane Changing
7007	2/19/2006	2:55	PDO	4	1	4	166			Unkn	V1 SLID ON BLACK ICE INTO CURB (66) Pavement Slippery
7008	10/15/2007	14:05	PDO	1	1	1	117, 17			RAng	(17) Traffic Control Disregarded (17) Traffic Control Disregarded
7009	5/23/2008	12:40	PDO	1	1	1	117,13			Left	V1 making left out of lot went wrong way down browd st hit v2 going EB (17) Traffic Control Disregarded (13) Passing or Lane Usage Improper
7010											Add accidents found: Pitkin St + Union St Corridors

Location: East Broad St

Town: City of Rochester

13-Jan-09

County: Monroe

Milepost: Savannah St

To: Union St

Time of Day	No. of Accidents	% of Total	Direction	# Veh	% of Total	Direction	# Veh	% of Total
6 AM - 10 AM	0	0	North:	1	11	NorthEast:	0	0
10:00 AM - 4 PM	3	50	South:	1	11	NorthWest:	0	0
4 PM - 7 PM	0	0	East:	5	56	SouthEast:	0	0
7 PM - 12 MID	1	17	West:	2	22	SouthWest:	0	0
12 MID - 6 AM	2	33	Unknown:	0	0			
Unspecified	0	0				Total	9	
Total	6							

Weather	No. of Accidents	% of Total	Acc. Type	# Veh	% of Total	Acc. Type	# Veh	% of Total
Clear:	5	83	Sideswipe:	1	17	Bicycle:	0	0
Cloudy:	0	0	Rear End:	0	0	Right Turn:	0	0
Fog:	0	0	Right Angle:	1	17	Driveway:	0	0
Rain:	1	17	Left Turn:	1	17	Backing:	0	0
Sleet:	0	0	Pedestrian:	0	0	Overtaking:	0	0
Snow:	0	0	Fixed Object:	2	33	Unknown:	1	17
Unknown:	0	0	Head on:	0	0			
Total	6					Total	6	

Pavement	No. of Accidents	% of Total	Accident Severity	No. of Accidents	% of Total
Dry:	4	67	Fatal:	0	0
Muddy:	0	0	Non-Fatal Injury:	0	0
Other:	0	0	Property damage only:	6	100
Slush:	0	0	Non-reportable:	0	0
Snow/Ice:	1	17	Total	6	
Wet:	1	17			
Unknown:	0	0			
Total	6				

Type of Vehicle	No. of Accidents	% of Total
Passenger Cars:	9	
Commercial Vehicles:		
Total		

Time of Year	No. of Accidents	% of Total	Light Condition	No. of Accidents	% of Total
Winter (Dec-Feb)	1	17	Dark Road-Lighted:	3	50
Spring (Mar-May)	2	33	Dark Road-Unlighted:	0	0
Summer (Jun-Aug)	0	0	Dawn:	0	0
Fall (Sep-Nov)	3	50	Daylight:	3	50
			Dusk:	0	0
Total	6		Unknown:	0	0
			Total	6	

DETAILS OF ACCIDENT HISTORY
 Sear-Brown Group

Diagram: Pitkin St
 County of Monroe
 Town of City of Rochester

Street Name: Pitkin St
Route Number:
Location: Pitkin St
Milepost: E. Main St To: Chestnut/Mon
Date of Report: 1/13/200

P.I.N. _____
Case No. _____
File _____
By _____
Page Number 1

PERIOD STUDIED
 From 10/23/20
 To: 5/23/200
 32 Months

(1) No.	(2) Date	(3) Time	(4)	(5)	(6)	(7)	(8)	(9)	(10) Apparent Contributing Factors	(11) Acc. Type	(12) Description
7004	5/4/2007	4:05	V	S	L	R	S	1	1,17	FixO	V1 TURNED LEFT & DROVE OVER MEDIAN & SIGN. (17) Traffic Control Disregarded
7005	11/4/2006	23:39	e	h	g	o	u	1	113	FixO	V1 FAILED TO STOP AT STOP SIGN, WENT ACROSS INTERSECTION & HIT THE FIRE HYDRANT (13) Passing or Lane Usage Improper
7006	10/23/2005	14:05	i	c	h	a	r	2	3,4,20	Side	V1 SIDESWIPE V2. V2 DROVE OVER MEDIAN & OVER A STREET SIGN (4) Driver Inattention (20) Unsafe Lane Changing
7007	2/19/2006	2:55	e	v	t	o	e	4	166	Unkn	V1 SLID ON BLACK ICE INTO CURB (66) Pavement Slippery
7008	10/15/2007	14:05	c	r	C	C	o	1	1,17, 17	RAng	(17) Traffic Control Disregarded (17) Traffic Control Disregarded
7009	5/23/2008	12:40	l	i	o	n	n	1	1,17,13	Left	V1 making left out of lot went wrong way down browd st hit v2 going EB (17) Traffic Control Disregarded (13) Passing or Lane Usage Improper
7010											Add accidents found: Pitkin St + Union St Corridors

Location: Pitkin St

Town: City of Rochester

13-Jan-09

County: Monroe

Milepost: E. Main St

To: Chestnut/Monro

Time of Day	No. of Accidents	% of Total	Direction	# Veh	% of Total	Direction	# Veh	% of Total
6 AM - 10 AM	2	17	North:	0	0	NorthEast:	0	0
10:00 AM - 4 PM	5	42	South:	10	43	NorthWest:	0	0
4 PM - 7 PM	1	8.3	East:	3	13	SouthEast:	0	0
7 PM - 12 MID	3	25	West:	9	39	SouthWest:	1	4.3
12 MID - 6 AM	1	8.3	Unknown:	0	0			
Unspecified	0	0				Total	23	
Total	12							

Weather	No. of Accidents	% of Total	Acc. Type	# Veh	% of Total	Acc. Type	# Veh	% of Total
Clear:	5	42	Sideswipe:	0	0	Bicycle:	0	0
Cloudy:	3	25	Rear End:	5	42	Right Turn:	1	8.3
Fog:	0	0	Right Angle:	3	25	Driveway:	0	0
Rain:	2	17	Left Turn:	0	0	Backing:	0	0
Sleet:	0	0	Pedestrian:	1	8.3	Overtaking:	1	8.3
Snow:	2	17	Fixed Object:	0	0	Unknown:	1	8.3
Unknown:	0	0	Head on:	0	0			
Total	12					Total	12	

Pavement	No. of Accidents	% of Total	Accident Severity	No. of Accidents	% of Total
Dry:	7	58	Fatal:	0	0
Muddy:	0	0	Non-Fatal Injury:	1	8.3
Other:	0	0	Property damage only:	11	92
Slush:	0	0	Non-reportable:	0	0
Snow/Ice:	2	17	Total	12	
Wet:	3	25			
Unknown:	0	0			
Total	12				

Time of Year	No. of Accidents	% of Total	Type of Vehicle	No. of Accidents	% of Total
Winter (Dec-Feb)	4	33	Passenger Cars:	23	
Spring (Mar-May)	4	33	Commercial Vehicles:		
Summer (Jun-Aug)	2	17	Total		
Fall (Sep-Nov)	2	17			
Total	12				

Light Condition	No. of Accidents	% of Total
Dark Road-Lighted:	5	42
Dark Road-Unlighted:	0	0
Dawn:	0	0
Daylight:	7	58
Dusk:	0	0
Unknown:	0	0
Total	12	

**Exhibit 2.6
Accident Rates**

Intersection	Number of Accidents	State/ County Rate	Actual Rate	
Intersection Rate (excludes midblock accidents)				
East Main Street @ University/Pitkin	7	0.26 / 0.46	0.33	ACC/MEV
East Main Street @ Inner Loop/University	40	0.26 / 0.46	0.96	ACC/MEV
East Main Street @ Union Street	23	0.26 / 0.46	0.83	ACC/MEV
Pitkin Street @ East Ave	8	0.34 / 0.22	0.44	ACC/MEV
Pitkin Street @ Broad Street	4	0.34 / 0.22	0.66	ACC/MEV
Union Street @ University Ave	14	0.34 / 0.22	0.65	ACC/MEV
Union Street @ East Ave	17	0.34 / 0.22	1.13	ACC/MEV
Union Street @ Broad St	3	0.19 / 0.22	0.71	ACC/MEV
Monroe Avenue @ Inner Loop/ Pitkin St.	7	0.34 / 0.22	0.26	ACC/MEV
Monroe Avenue @ Howell St.	5	0.34 / 0.22	0.34	ACC/MEV
Monroe Avenue @ South Union St.	20	0.34 / 0.22	1.12	ACC/MEV
Link Rate				
Inner Loop - 940T				
<i>Rt. 490-E. Main St.</i>	30	2.72	2.48	ACC/MVM
I-490				
<i>W.of River -E. of Clinton</i>	47	2.72	1.08	ACC/MVM

ACCIDENT RATES

Intersection	Number of Accidents	State/County Rate	Actual Rate	
Intersection Rate (excludes midblock accidents)				
East Main Street @ <i>University/Pitkin</i>	7	0.26 / 0.46	0.33	ACC/MEV
East Main Street @ <i>Inner Loop/University</i>	40	0.26 / 0.46	0.96	ACC/MEV
East Main Street @ <i>Union Street</i>	23	0.26 / 0.46	0.83	ACC/MEV
Pitkin Street @ <i>East Ave</i>	8	0.34 / 0.22	0.44	ACC/MEV
Pitkin Street @ <i>Broad Street</i>	4	0.34 / 0.22	0.66	ACC/MEV
Union Street @ <i>University Ave</i>	14	0.34 / 0.22	0.65	ACC/MEV
Union Street @ <i>East Ave</i>	17	0.34 / 0.22	1.13	ACC/MEV
Union Street @ <i>Broad St</i>	3	0.19 / 0.22	0.71	ACC/MEV
Monroe Avenue @ <i>Inner Loop/ Pitkin St.</i>	7	0.34 / 0.22	0.26	ACC/MEV
Monroe Avenue @ <i>Howell St.</i>	5	0.34 / 0.22	0.34	ACC/MEV
Monroe Avenue @ <i>South Union St.</i>	20	0.34 / 0.22	1.12	ACC/MEV
Link Rate				
Inner Loop - 940T				
<i>Rt. 490-E. Main St.</i>	30	2.72	2.48	ACC/MVM
I-490				
<i>W.of River -E. of Clinton</i>	47	2.72	1.08	ACC/MVM

ACCIDENT RATE CALCULATIONS

Project Name: **Inner Loop**
 Date: 12/10/2008

Intersection Rate

(excludes midblock accidents)

East Main Street @ University Ave/Pitkin	# Accidents	Per Million Entering Vehicles				
	7	x 1,000,000	=	$\frac{7000000}{21034950}$	=	0.33 ACC/MEV
	16,950	x 3.4	x 365			0.26 Statewide Rate
	Vehicles/Day	# of Years	Days/Year			0.46 County Rate
Inner Loop/University	# Accidents	Per Million Entering Vehicles				
	40	x 1,000,000	=	$\frac{40000000}{41511450}$	=	0.96 ACC/MEV
	33,450	x 3.4	x 365			0.26 Statewide Rate
	Vehicles/Day	# of Years	Days/Year			0.46 County Rate
Union Street	# Accidents	Per Million Entering Vehicles				
	23	x 1,000,000	=	$\frac{23000000}{27736350}$	=	0.83 ACC/MEV
	22,350	x 3.4	x 365			0.26 Statewide Rate
	Vehicles/Day	# of Years	Days/Year			0.46 County Rate
Pitkin Street @ East Ave	# Accidents	Per Million Entering Vehicles				
	8	x 1,000,000	=	$\frac{8000000}{18012750}$	=	0.44 ACC/MEV
	16,450	x 3	x 365			0.34 Statewide Rate
	Vehicles/Day	# of Years	Days/Year			0.22 County Rate
Broad Street	# Accidents	Per Million Entering Vehicles				
	4	x 1,000,000	=	$\frac{4000000}{6077250}$	=	0.66 ACC/MEV
	5,550	x 3	x 365			0.34 Statewide Rate
	Vehicles/Day	# of Years	Days/Year			0.22 County Rate
Union Street @ University Ave	# Accidents	Per Million Entering Vehicles				
	14	x 1,000,000	=	$\frac{14000000}{21462000}$	=	0.65 ACC/MEV
	19,600	x 3	x 365			0.34 Statewide Rate
	Vehicles/Day	# of Years	Days/Year			0.22 County Rate
East Ave	# Accidents	Per Million Entering Vehicles				
	17	x 1,000,000	=	$\frac{17000000}{15001500}$	=	1.13 ACC/MEV
	13,700	x 3	x 365			0.34 Statewide Rate
	Vehicles/Day	# of Years	Days/Year			0.22 County Rate
Broad St	# Accidents	Per Million Entering Vehicles				
	3	x 1,000,000	=	$\frac{3000000}{4215750}$	=	0.71 ACC/MEV
	3,850	x 3	x 365			0.19 Statewide Rate
	Vehicles/Day	# of Years	Days/Year			0.22 County Rate
Monroe Avenue @ Inner Loop/ Pitkin St.	# Accidents	Per Million Entering Vehicles				
	7	x 1,000,000	=	$\frac{7000000}{26445710}$	=	0.26 ACC/MEV
	21,310	x 3.4	x 365			0.34 Statewide Rate
	Vehicles/Day	# of Years	Days/Year			0.22 County Rate
Howell St.	# Accidents	Per Million Entering Vehicles				
	5	x 1,000,000	=	$\frac{5000000}{14581750}$	=	0.34 ACC/MEV
	11,750	x 3.4	x 365			0.34 Statewide Rate
	Vehicles/Day	# of Years	Days/Year			0.22 County Rate
South Union St.	# Accidents	Per Million Entering Vehicles				
	20	x 1,000,000	=	$\frac{20000000}{17870400}$	=	1.12 ACC/MEV
	14,400	x 3.4	x 365			0.34 Statewide Rate
	Vehicles/Day	# of Years	Days/Year			0.46 County Rate

ACCIDENT RATE CALCULATIONS

Project Name: **Inner Loop**
 Date: 12/10/2008

Main Corridor Street: Pitkin Street Classification: Local Street Location Type: Urban

Intersection Rate

(excludes midblock accidents)

East Ave	# Accidents	Per Million Entering Vehicles							
	8	x	1,000,000	=	8000000	=	0.444	ACC/MEV	
	16,450	x	3	x	365	=	18012750		
	Vehicles/Day		# of Years		Days/Year			0.34	Statewide Rate
								0.22	County Rate
Broad Street	# Accidents	Per Million Entering Vehicles							
	4	x	1,000,000	=	4000000	=	0.658	ACC/MEV	
	5,550	x	3	x	365	=	6077250		
	Vehicles/Day		# of Years		Days/Year			0.34	Statewide Rate
								0.22	County Rate
	# Accidents	Per Million Entering Vehicles							
	0	x	1,000,000	=	0	=	#DIV/0!	ACC/MEV	
	0	x	3	x	365	=	0		
	Vehicles/Day		# of Years		Days/Year			0.39	Statewide Rate
								0.00	County Rate

Total Link Rate

(All midblock & intersection accidents)

Main to Monroe	# Accidents	Per Million Entering Vehicles							
	14	x	1,000,000	=	14000000	=	#DIV/0!	ACC/MVM	
	0	x	0	x	3	x	365		
	Length (miles)		Vehicles/Day		# of Years		Days/Year	2.70	Statewide Rate
								0.00	County Rate
	# Accidents	Per Million Entering Vehicles							
	0	x	1,000,000	=	0	=	#DIV/0!	ACC/MVM	
	0.0	x	0	x	3	x	365		
	Length (miles)		Vehicles/Day		# of Years		Days/Year	0.00	Statewide Rate
								0.00	County Rate

ACCIDENT RATE CALCULATIONS

Project Name: **Inner Loop**
 Date: 12/10/2008

Main Corridor Street: Union Street Classification: Minor Arterial Location Type: Urban

Intersection Rate

(excludes midblock accidents)

University Ave	# Accidents	x	Per Million Entering Vehicles	=		=			
	14		1,000,000		14000000		0.652	ACC/MEV	
	19,600	x	3	x	365	=	21462000		
	Vehicles/Day		# of Years		Days/Year				
							0.34	Statewide Rate	
							0.22	County Rate	

East Ave	# Accidents	x	Per Million Entering Vehicles	=		=			
	17		1,000,000		17000000		1.133	ACC/MEV	
	13,700	x	3	x	365	=	15001500		
	Vehicles/Day		# of Years		Days/Year				
							0.34	Statewide Rate	
							0.22	County Rate	

Broad St	# Accidents	x	Per Million Entering Vehicles	=		=			
	3		1,000,000		3000000		0.712	ACC/MEV	
	3,850	x	3	x	365	=	4215750		
	Vehicles/Day		# of Years		Days/Year				
							0.19	Statewide Rate	
							0.22	County Rate	

Midblock Rate

(All midblock accidents excluding intersection accidents)

	# Accidents	x	Per Million Entering Vehicles	=		=			
	0		1,000,000		0		#DIV/0!	ACC/MVM	
	0	x	0	x	3	x	365		
	Length (miles)		Vehicles/Day		# of Years		Days/Year		
							0.00	Statewide Rate	
							0.00	County Rate	

Total Link Rate

(All midblock & intersection accidents)

Main to Monroe	# Accidents	x	Per Million Entering Vehicles	=		=			
Washington Street	51		1,000,000		51000000		#DIV/0!	ACC/MVM	
	0	x	0	x	3	x	365		
	Length (miles)		Vehicles/Day		# of Years		Days/Year		
							2.70	Statewide Rate	
							0.00	County Rate	

ACCIDENT RATE CALCULATIONS

Project Name: **Inner Loop**
 Date: 12/10/2008

Main Corridor Street: Inner Loop Classification: Principal Arterial Location Type: Urban

Intersection Rate

(excludes midblock accidents)

# Accidents		Per Million Entering Vehicles								
0	x	1,000,000		0	=	0	=	#DIV/0!	ACC/MEV	
0	x	0	x	365		0			0.10	Statewide Rate
Vehicles/Day		# of Years		Days/Year					0.00	County Rate

# Accidents		Per Million Entering Vehicles								
0	x	1,000,000		0	=	0	=	#DIV/0!	ACC/MEV	
0	x	0	x	365		0			0.22	Statewide Rate
Vehicles/Day		# of Years		Days/Year					0.00	County Rate

# Accidents		Per Million Entering Vehicles								
0	x	1,000,000		0	=	0	=	#DIV/0!	ACC/MEV	
0	x	0	x	365		0			0.39	Statewide Rate
Vehicles/Day		# of Years		Days/Year					0.00	County Rate

Midblock Rate

(All midblock accidents excluding intersection accidents)

# Accidents		Per Million Entering Vehicles											
0	x	1,000,000		0	x	3	x	365	=	0	=	#DIV/0!	ACC/MVM
0	x	0	x	3	x	365				0		0.00	Statewide Rate
Length (miles)		Vehicles/Day		# of Years		Days/Year						0.00	County Rate

Total Link Rate

(All midblock & intersection accidents)

Rt. 490-E. Main St.		# Accidents		Per Million Entering Vehicles							
	30	x	1,000,000		=	30000000	=	2.479	ACC/MVM		
	1	x	10,200	x	3.25	x	365		12099750	2.72	Statewide Rate
	Length (miles)		Vehicles/Day		# of Years		Days/Year			0.00	County Rate

ACCIDENT SYMBOLS LEGEND

○	V	VEHICLE	●	FI	FATAL INJURY	□	FO	FIXED OBJECT	↘	RT	↙	LT	↘↙	LT5	↘↙	RANG	↘↙	SS	↘↙	HOSS
→	MV	MOVING VEHICLE	←P-	P	PEDESTRIAN	♣	SP	SIGN POST	↘↙	RT1	↙↘	LT1	↘↙↘↙	LT6	↘↙↘↙	VFO	↘↙↘↙	SKID	↘↙↘↙	RE
↔	BV	BACKING VEHICLE	←B-	B	BICYCLE	⊕	TR	TREE	↘↙↘↙	RT2	↙↘↙↘	LT2	↘↙↘↙↘↙	00C	↘↙↘↙↘↙	VSP	↘↙↘↙↘↙	VGR	↘↙↘↙↘↙	DSS
▭	PV	PARKED VEHICLE	←M-	M	MOTORCYCLE	⊖	UP	UTILITY POLE	↘↙↘↙↘↙	RT3	↙↘↙↘↙↘	LT3	↘↙↘↙↘↙↘↙	OT	↘↙↘↙↘↙↘↙	VTR	↘↙↘↙↘↙↘↙	VUP	↘↙↘↙↘↙↘↙	VCB
•	SV	STOPPED VEHICLE	←D-	D	DEEP	— —	GR	GUIDE RAIL	↘↙↘↙↘↙↘↙↘↙	RT4	↙↘↙↘↙↘↙↘	LT4	↘↙↘↙↘↙↘↙↘↙	HO	↘↙↘↙↘↙↘↙↘↙					
◊	NFI	NON-FATAL INJURY	←BB-	BB	BLACK BEAR	— —	CB	CONCRETE BARRIER												

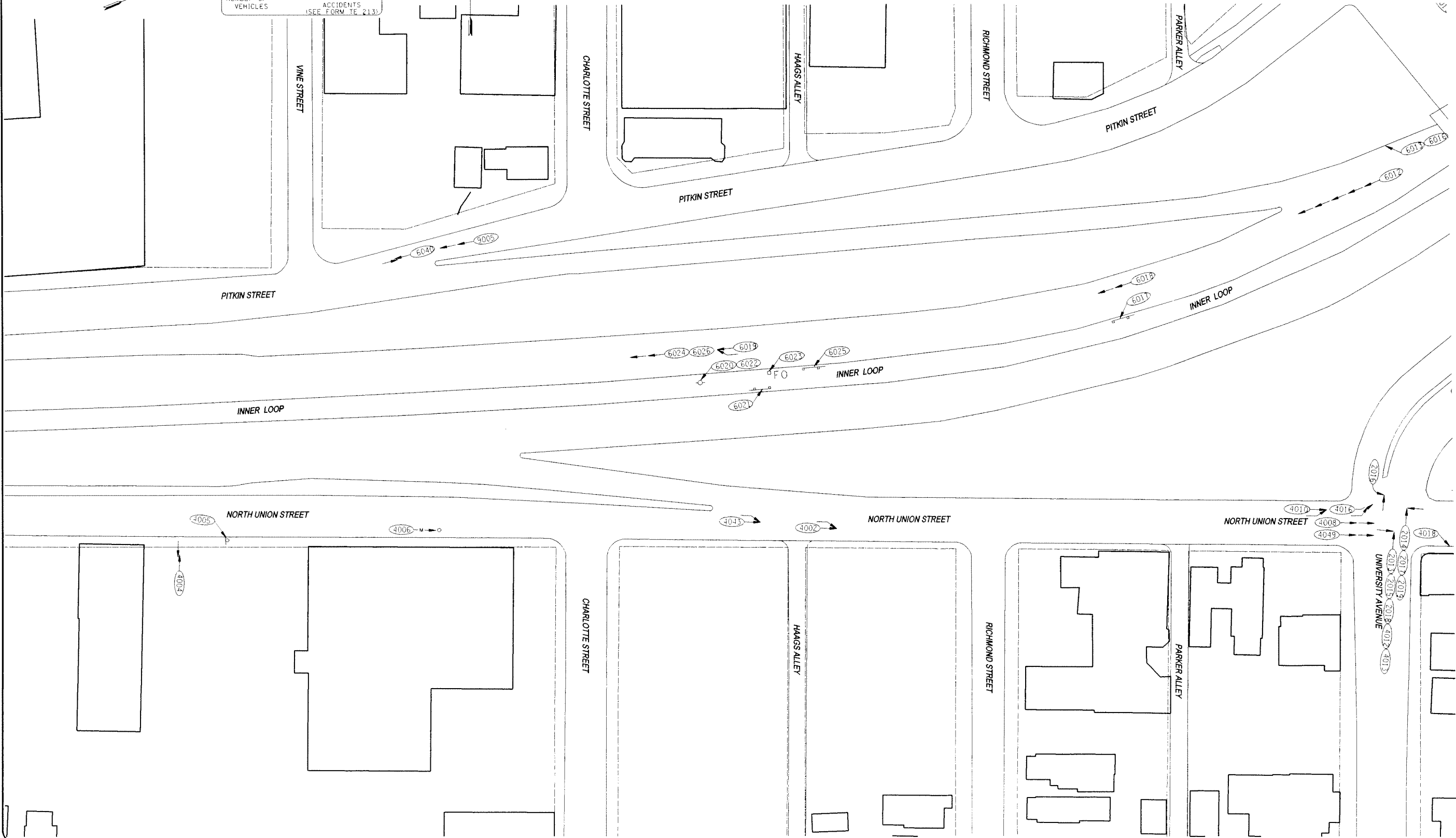
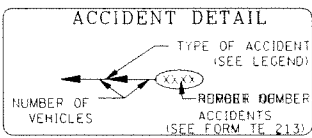

Project: 192500170 Transportation/Planning/Engineering/Accident Symbols Sheet 2_accident
 Discipline: Highway Design
 Project No.: 192500170
 Date: 10/31/2008
 Time: 3:28:08 PM
 User: JHOFMANN

PROJECT ENGINEER/ARCHITECT K. STETTNER	FIRST ISSUE DATE 10/31/2008
PROJECT MANAGER J. HOFMANN	SCALE
DRAWN BY T. SCHULZE	

1"=40'

Stantec
 STANTEC CONSULTING SERVICES, INC.
 2250 Brighton Harbortra, T.L. RD
 Rochester, NY 14623-2706
 Tel: (585) 475-1440
 Fax: (585) 427-8124
 www.stantec.com

PROJECT
**INNER LOOP IMPROVEMENT PROJECT
 SCIO STREET TO CLINTON AVENUE
 CITY OF ROCHESTER, NEW YORK**
 TITLE OF DRAWING
ACCIDENT COLLISION DIAGRAM PLAN

PROJECT NO.
192500170
 DRAWING NO.
2
 SHEET 2 OF 9

10/20/2009
 Project: 192500170
 Title: Inner Loop Improvement Project
 Drawing: 3
 Date: 11/2/2009
 Time: 3:29:21 PM
 Designer: J. Hoffmann
 Checker: J. Hoffmann
 Project Manager: J. Hoffmann
 Mod: FREEMANLSP2

ACCIDENT SYMBOLS LEGEND

○	V VEHICLE	●	FI FATAL INJURY	□	FO FIXED OBJECT	↶	RT	↷	LT	↶↷	LT5	↶↷↷	RANG	↶↷↷↷	SS	↶↷↷↷↷	HOSS	
↶	MV MOVING VEHICLE	↶-	P PEDESTRIAN	⊕	SP SIGN POST	↶↷	RT1	↶↷	LT1	↶↷↷	LT6	↶↷↷↷	VFO	↶↷↷↷↷	SKID	↶↷↷↷↷↷	RE	
↶↷	BV BACKING VEHICLE	↶-B-	B BICYCLE	⊖	TR TREE	↶↷↷	RT2	↶↷↷	LT2	↶↷↷↷	00C	↶↷↷↷↷	VSP	↶↷↷↷↷↷	VGP	↶↷↷↷↷↷↷	DSS	
↶↷↷	PV PARKED VEHICLE	↶-M-	M MOTORCYCLE	⊙	UP UTILITY POLE	↶↷↷↷	RT3	↶↷↷↷	LT3	↶↷↷↷↷	OT	↶↷↷↷↷↷	VTR	↶↷↷↷↷↷↷	VUP	↶↷↷↷↷↷↷↷	VCB	
●	SV STOPPED VEHICLE	↶-D-	D DEER	⊞	GR GUIDE RAIL	↶↷↷↷↷	RT4	↶↷↷↷↷	LT4	↶↷↷↷↷↷	HO	↶↷↷↷↷↷↷						
○	NFI NON-FATAL INJURY	↶-BB-	BB BLACK BEAP	⊞	CB CONCRETE BARRIER	↶↷↷↷↷↷												

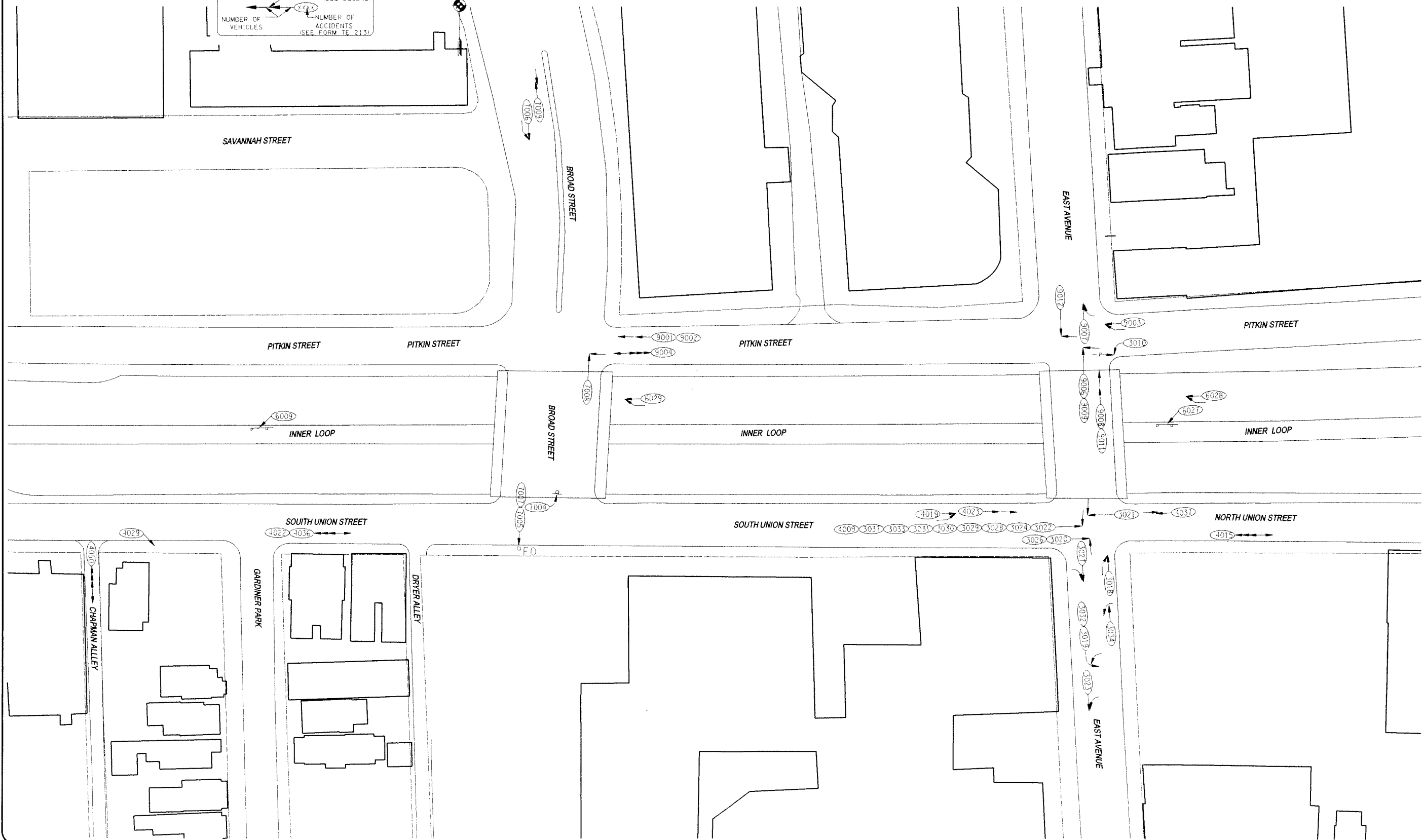
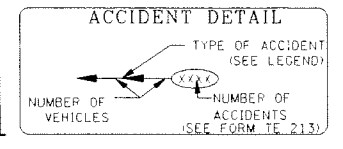

6		BY
5		DATE
4		REVISIONS
3		
2		
1		
0		

PROJECT ENGINEER/ARCHITECT
K. STETTNER

PROJECT MANAGER
J. HOFFMANN

DRAWN BY

SCALE

PRST ISSUE DATE
7/19/2008

STANTEC CONSULTING SERVICES, INC.
 2250 Brighton Henckels TL RD
 Rochester, NY 14623-2706
 Tel: (585) 475-1440
 Fax: (585) 427-9124
 www.stantec.com

PROJECT
INNER LOOP IMPROVEMENT PROJECT
SCIO STREET TO CLINTON AVENUE
CITY OF ROCHESTER, NEW YORK

TITLE OF DRAWING
ACCIDENT COLLISION DIAGRAM PLAN

PROJECT NO.
192500170

DRAWING NO.
3

SHEET 3 OF 9

Discipline: Highway Design
 Project: NY
 Mode: FREEMAN/SP2
 Date: 7/19/2008
 Time: 3:28:30 PM
 Project: 192500170
 Drawing: Accident Symbols Legend
 Date: 7/19/2008
 Time: 3:28:30 PM

ACCIDENT SYMBOLS LEGEND

○	V	VEHICLE	●	FI	FATAL INJURY	□	FO	FIXED OBJECT	↖	RT	↗	LT	↖	LT5	↖	RANG	↖	SS	↖	HOSS
→	MV	MOVING VEHICLE	←-P-	P	PEDESTRIAN	-P-	SP	SIGN POST	↖	RT1	↗	LT1	↖	LT6	↖	VFO	↖	SKID	↖	RE
↖	BV	BACKING VEHICLE	←-B-	B	BICYCLE	⊙	TR	TREE	↖	RT2	↗	LT2	↖	00C	↖	VSP	↖	VGR	↖	ØSS
↖	PV	PARKED VEHICLE	←-M-	M	MOTORCYCLE	⊙	UP	UTILITY POLE	↖	RT3	↗	LT3	↖	OT	↖	VTR	↖	VUP	↖	VCB
●	SV	STOPPED VEHICLE	←-D-	D	DEER	— —	GR	GUIDE RAIL	↖	PT4	↗	LT4	↖	HO						
○	NFI	NON-FATAL INJURY	←-BB-	BB	BLACK BEAR	— —	CB	CONCRETE BARRIER												

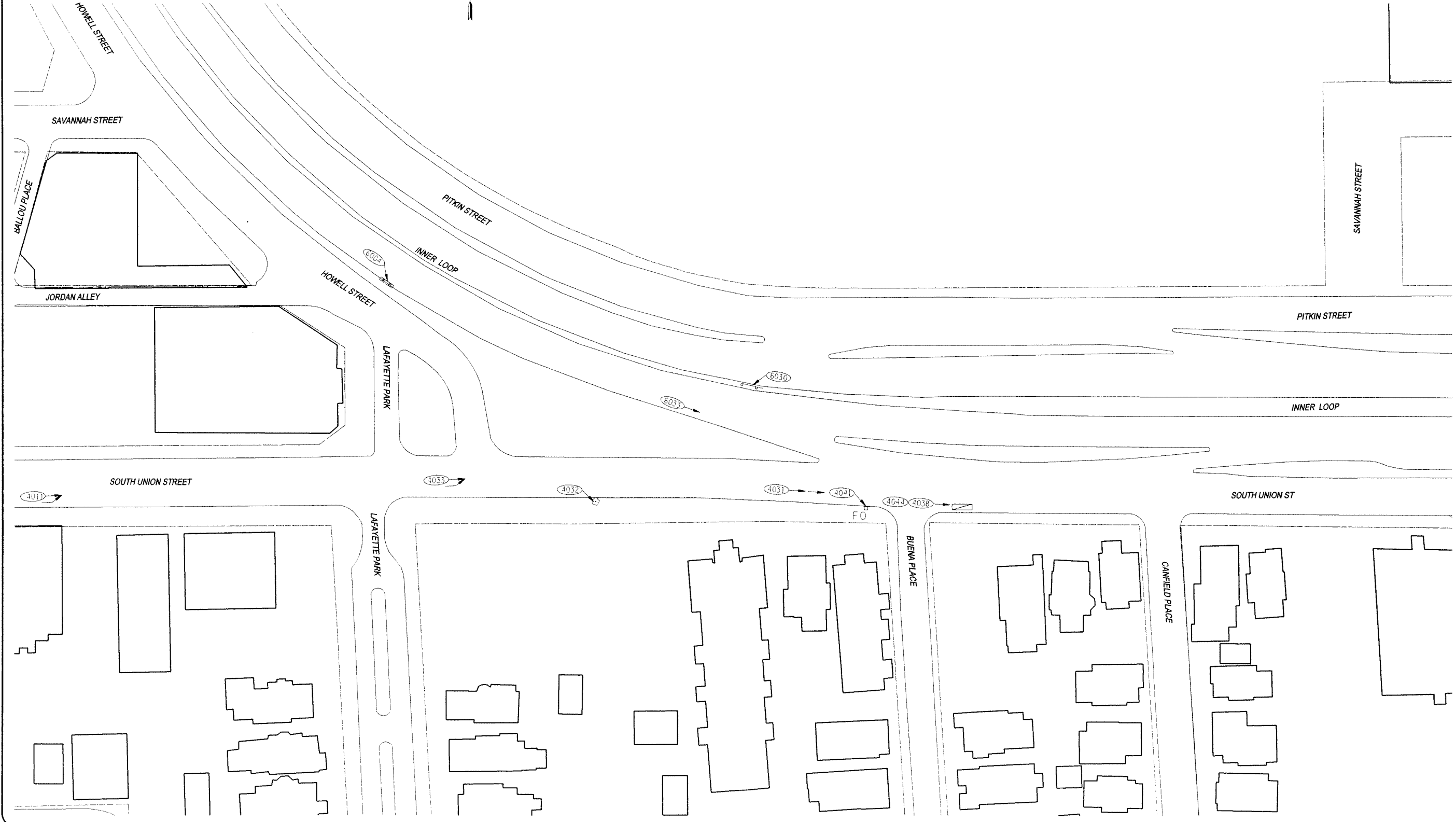
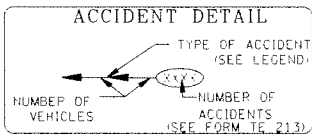

PROJECT ENGINEER/ARCHITECT K. STETTNER	PROJECT MANAGER J. HOFMANN	DRAWN BY	SCALE	FIRST ISSUE DATE 7/19/2008	DATE	BY
STANTEC CONSULTING SERVICES, INC. 2250 Brighton Henrietta Tl. Rd Rochester, N.Y. 14623-2706 Tel: (585) 475-1440 Fax: (585) 427-8124 www.stantec.com						
PROJECT INNER LOOP IMPROVEMENT PROJECT SCIO STREET TO CLINTON AVENUE CITY OF ROCHESTER, NEW YORK		PROJECT NO. 192500170		DRAWING NO. 4		
TITLE OF DRAWING ACCIDENT COLLISION DIAGRAM PLAN		SHEET 4 OF 9				

Project: 192500170
 Design: 1/12/2008
 Project: NY - Highway Design - Eng
 Note: FREEMAN/SP2
 Time: 3:26:43 PM

ACCIDENT SYMBOLS LEGEND

	V VEHICLE		FI FATAL INJURY		FO FIXED OBJECT		RT		LT		LT5		RANG		SS		HOSS
	MV MOVING VEHICLE		P PEDESTRIAN		SP SIGN POST		RT1		LT1		LT6		VFO		SKID		RE
	BV BACKING VEHICLE		B BICYCLE		TR TPEE		RT2		LT2		OOC		VSP		VGR		DSS
	PV PARKED VEHICLE		M MOTORCYCLE		UP UTILITY POLE		RT3		LT3		OT		VTR		VUP		VCB
	SV STOPPED VEHICLE		D DEEP		GR GUIDE RAIL		RT4		LT4		HO						
	NFI NON-FATAL INJURY		BB BLACK BEAR		CB CONCRETE BARRIER												

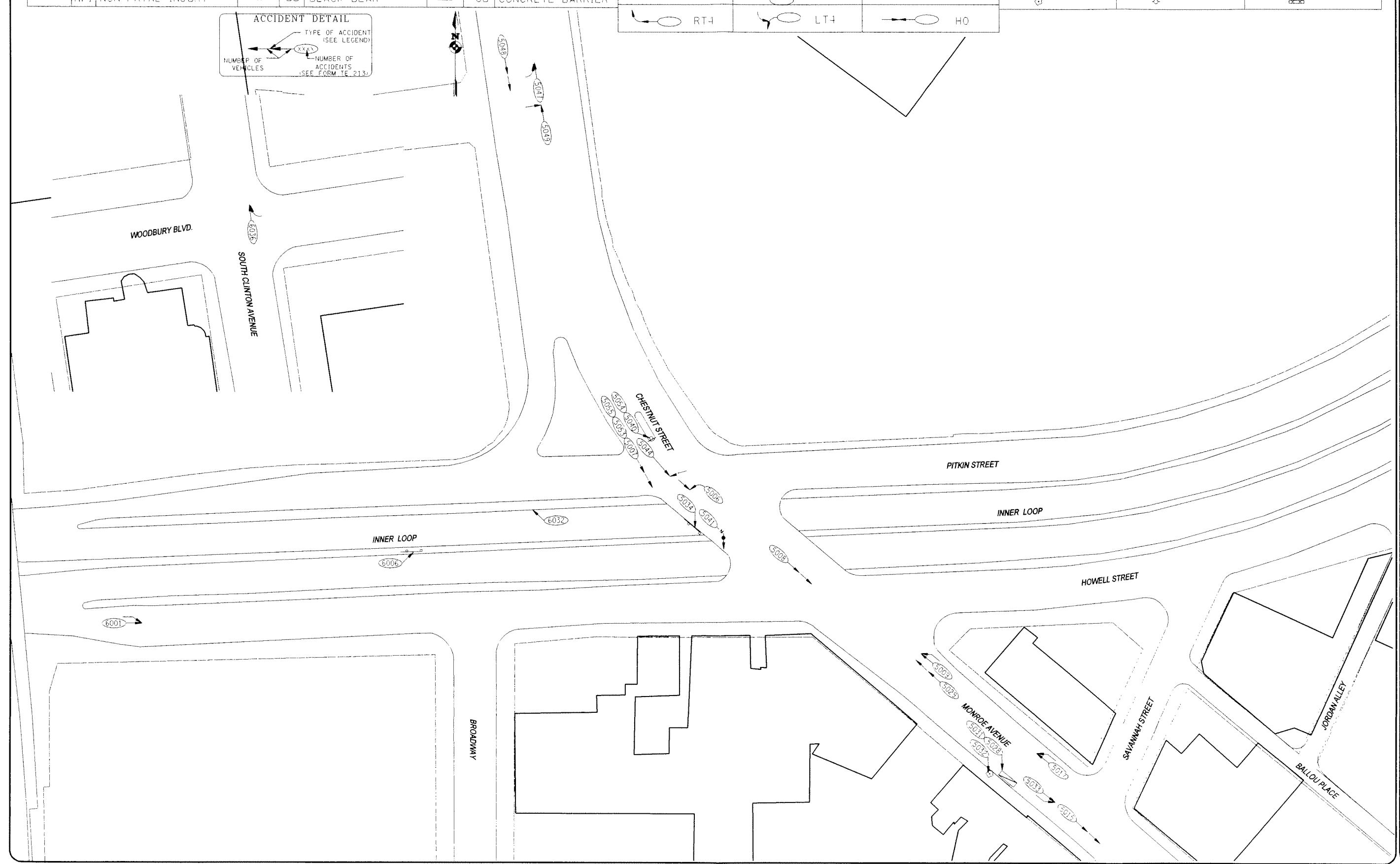
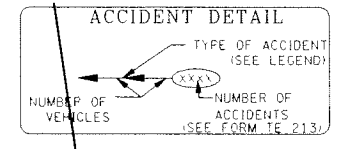

PROJECT	INNER LOOP IMPROVEMENT PROJECT SCIO STREET TO CLINTON AVENUE CITY OF ROCHESTER, NEW YORK
PROJECT NO.	192500170
DRAWING NO.	5
SHEET	5 OF 9
PROJECT ENGINEER/ARCHITECT	K. STETTNER
PROJECT MANAGER	J. HOPMANN
DRAWN BY	
SCALE	
FIRST ISSUE DATE	7/19/2008
REVISIONS	
DATE	
BY	

STANTEC CONSULTING SERVICES, INC.
 2250 Brighton Highlands Tr. RD
 Rochester, NY 14623-2706
 Tel: (688) 475-1440
 Fax: (688) 427-9124
 www.stantec.com

Stantec

Project: 192500170
 Design: J. HOFMANN
 Date: 7/18/2005
 Time: 3:26:54 PM

ACCIDENT SYMBOLS LEGEND

	V VEHICLE		FI FATAL INJURY		FO FIXED OBJECT		RT		LT		LT5		RANG		SS		HOSS
	MV MOVING VEHICLE		P PEDESTRIAN		SP SIGN POST		RT1		LT1		LT6		VFO		SKID		RE
	BV BACKING VEHICLE		B BICYCLE		TR TREE		RT2		LT2		OOC		VSP		VGR		DSS
	PV PARKED VEHICLE		M MOTORCYCLE		UP UTILITY POLE		RT3		LT3		OT		VTR		VUP		VCB
	SV STOPPED VEHICLE		D DEER		GR GUIDE RAIL		RT4		LT4		HO						
	NFI NON-FATAL INJURY		BB BLACK BEAR		CB CONCRETE BARRIER												

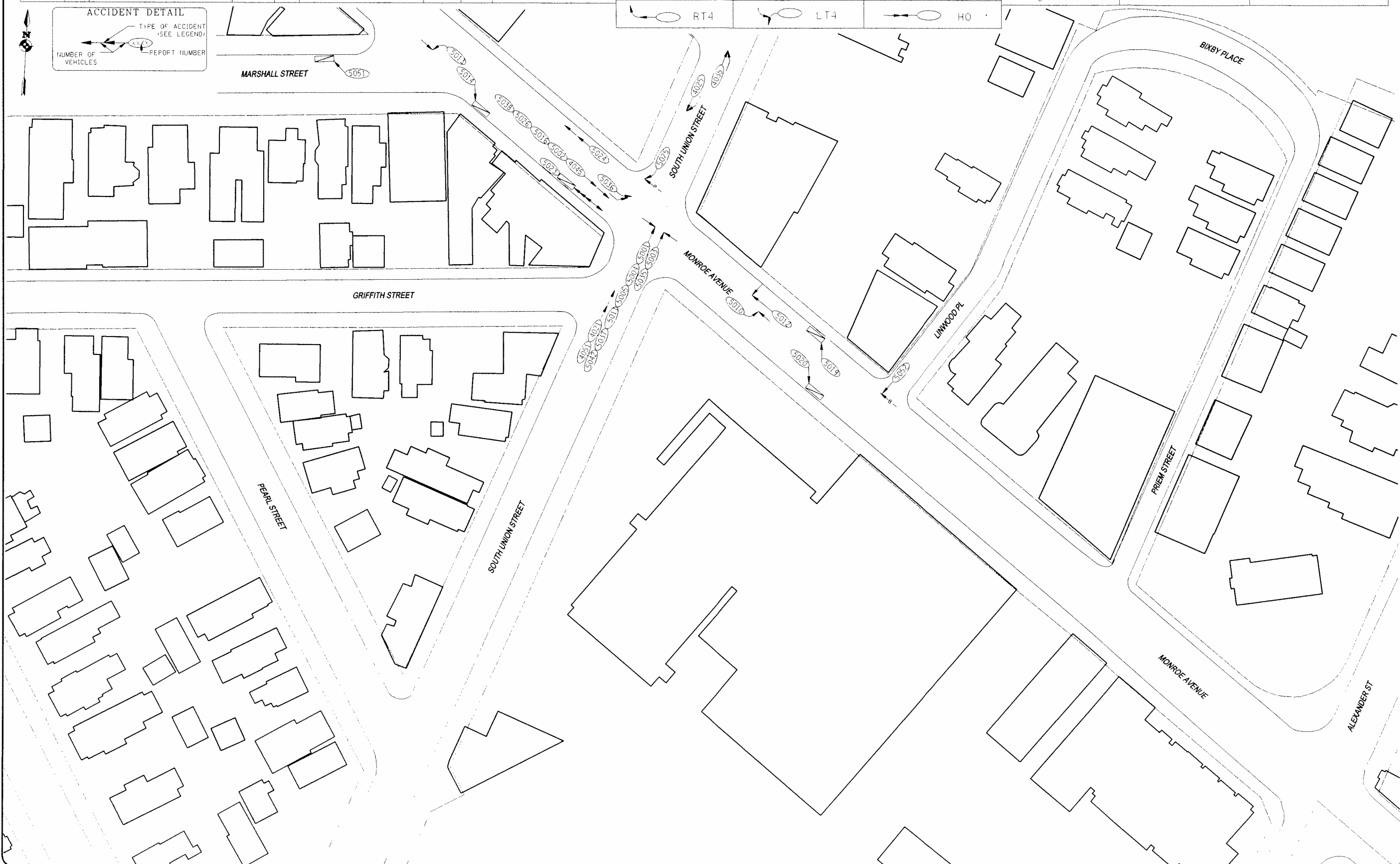
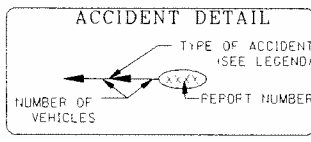

PROJECT ENGINEER/ARCHITECT	K. STETTNER	FIRST ISSUE DATE	7/18/2005
PROJECT MANAGER	J. HOFMANN	DRAWN BY	
PROJECT NO.	192500170	SCALE	
DRAWING NO.	6		
STANTEC CONSULTING SERVICES, INC. 2250 Brighton Henrietta TL RD Rochester, N.Y. 14823-2706 Tel: (585) 475-1440 Fax: (585) 427-9124 www.stantec.com			
PROJECT INNER LOOP IMPROVEMENT PROJECT SCIO STREET TO CLINTON AVENUE CITY OF ROCHESTER, NEW YORK		TITLE OF DRAWING ACCIDENT COLLISION DIAGRAM PLAN	
PROJECT NO. 192500170		DATE 7/18/2005	
DRAWING NO. 6		REVISIONS 0	
SHEET 6 OF 9		DATE 7/18/2005	

Worksheet: 11/12/2009
 Description: Accident Symbols Legend
 Project: NY Highway Design - Eng
 Made: FREEMAN-SP2
 Project Parameters
 Picked By: Freeman
 Design File: U:\19250017\Transportation\Drawings\Accident Symbols\7_Accident
 Plotted: 11/12/2009
 Time: 3:30:08 PM

ACCIDENT SYMBOLS LEGEND

	V VEHICLE		FI FATAL INJURY		FO FIXED OBJECT		RT		LT		LT5		RANG		SS		HOSS
	MV MOVING VEHICLE		P PEDESTRIAN		SP SIGN POST		RT1		LT1		LT6		VFO		SKID		RE
	BV BACKING VEHICLE		B BICYCLE		TR TREE		RT2		LT2		OOC		VSP		VGR		DSS
	PV PARKED VEHICLE		M MOTORCYCLE		UP UTILITY POLE		RT3		LT3		OT		VTR		VUP		VCB
	SV STOPPED VEHICLE		D DEER		GR GUIDE RAIL		RT4		LT4		HO						
	NFI NON-FATAL INJURY		BB BLACK BEAR		CB CONCRETE BARRIER												

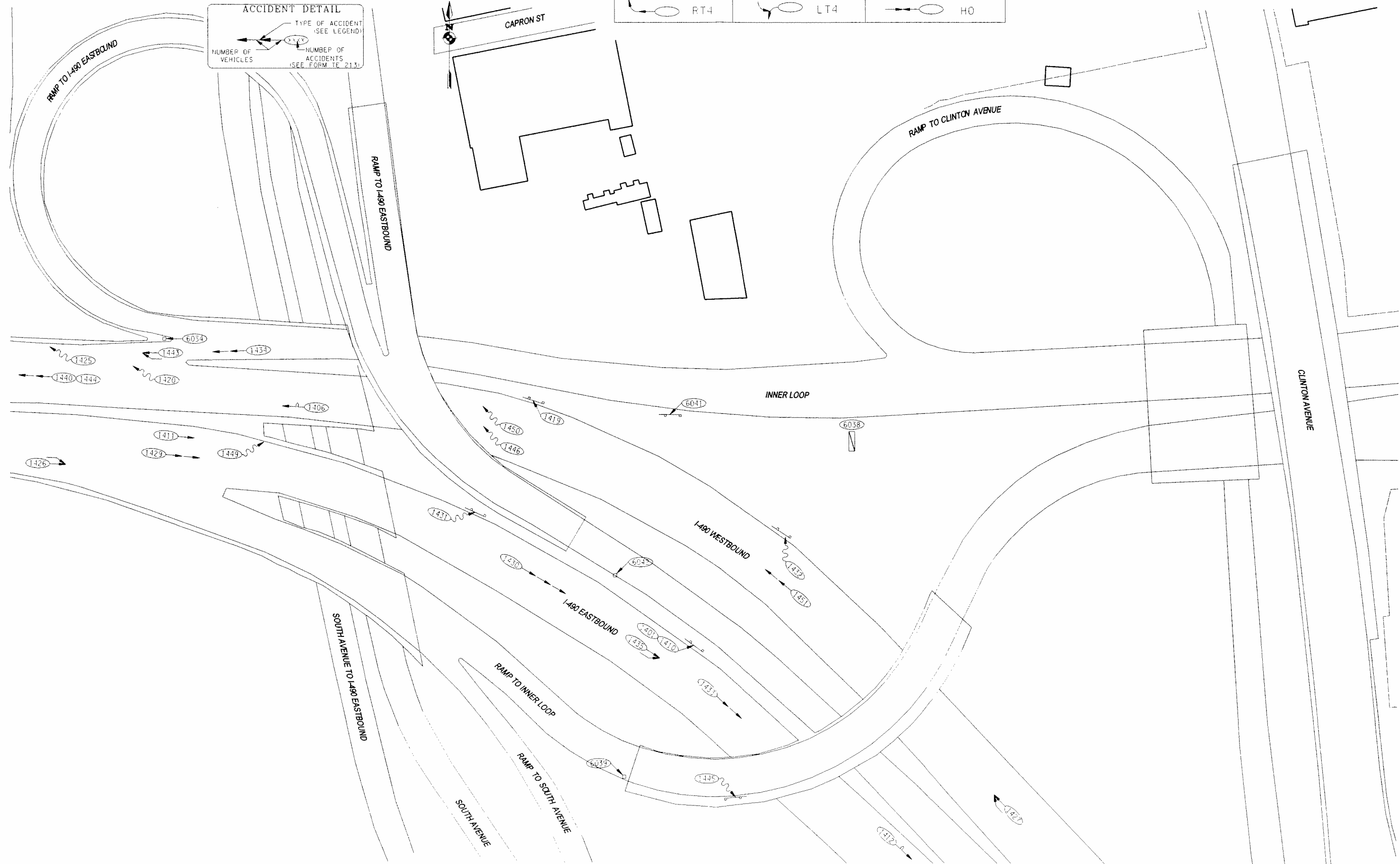
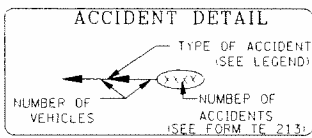

PROJECT NO	192500170
DRAWING NO	7
SHEET 7 OF 9	

PROJECT	INNER LOOP IMPROVEMENT PROJECT SCIO STREET TO CLINTON AVENUE CITY OF ROCHESTER, NEW YORK
TITLE OF DRAWING	ACCIDENT COLLISION DIAGRAM PLAN

PROJECT ENGINEER/ARCHITECT	K. STETTNER
PROJECT MANAGER	J. HOFMANN
DRAWN BY	
SCALE	
PLOT ISSUE DATE	7/19/2008

STANTEC CONSULTING SERVICES, INC.	2250 Brighton Highlands Tr. Rd Rochester, NY 14623-2706 Tel: (585) 475-1440 Fax: (585) 427-9124 www.stantec.com
-----------------------------------	---

REVISIONS	DATE	BY

Project Parameters
 Project: I-190
 Discipline: Highway
 Project No.: 190-01
 Design: J. Hoffmann
 Date: 11/22/2009
 Time: 3:30:17 PM

ACCIDENT SYMBOLS LEGEND

	V	VEHICLE		FI	FATAL INJURY		FO	FIXED OBJECT		RT		LT		LT5		RANG		SS		HOSS
	MV	MOVING VEHICLE		P	PEDESTRIAN		SP	SIGN POST		RT1		LT1		LT6		VFO		SKID		RE
	BV	BACKING VEHICLE		B	BICYCLE		TR	TREE		RT2		LT2		00C		VSP		VGR		DSS
	PV	PARKED VEHICLE		M	MOTORCYCLE		UP	UTILITY POLE		RT3		LT3		OT		VTR		VUP		VCB
	SV	STOPPED VEHICLE		D	DEER		GR	GUIDE RAIL		RT4		LT4		HO						
	NFI	NON-FATAL INJURY		BB	BLACK BEAR		CB	CONCRETE BARRIER												

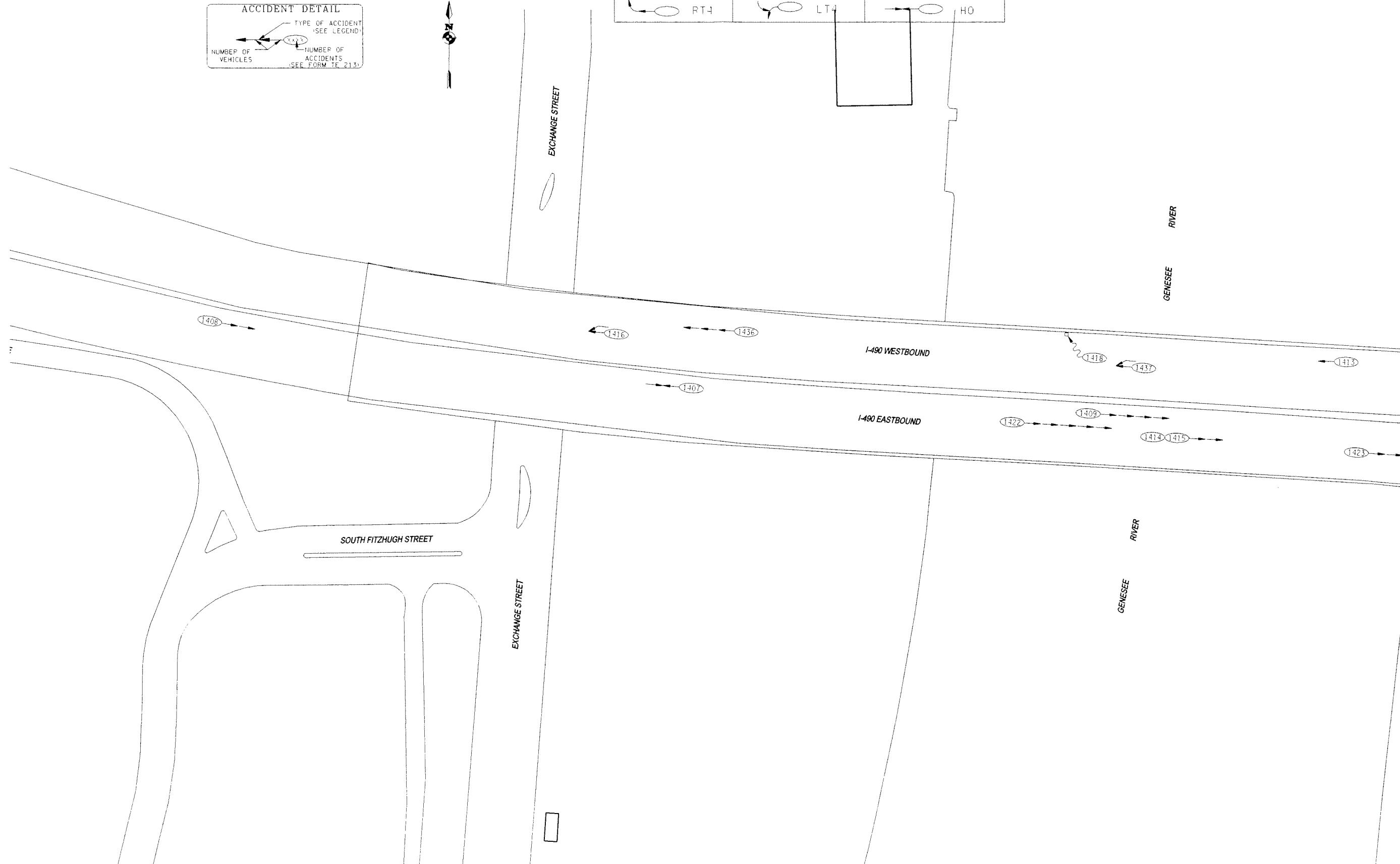
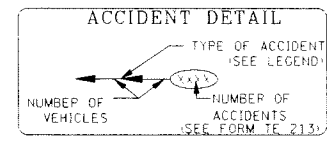

PROJECT	INNER LOOP IMPROVEMENT PROJECT SCIO STREET TO CLINTON AVENUE CITY OF ROCHESTER, NEW YORK
PROJECT NO.	192500170
DRAWING NO.	8
SHEET	8 OF 9
TITLE OF DRAWING	ACCIDENT COLLISION DIAGRAM PLAN
PROJECT ENGINEER/ARCHITECT	K. STETTNER
PROJECT MANAGER	J. HOFMANN
DRAWN BY	
SCALE	
FIRST ISSUE DATE	7/18/2008
STANTEC CONSULTING SERVICES, INC.	2250 Brighton Henrietta Tl. Rd Rochester, N.Y. 14623-2706 Tel: (585) 475-1440 Fax: (585) 427-8124 www.stantec.com
STANTEC	
REVISIONS	
DATE	
BY	

Project: I-190
 Design: J. Hoffmann
 Date: 11/12/2009
 Time: 3:30 PM
 Project Path: I:\190\190170\Transportation\Drawings\Accident_Sheet_9.dwg
 Note: FREEMANUSP2

ACCIDENT SYMBOLS LEGEND

	V	VEHICLE		F1	FATAL INJURY		FO	FIXED OBJECT		RT		LT		LT5		RANG		SS		HOSS
	MV	MOVING VEHICLE		P	PEDESTRIAN		SP	SIGN POST		RT1		LT1		LT6		VFO		SKID		RE
	BV	BACKING VEHICLE		B	BICYCLE		TR	TREE		RT2		LT2		00C		VSP		VGR		DSS
	PV	PARKED VEHICLE		M	MOTORCYCLE		UP	UTILITY POLE		RT3		LT3		0T		VTR		VUP		VCB
	SV	STOPPED VEHICLE		D	DEER		GR	GUIDE RAIL		PT4		LT4		H0						
	NFI	NON-FATAL INJURY		BB	BLACK BEAR		CB	CONCRETE BARRIER												

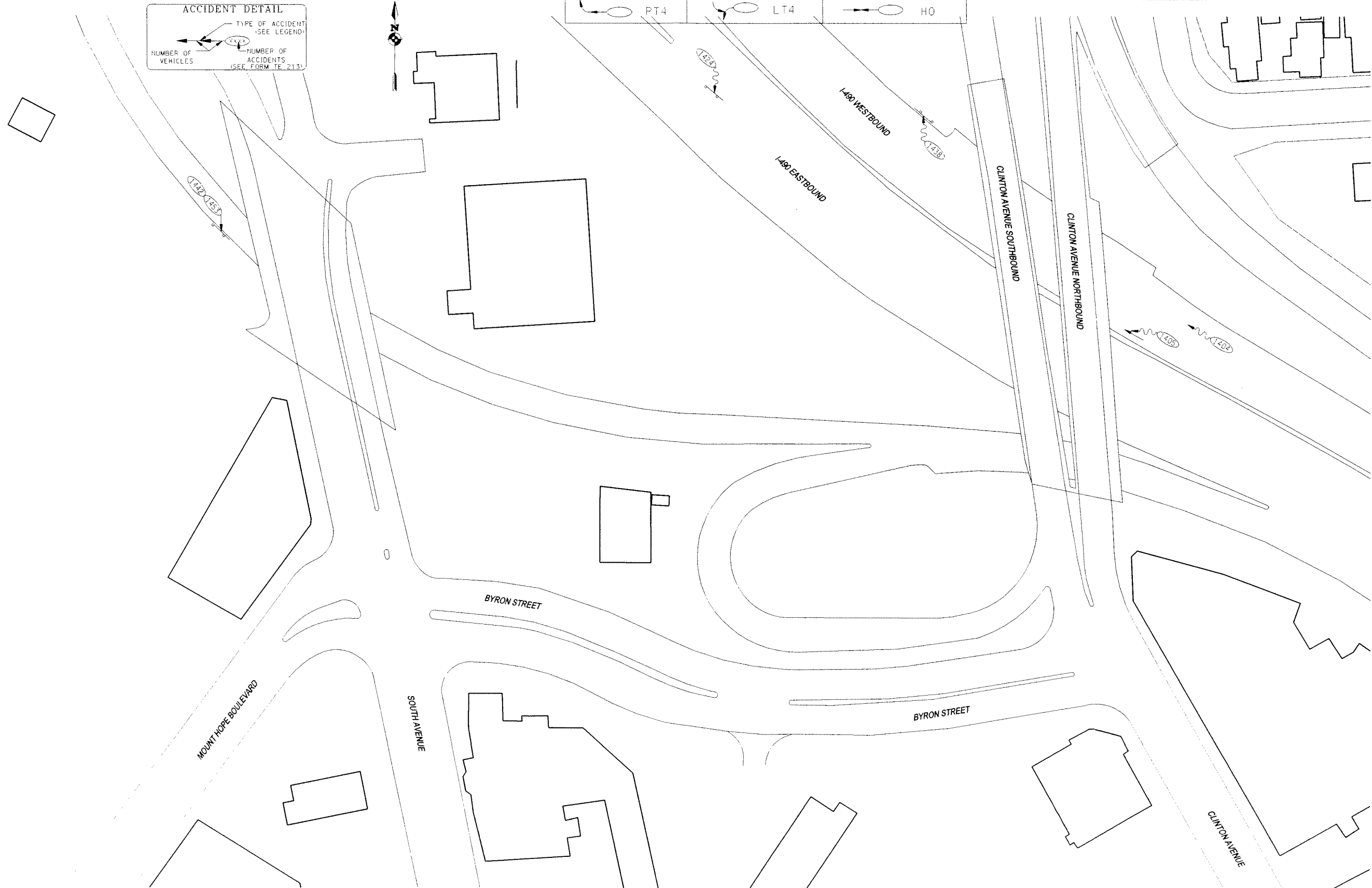
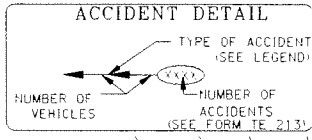

PROJECT ENGINEER/ARCHITECT K. STETTNER	PROJECT MANAGER J. HOFMANN	DRAWN BY	SCALE	FIRST ISSUE DATE 7/16/2008
STANTEC CONSULTING SERVICES, INC. 2250 Brighton Henrietta Tl. Rd Tonawanda, NY 14223-2706 Tel: (688) 475-1440 Fax: (688) 427-9124 www.stantec.com				
PROJECT: INNER LOOP IMPROVEMENT PROJECT SCIO STREET TO CLINTON AVENUE CITY OF ROCHESTER, NEW YORK				
TITLE OF DRAWING: ACCIDENT COLLISION DIAGRAM PLAN				
PROJECT NO. 192500170				
DRAWING NO. 9				
SHEET 9 OF 9				
REVISIONS	DATE	BY		